

BALL VALVES

Model BV835 Ball Valve

The Model BV835 Ball Valve is capable of a working pressure of 1,000 psi. Available in sizes 2" (DN 50) to 6" (DN 150). Flow may be from either direction and the valves may be positioned in any orientation. The Model BV835 is furnished with grooved ends and features a handle that accepts a padlock device for locking in either the open or closed position.



Max. Working Pressure
 1,000 psi (68,9 bars) 2 – 3 inches
 800 psi (55,1 bars) 4 inches
 600 psi (41,4 bars) 6 inches

MATERIAL SPECIFICATIONS

Body

- Ductile Iron Conforming to ASTM A-536, Grade 65-45-12

Body Coating

- Black Enamel

Ball

- Carbon Steel, Chrome Plated 304SS Available

Ball Seal

- Teflon®*

Upper Stem

- Carbon Steel Nickel Plated

Operator

- Lever With Locking Device

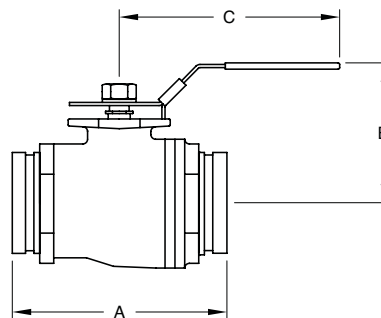

* Teflon® is an E.I. Dupont trademark

Nominal Pipe Size		Nominal Dimensions Inches mm				Approx. Weight lbs kg
ANSI Inches DN	O.D. Inches mm	A Inches mm	B Inches mm	C Inches mm	D Inches mm	
2 DN50	2.375 60,3	5.50 140,0	3.75 95,0	7.0 178,0	1.50 38,1	6.4 2,9
2½ DN65	2.875 73,0	6.25 159,0	5.20 132,0	10.43 265,0	2.00 51,0	10.6 4,8
3 DN80	3.500 88,9	6.56 167,0	5.63 143,0	10.43 265,0	2.50 63,5	13.4 6,1
4 DN100	4.500 114,3	9.45 240,0	3.70 94,0	10.43 265,0	3.50 90,0	55.0 25,0
6 DN150	6.625 168,3	10.15 258,0	8.68 220,5	23.60 600,0	4.92 125,0	79.2 36,0

Please refer to General Notes on page 17.

VALVES

BALL VALVES

Model BV835 Ball Valve

OPTIONAL WITH GEAR OPERATOR

Pressure Performance

VALVES

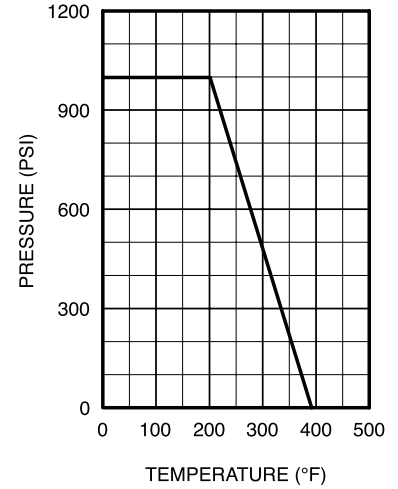
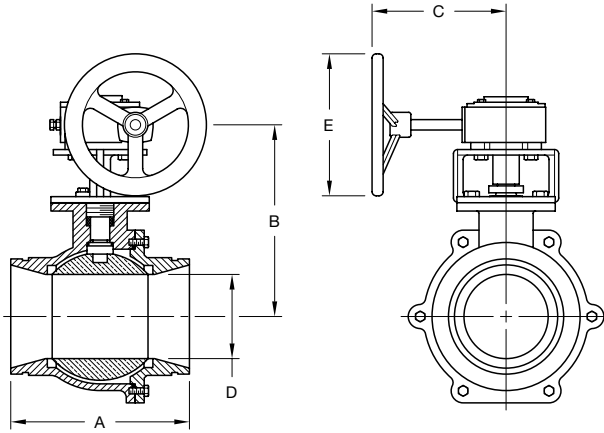

Nominal Pipe Size		Nominal Dimensions Inches mm					Approx. Weight lbs kg
ANSI Inches DN	O.D. Inches mm	A Inches mm	B Inches mm	C Inches mm	D Inches mm	E Inches mm	
2	2.375	5.50	5.38	8.00	1.50	6.00	18.0
DN50	60,3	140,0	137,0	203,2	38,1	152,4	8,0
2½	2.875	6.25	5.68	8.00	2.00	6.00	22.0
DN65	73,0	159,0	144,2	203,2	51,0	152,4	10,0
3	3.500	6.56	7.16	8.00	2.50	6.00	31.0
DN80	88,9	167,0	182,0	203,2	63,5	152,4	14,0
4	4.500	9.45	8.00	8.00	3.50	6.00	73.0
DN100	114,3	240,0	203,2	203,2	90,0	152,4	33,0
6	6.625	10.15	10.89	14.00	4.92	12.00	123.4
DN150	168,3	258,0	277,0	356,0	125,0	305,0	56,0

