

Fig. 1A - Clevis Hanger for Insulated Lines

Size Range — Size 3/4" thru 12" pipe.

Material — Carbon Steel

Function — Recommended for the suspension of insulated pipe where the temperature does not require the use of slides, guides or rollers for movement.

Approvals — Conforms to Federal Specification WW-H-171E, Type 1 and Manufacturers Standardization Society SP-69, Type1.

Maximum Temperature — 650°F

Finish — Plain

Note — Available in Electro-Galvanized and HDG finish or Stainless Steel.

Order By — Figure number, pipe size and finish

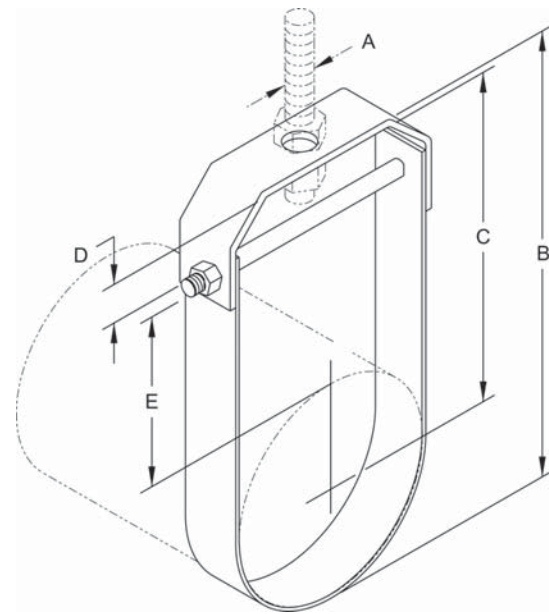

Dimensions • Weights

Pipe Size	Rod Size A	B	C	D	Max Insulation Thickness E	Max. Rec. Load Lbs.	Approx. Wt./100
3/4	3/8	4 1/4	3 3/8	1/2	2	610	54
1	3/8	4 11/16	3 3/4	5/8	2	610	59
1 1/4	3/8	5 1/4	4 1/8	7/8	2	610	62
1 1/2	3/8	5 3/4	4 9/16	1 1/16	2	610	67
2	3/8	8 11/16	7	1 5/8	4	610	84
2 1/2	1/2	9 15/16	8	2	4	1130	185
3	1/2	10 5/16	8 1/16	1 3/4	4	1130	205
4	5/8	11 5/8	8 11/16	1 15/16	4	1430	252
5	5/8	12 5/8	9 1/4	1 3/4	4	1430	309
6	3/4	14	9 7/8	1 7/8	4	1940	400
8	7/8	16 3/4	11	2	4	2000	607
10	7/8	19 3/16	12 1/4	2 1/8	4	3600	1032
12	7/8	21 9/16	13 5/8	2 7/16	4	3800	1315