

Penn Machine

Class 6000 Hex Bushing

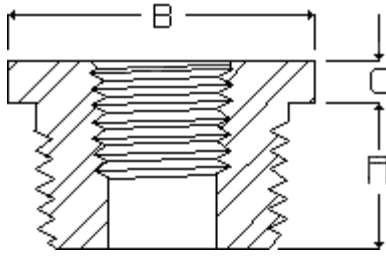

PENN CATALOG F2002 FIG NO. 06011
ASME-B16.11-2001

Nominal Pipe Size	1/4"	3/8"	1/2"	3/4"	1"	1-1/4"	1-1/2"	2"	2-1/2"	3"	3-1/2"	4"	5"	6"
Dimension A	1/2	9/16	11/16	3/4	7/8	7/8	15/16	1	1-3/16	1-3/8	1-1/2	1-1/2	1-1/2	1-3/4
Dimension B	5/8	11/16	7/8	1-1/16	1-3/8	1-3/4	2	2-1/2	3	3-5/8	4-1/4	4-3/4	5-3/4	6-3/4
Dimension C	1/8	5/32	3/16	7/32	1/4	9/32	5/16	11/32	1/2	1/2	5/8	5/8	3/4	3/4
Approx. Wt. (lbs)	.02	.04	.06	.11	.19	.39	.63	.79	1.19	2.56	5.50	7.06	9.32	13.15

Penn Machine

Class 6000 Flush Bushing

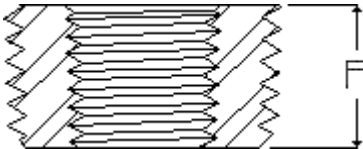

PENN CATALOG F2002 FIG NO. 06012
ASME-B16.11-2001

Nominal Pipe Size	1/4"	3/8"	1/2"	3/4"	1"	1-1/4"	1-1/2"	2"	2-1/2"	3"	3-1/2"	4"	5"	6"
Dimension A	7/16	1/2	9/16	5/8	3/4	13/16	13/16	7/8	1-1/16	1-1/8	1-3/16	1-1/4	1-1/4	1-3/8
Approx. Wt. (lbs)	.01	.02	.03	.05	.09	.17	.31	.37	.52	.90	.92	2.15	2.41	4.60

[Fitting catalog](#) | [Product catalog](#) | [Request quote/information](#) | [Home](#)

Web site created by Penn Machine. Send questions or comments to [James Friant](#).