

# PLAIN END FITTINGS

## Figures 910, 901, 919 & 960

Plain end fittings are manufactured to provide minimum pressure drop and uniform flow. Fittings are designed for use with the Figure 909 Plain End Couplings only.

Plain end fittings are available in a variety of styles.

Fittings are supplied with a rust inhibiting paint. Hot dip zinc galvanizing is available.

**PLAIN END  
PIPING  
SYSTEM**



**Figure 910  
90° Elbow**



**Figure 901  
45° Elbow**



**Figure 919  
Tee**



**Figure 960  
Bull Plug**

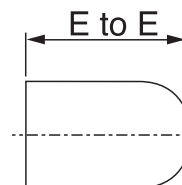
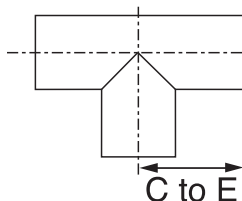
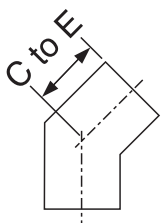
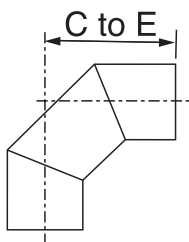

Figure 910 90° Elbow				Figure 901 45° Elbow		Figure 919 Tee		Figure 960 Bull Plug	
Nom. Size Inches mm	Pipe O.D. Inches mm	Center To End Inches mm	Approx. Wt. Ea. lbs kg	Center To End Inches mm	Approx. Wt. Ea. lbs kg	Center To End Inches mm	Approx. Wt. Ea. lbs kg	Center To End Inches mm	Approx. Wt. Ea. lbs kg
2 50	2.375 60.3	4¼ 121	2.7 1.2	3⅜ 79	2.0 0.9	4¼ 108	3.5 1.6	4 102	2.3 1.0
2½ 65	2.875 73.0	5½ 140	4.8 2.2	3½ 89	3.5 1.6	4¾ 121	6.2 2.8	5 127	3.0 1.4
3 80	3.500 88.9	6¼ 159	7.2 3.3	3¾ 95	4.8 2.2	5½ 130	8.6 3.9	6 152	4.5 2.0
4 100	4.500 114.3	7¾ 197	12.3 5.6	4¼ 108	8.0 3.6	5½ 149	13.8 6.3	7 178	7.5 3.4
5 125	5.563 141.3	9½ 241	13.4 6.1	5½ 130	9.2 4.2	6½ 175	21.7 9.8	8½ 216	12.5 5.7
6 150	6.625 168.3	11 279	31 14.1	5¾ 146	18.5 8.4	7½ 194	30.9 14.0	10 254	17.0 7.7
8 200	8.625 219.1	11 279	38.7 17.6	6 152	24.9 11.3	10 254	61.1 27.7	11 279	29.0 13.2

Please refer to General Notes on page 17.