

## Corner Mount CM927

### Features:

- Low cost
- Die cast and aluminum
- Easy to install

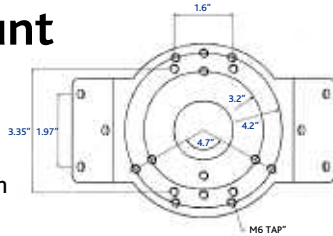

### Specifications:

**Enclosure mounting** . . . . .Ten (10) M6 x 15mm hex head Machine screw (supplied)  
**Construction Finish** . . . . .Die cast aluminum  
**Finish** . . . . .Light-gray polyester powder coat  
**Maximum load** . . . . .63.5 lbs.  
**Dimension** . . . . .See diagram above  
**Weight** . . . . .1.31 lbs.

## Pole Mount PM927

### Features:

- Low cost
- Die cast and aluminum
- Easy to install

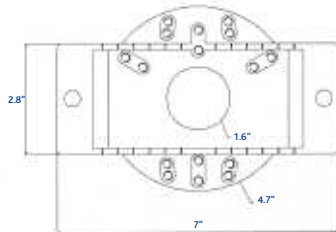

### Specifications:

**Enclosure mounting** . . . . .Ten (10) M6 x 15mm hex head Machine screws (supplied)  
 Two (2) M10 x 90mm hex head Machine screws (supplied)  
 Two (2) M10 hex nuts (supplied)  
**Construction Finish** . . . . .Die cast aluminum  
**Finish** . . . . .Light-gray polyester powder coat  
**Maximum load** . . . . .63.5 lbs.  
**Dimension** . . . . .See diagram above  
**Weight** . . . . .2.12 lbs.

## Parapet Mount PMT927

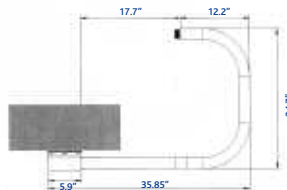

### Specifications:

**Construction Finish** . . . . .Aluminum, steel & stainless hardware  
**Finish** . . . . .Light-gray polyester powder coat  
**Maximum load** . . . . .20 lbs.  
**Dimension** . . . . .See diagram above  
**Weight** . . . . .23 lbs.

## Flush Mount Hardware FLM927

This mounting device enables the dome camera to be mounted to the suspended ceiling. The mounting clamps which are affixed to the ceiling tile, attach directly to the dome's mounting base for a quick and easy installation.

### Specifications:

**Construction** . . . . .Steel and injection molded plastic  
**Maximum Load** . . . . .Approx. 4.4 lbs.  
**Dimensions** . . . . .See diagram below

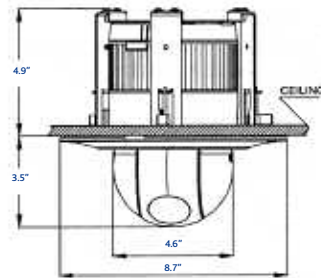

## T-Bar Mounting Adapter TBM927

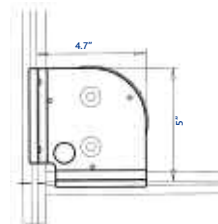

The mount enables the dome to be mounted to the T-bar of a suspended ceiling. The mounting clamps, which are affixed to the T-bar, attach directly to the dome's mounting base for a quick and easy installation.

### Features:

- Easy to install
- Indoor applications
- Steel construction
- Cable feed through hole conceals wiring
- Light duty ceiling mount

### Specifications:

**Construction** . . . . .Steel 1.6t  
**Maximum Load** . . . . .Approx. 4.4 lbs.  
**Finish** . . . . .Light-gray polyester powder coat

Specifications subject to change

