

- Specifications ←
- Diagrams ←
- Customize ←
- Custom Gallery ←
- Cutout Templates ←
- Accessories ←



ISO 9001:2000
Certified

TNP126

Tilt 'N Plug® Jr. Digital Tabletop Interconnect Box (with Circular Bezel)

- Support HDMI, USB, Ethernet, Stereo Audio, and Power
- Customizable (PN changes to TNP126C)
- Pre-Terminated 6' AV and Data Cables, 9-10' Power Cable
- All signals pass through to the underside of the table
- UL Pending
- U.S. Patent No. D437,827



[Customize your own TNP126](#)



Want to tell us what you think?
Feel free to post your comments here:
(Please include your email address if you would like us to respond.)

[Send](#)



[PDF Cutout](#)



[DXF Cutout \(right click & save\)](#)



[User Guide](#)



[Printable Version](#)

All Tilt' N Plug Jr products belong to a family of compact interconnection solutions designed for installation into a table as part of a presentation system. They are designed for mounting into a table, podium, or other furniture to provide a way of connecting audiovisual equipment on top of the furniture to a presentation system below the furniture.

All use the same core element; a multimedia input plate that can be "tilted" open when needed and pushed closed when not needed.

All signals pass through the input plate directly to cables on the underside of the table with no intervening circuitry. The use of additional ALTINEX Signal Management Solutions such as computer video interfaces, distribution amplifiers, and switchers may be desirable.

The input plate of the Tilt'N Plug Jr. is accessible by pushing down on the top cover. The unit then auto-tilts open with help from an internal pneumatic spring. Once open, the input plate remains securely in place. The input plate is hidden by pressing down on the top cover until the latching mechanism engages. In its closed position, the top panel lies flush with the table's top, held in place by the latching mechanism.

The **TNP126** provides a single input plate with HDMI, USB-A, network (RJ-45 F-M), and computer/MP3 audio (3.5mm F-M) input connections in 6ft (2m) lengths. It also provides an AC Power connection in 9-10ft (2.7-3.0m) suitable for use throughout the U.S. and Canada.

All Tilt' N Plug Jr. Signal Management Solutions come with a standard top and bezel offering a high quality matte black finish. The unit can also be customized with different connections and colors. To do so, click the link shown

above.

Specifications

GENERAL	ELECTRICAL
AC Power: (1) NEMA F-M, 110VAC, 60Hz, 5A, 9-10ft (2.7-3.0m)	Single Outlet Panel Power Rating (pass-through AC power) : 110VAC, 60Hz, 5A per connector
Digital Audio & Video: (1) HDMI F-M, 6ft (2m)	
USB Data & Power: (1) USB-A F-M, 6ft (2m)	
Network: (1) RJ-45 F-M, 6ft (2m)	
Stereo Audio: (1) 3.5mm F-M, 6ft (2m)	
UL Listed: Pending	
MECHANICAL	ACCESSORIES
Max. Table Thickness: 2.25in (57mm)	Included:
Height, opened: 5.50in (140mm)	Mounting screws and brackets
Diameter: 5.8in (147mm)	Cable clamps/screws
Finish: Matte Black	
Weight (approx.) 2.8lb (1.3kg)	
Shipping Weight: 4.5lb (2.0kg)	
T° Maximum: 40°C	
T° Operating: 10°C-35°C	
Humidity: 90% non-condensing	

Application Diagram

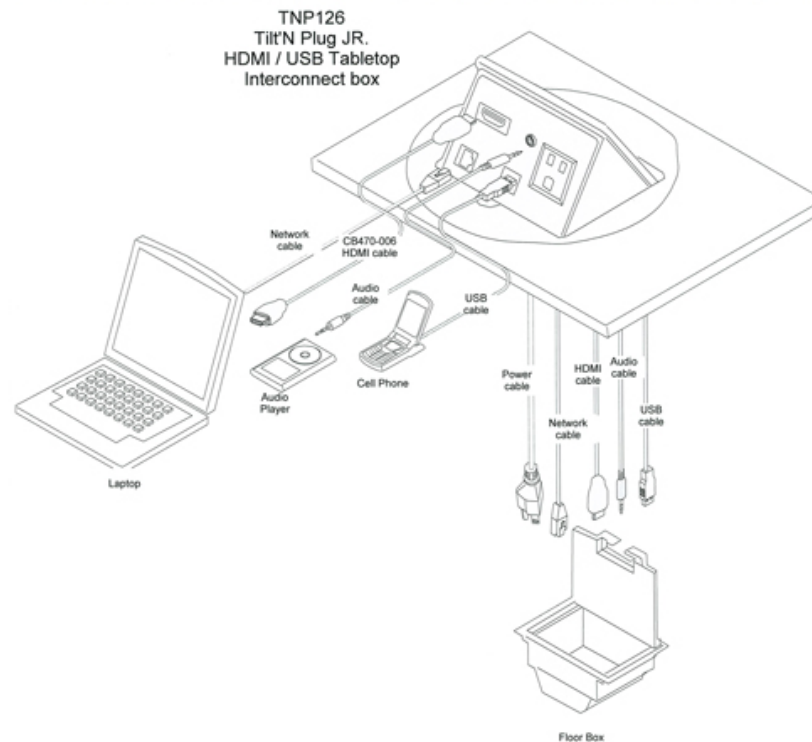

Dimensions

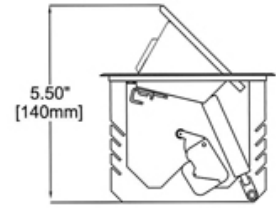
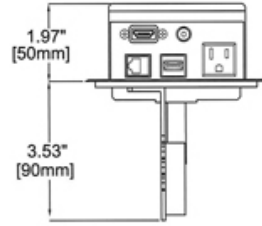
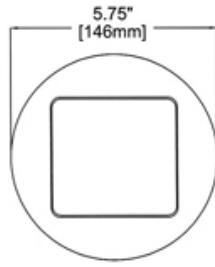

Specifications subject to change without notice. Do not use the diagram above to perform table/wall modification.

Copyright © 2010 ALTINEX, Inc. All rights reserved. | v5.1 | **1.800.ALTINEX** | Terms of Use | Terms & Conditions | Privacy