

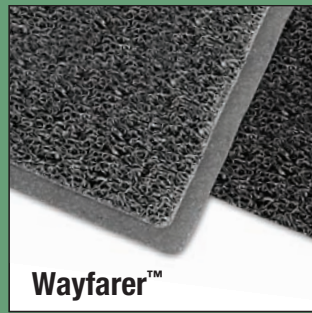

Rubber Brush™

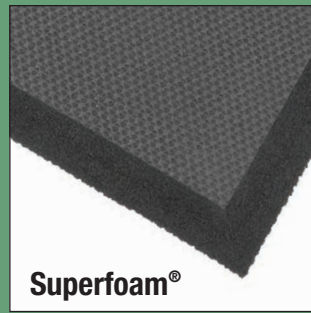

Wayfarer™



Superfoam®

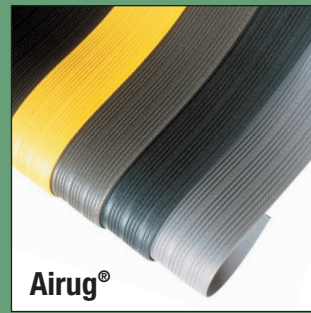

Airug®



Marble Sof-tyle™



Cushion Trax®



Arrow Trax™



Sabre™



Uptown™/Boulevard™



Logo Mats

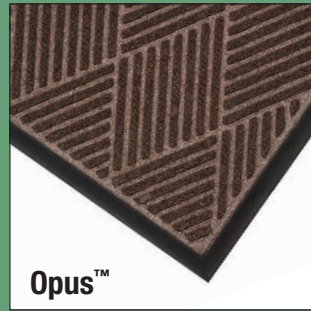

Opus™



Niru® Versa Runner®



Cushion-Ease®



Sanitop®



Modular Lok-Tyle™



V-Groove Runner

NOTRAX® FLOOR MATTING



Superior Manufacturing Group, Inc.
5655 W. 73rd St. • Bedford Park, IL 60638
Phone: 800.621.2802 Fax: 800-322-7105
Email: info@notrax.com • Web: www.notrax.com

SCHOOL MATTING APPLICATION GUIDE

| LOCATION | ITEM # - PRODUCT |
|-------------------------------------|---|
| 1 MAIN ENTRANCE (OUTSIDE) | 231 - Prelude™ - GREENTRAX 340 - Soil Guard™ - GREENTRAX 345 - Rubber Brush™ - GREENTRAX |
| 2 MAIN ENTRANCE (INSIDE) | 117 - Heritage Rib® - GREENTRAX 136 - Polynib™ - GREENTRAX 139 - Boulevard™ - GREENTRAX 145 - Preference™ 150 - Aqua Trap® - GREENTRAX 370 - Master Trax™ 118 - Arrow Trax™ - GREENTRAX 138 - Uptown™ - GREENTRAX 141 - Ovation™ - GREENTRAX 146 - Encore™ - GREENTRAX 161 - Barrier Rib™ - GREENTRAX Logo Mats |
| 3 NURSE/MAIN OFFICE | 170 - OrienTrax™ 470 - Marble Sof-Tyle™ 825 - Cushion-Stat™ |
| 4 RESTROOMS/HALLWAY | 117 - Heritage Rib® 118 - Arrow Trax™ - GREENTRAX 130 - Sabre™ Decalon® 131 - Dante™ Decalon® 132 - Estes™ - GREENTRAX 136 - Polynib™ - GREENTRAX |
| 5 LOCKER ROOM/POOL | 265 - Wayfarer™ 266 - Wayfarer™ Custom 523 - Modular Lok-Tyle™ 531 - Safety Grid™ 755 - Niru® Versa Runner® - MICROSTOP 758 - Niru® Knob-Top Runner™ - MICROSTOP |
| 6 GYM/WEIGHT ROOM | 045 - Weight Room Matting 131 - Dante™ Decalon® 735 - Round Rib Runner Logo Mats 130 - Sabre™ Decalon® 730 - V-Groove Runner (Vinyl) 750 - V-Groove Runner (Rubber) |
| 7 LIBRARY | 170 - OrienTrax™ 479 - Cushion Trax® 825 - Cushion-Stat™ 410 - Airug® 769 - Clear Trax™ T17 - Superfoam® |
| 8 SIDE/REAR EXITS | 117 - Heritage Rib® 146 - Encore™ - GREENTRAX 167 - Portrait™ - GREENTRAX 340 - Soil Guard™ - GREENTRAX 118 - Arrow Trax™ - GREENTRAX 166 - Guzzler™ - GREENTRAX 168 - Opus™ - GREENTRAX 345 - Rubber Brush™ - GREENTRAX |
| 9 AUDITORIUM | 130 - Sabre™ Decalon® 410 - Airug® T17 - Superfoam® 131 - Dante™ Decalon® 479 - Cushion Trax® Logo Mats |
| 10 LABS | 410 - Airug® 470 - Marble Sof-Tyle™ 755 - Niru® Versa Runner® - MICROSTOP 758 - Niru® Knob-Top Runner™ - MICROSTOP 825 - Cushion-Stat™ 826 - Diamond Stat™ T17 - Superfoam® |
| 11 KITCHEN/CAFETERIA | 117 - Heritage Rib® 118 - Arrow Trax™ - GREENTRAX 231 - Prelude™ - GREENTRAX 265 - Wayfarer™ 543 - Cushion-Tred™ - MICROSTOP (Red only) 550 - Cushion-Ease® - MICROSTOP (Red only) 556 - Cushion-Ease® Solid - MICROSTOP (Red only) 562 - Sanitop® - MICROSTOP (Gray & Red only) 750 - V-Groove Runner (Rubber) 755 - Niru® Versa Runner® - MICROSTOP 758 - Niru® Knob-Top Runner™ - MICROSTOP 765 - Deep Freeze Matting T17 - Superfoam® |
| 12 STORAGE ROOM/LOADING DOCK | 117 - Heritage Rib® 118 - Arrow Trax™ - GREENTRAX 410 - Airug® 680 - Safety Trax™ 730 - V-Groove Runner (Vinyl) 755 - Niru® Versa Runner® |
| 13 SPECIALITY CLASS ROOMS | 410 - Airug® 470 - Marble Sof-Tyle™ 562 - Sanitop® - MICROSTOP (Gray & Red only) 826 - Diamond Stat™ 831 - Diamond Switchboard Matting 951 - Knee RX Heavy Duty Kneeling Pad T17 - Superfoam® 419 - Diamond Sof-Tred™ 479 - Cushion Trax® 825 - Cushion-Stat™ 830 - Switchboard Matting 950 - Knee RX Heavy Duty Kneeling Pad |
| 14 CUSTODIAL/BOILER ROOM | 410 - Airug® 479 - Cushion Trax® 825 - Cushion-Stat™ 830 - Switchboard Matting 950 - Knee RX Heavy Duty Kneeling Pad T17 - Superfoam® 419 - Diamond Sof-Tred™ 562 - Sanitop® - MICROSTOP (Gray & Red only) 826 - Diamond Stat™ 831 - Diamond Switchboard Matting 951 - Knee RX Heavy Duty Kneeling Pad |

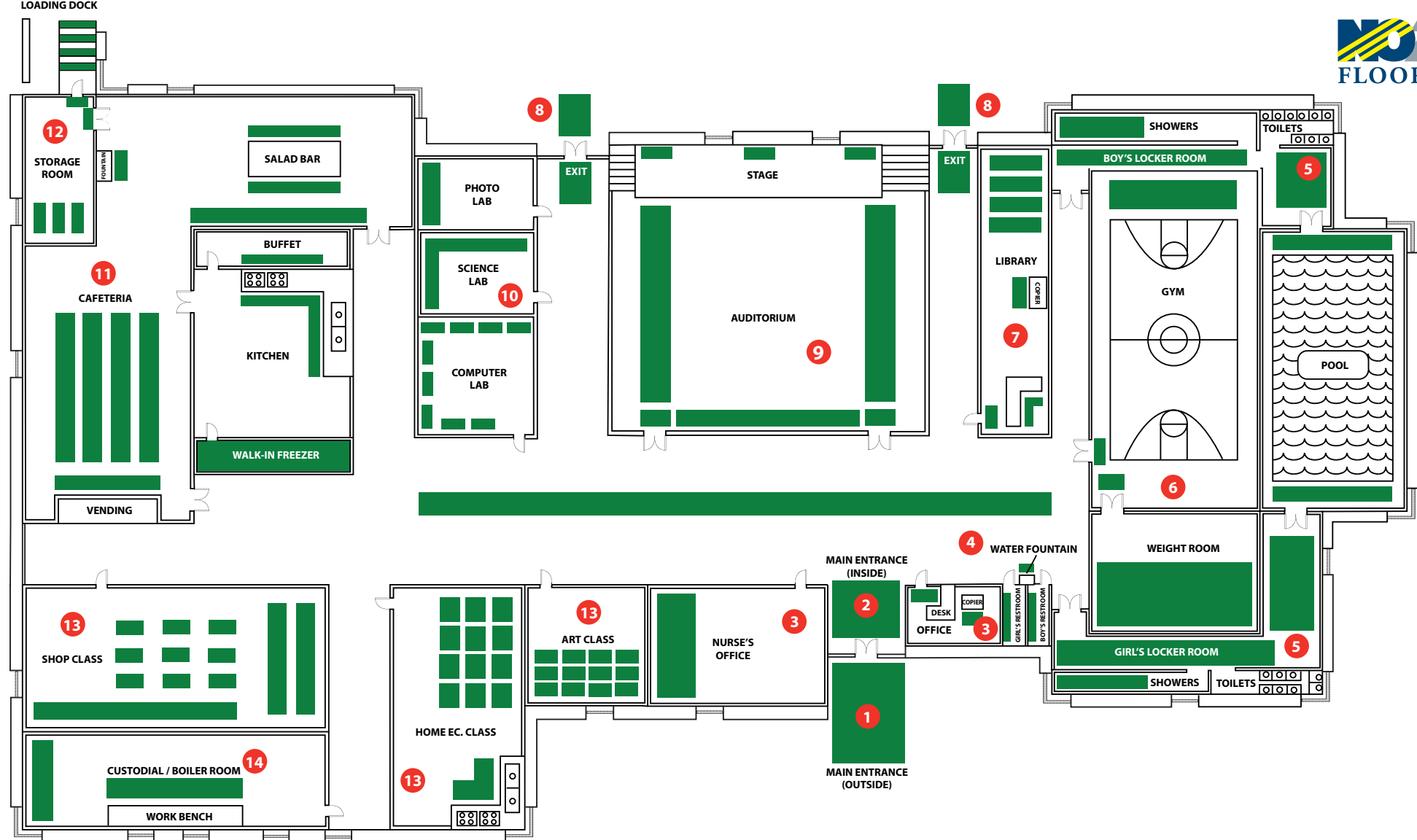

CHOOSING THE RIGHT MAT

YOUR MAT SELECTION SHOULD BE BASED ON FUNCTIONALITY (SCRAPE-N-CLEAN, ANTI-FATIGUE, SAFETY), ENVIRONMENT (WET, DRY), QUALITY, AND VALUE.

PRODUCTS FEATURING THE MICROSTOP™ LOGO ARE MADE WITH A UNIQUE ANTI-MICROBIAL RUBBER COMPOUND THAT INHIBITS THE GROWTH OF MICROORGANISMS SUCH AS BACTERIA, AND FUNGI THAT CAN CAUSE ODOR, STAINS, AND PRODUCT DETERIORATION. UNLIKE ANTI-MICROBIAL TREATMENTS, MICROSTOP™ IS INCORPORATED DIRECTLY INTO THE MAT DURING THE MANUFACTURING PROCESS SO IT CANNOT BE WASHED OFF OR WEAR AWAY OVER TIME. FLOOR MATTING PRODUCTS WITH MICROSTOP™ SHOULD BE USED IN CONJUNCTION WITH STANDARD CLEANING AND DISINFECTING PRACTICES IN ORDER TO PROVIDE A CLEANER AND HEALTHIER WORK ENVIRONMENT.

Products featuring the GreenTRAX™ logo are top-rated for use in "Green Cleaning" applications

LOCATION AND MAT RECOMMENDATION

| LOCATION | GOOD BETTER BEST SUPERIOR SPECIALITY | DESCRIPTION |
|------------------------------|---|---|
| 1 Main Entrance (Outside) | #231, #340**, #345** | All weather materials to withstand the elements |
| 2 Main Entrance (Inside) | #117, #118, #136, #138, #139, #141, #145, #146, #150, #161, #370, Logo Mats | Functionality & Aesthetics in high traffic areas |
| 3 Nurse/Main Office | #170, #470, #825* | *825 Anti-static matting for use with copiers or other sensitive machinery |
| 4 Restrooms/Hallway | #117, #118, #130, #131, #132, #136 | Keeps hallways cleaner, provides anti-slip |
| 5 Locker Room/Pool | #265, #266, #523, #531, #755, #758 | Allows for drainage, provides anti-slip safety in wet areas |
| 6 Gym/Weight Room | #045, #130, #131, #730, #735, #750, Logo Mats | To provide cushioning and/or assists in prevention of slips and falls |
| 7 Library | #170, #410, #479, #769, #825*, #T17 | *825 Anti-static matting for use with copiers or other sensitive machinery |
| 8 Side/Rear Exits | #117, #118, #146, #166, #167, #168, #340**, #345** | **340, 345 mats - All weather mats to withstand the elements |
| 9 Auditorium | #130, #131, #410, #479, #T17, Logo Mats | To keep aiseways and doorways clean, provides anti-slip |
| 10 Labs | #410, #470, #755, #758, #825*, #826*, #T17 | *825, 826 Anti-static matting for use with sensitive testing equipment |
| 11 Kitchen/Cafeteria | #117, #118, #231, #265, #543, #550, #556, #562, #750, #755, #758, 765, #T17 | Some rubber kitchen mats are anti-microbial, (765) rated for cold temperatures |
| 12 Storage Room/Loading Dock | #117, #118, #410, #680**, #730, #755 | **680 slip resistant pads for stairs and/or ramps, runners for aiseways |
| 13 Specialty Class Rooms | #410, #419, #470, #479, #562, #825*, #826*, #830*, #831*, #950, #951, #T17 | *825, 826 Anti-static matting for use with sensitive machinery |
| 14 Custodial/Boiler Room | #410, #419, #479, #562, #825*, #826*, #830*, #831*, #950, #951, #T17 | Variety of applications: anti-static, non-conductive, anti-fatigue, kneeling mats |