

Submersible Hydraulic Elevator Pump Motors



The Lincoln Experience

Introducing the Submersible Hydraulic Elevator Pump Motors! Our Submersible Hydraulic Elevator Pump Motors are ready to be placed into your elevator systems for applications in Hydraulic pump passenger, service, freight and low rise elevators. Most hydraulic elevators travel up to 6 floors at speeds up to 200 fpm. The motors are designed for the demands in the hydraulic elevator pump industry. We offer this in foot mounted 160ZBS.

- **Ratings:** 15 hp through 50 hp. Totally Open Frame Construction.
- 3600 rpm
- 3 phase, 60 Hertz
- 200 Volts, 230/460 Volts, and later, 575 Volts all suitable for Wye-Delta Starters.
- **Duty:** Intermittent
- **1.0SF and Max 70°C Ambient**
- **Mounting Face:** Three bolt circles, 12 mounting holes, and face mounting to accept both the IMO and Allweiler pumps.
- **10 feet long leads.** Leads are butt spliced at about 48 inches from the motor housing to preventing wicking of hydraulic fluid. Butt splice at 10" or 12" as to attach the long leads.
- Number of power leads is 12 for dual voltage, 230/460 Volts, marked T1 through T12. There are 2 thermostats leads marked P1 and P2. There is 1 green ground lead.
- **Insulation:** Class F
- **Nameplate:** Stainless steel nameplate on motor. A second nameplate shall be supplied for mounting outside of the tank without UL, CSA & CE logos. The nameplate should list the opposite DE bearing AFBMA number. The nameplate states "DUTY INT". CSA, UL and CE will be required on production units.
- **"WARNING PLATE"** also is provided, mounted on the motor next to the nameplate with a second warning plate for separate mounting.

**Contact Lincoln Motors for your next
Submersible Hydraulic Elevator Pump Motors Opportunity**



A REGAL-BELOIT COMPANY

Think
Experience.

Serving the
Elevator Industry
Since 1908.

Submersible
Hydraulic
Elevator
Pump
Motors

The Lincoln Experience

General Information

HP	Product No.	BTU/HR Motor Losses	LRA@ 460V	KvA Code	FL Eff/PF For N/P	Frame Size	Voltage	Weight (Lbs.)
15	LM29656	14736	288	H	106	160Z	200	110
	LM29657	14736	125	H	46/23		200/460	110
	LM29658	14736	100	H	18.4		575	110
20	LM29659	11792	363	G	64.4	160Z	200	112
	LM29660	11792	158	G	56/28		230/460	112
	LM29661	11792	126	G	22.4		575	112
25	LM29662	10148	432	G	77.1	160Z	200	115
	LM29663	10148	188	G	67/33.5		230/460	115
	LM29664	10148	150	G	26.8		575	115
30	LM29665	9603	522	G	92	160Z	200	119
	LM29666	9603	227	G	80/40		230/460	119
	LM29667	9603	182	G	32		575	119
40	LM29668	7271	683	G	115	160Z	200	132
	LM29669	7271	297	G	100/50		230/460	132
	LM29670	7271	238	G	40		575	132
50	LM29671	7271	915	H	140	160Z	200	143
	LM29672	7271	395	H	122/61		230/460	143
	LM29673	7271	318	H	48.8		575	143

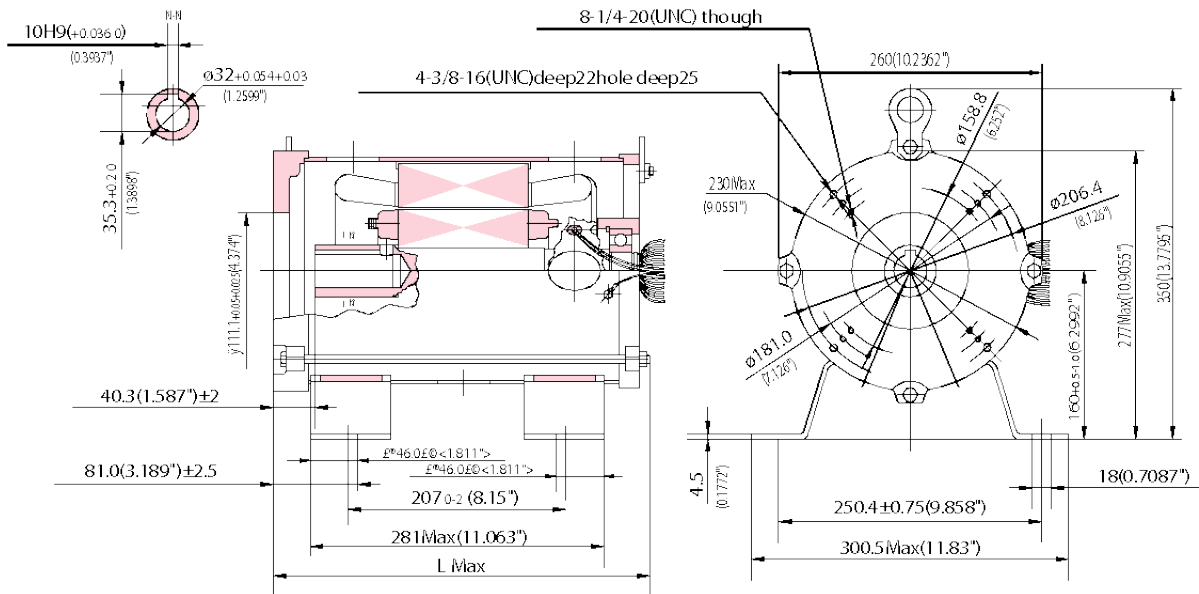

A REGAL-BELOIT COMPANY

28300 Euclid Ave. Suite 200, Cleveland, OH 44092

Phone: 216-731-4790 • Fax: 216-731-5401

www.lincolnmotors.com

Submersible
Hydraulic
Elevator
Pump
Motors