

### “D” SECTION

### 12 GROOVES

#### Dimensions

Datum dia.	O.D.	Part No.	List Price	Mult. Sym.	F = 17 9/16 inches					
					H	Type	B	L	E	Approx. Wt. (lbs)
12.0	12.6	<b>12D120</b>	1720.00	QDS07	3 9/32	1B	M <sup>o</sup>	6 3/4	7 17/32	187
13.0	13.6	<b>12D130</b>	1800.00	QDS07	3 9/32	1B	M <sup>o</sup>	6 3/4	7 17/32	234
13.5	14.1	<b>12D135</b>	1860.00	QDS07	3 9/32	1B	M <sup>o</sup>	6 3/4	7 17/32	252
14.0	14.6	<b>12D140</b>	1880.00	QDS07	3 9/32	1B	M <sup>o</sup>	6 3/4	7 17/32	271
14.5	15.1	<b>12D145</b>	2000.00	QDS07	3 9/32	1B	M <sup>o</sup>	6 3/4	7 17/32	290
15.0	15.6	<b>12D150</b>	2120.00	QDS07	3 9/32	1B	M <sup>o</sup>	6 3/4	7 17/32	310
15.5	16.1	<b>12D155</b>	2180.00	QDS07	3 9/32	1B	M <sup>o</sup>	6 3/4	7 17/32	330
16.0	16.6	<b>12D160</b>	2200.00	QDS07	3 9/32	1B	M <sup>o</sup>	6 3/4	7 17/32	352
17.0	17.6	<b>12D170</b>	2320.00	QDS07	3 15/32	1W	M <sup>o</sup>	6 3/4	7 11/32	365
18.0	18.6	<b>12D180</b>	2420.00	QDS07	3 15/32	1W	M <sup>o</sup>	6 3/4	7 11/32	391
20.0	20.6	<b>12D200</b>	2760.00	QDS07	3 9/32	1W	M <sup>o</sup>	6 3/4	7 17/32	401
22.0	22.6	<b>12D220</b>	2980.00	QDS07	2 9/32	1A	M <sup>o</sup>	6 3/4	7 17/32	365
27.0	27.6	<b>12D270</b>	3640.00	QDS07	2 1/8	1A	N <sup>o</sup>	8 1/8	7 5/16	505
33.0	33.6	<b>12D330</b>	4380.00	QDS07	2 1/8	1A	N <sup>o</sup>	8 1/8	7 5/16	590
40.0	40.6	<b>12D400</b>	5040.00	QDS07	3/16	1A	P <sup>o</sup>	9 3/8	8	925
48.0	48.6	<b>12D480</b>	6180.00	QDS07	3/16	1A	P <sup>o</sup>	9 3/8	8	1150
58.0	58.6	<b>12D580</b>	6760.00	QDS07	3/16	1A	P <sup>o</sup>	9 3/8	8	1500

P.D. for “D” Belts = O.D.

\*Note: M-N-P-W bushings are standard mounting only with these parts.

Type of sheave “T”: A = arms; B = block; W = web

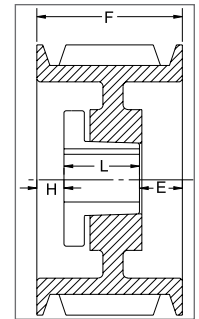

TYPE 1