

Forged Steel Fittings

Class 3000 Threaded

Malleable Iron

Cast Iron

Small Steel Fittings

Pipe Nipples & Pipe Couplings

Forged Steel Fittings & Unions

Anvils

Catawissa

J.B. Smith Products

Carton Information

FIGURE 2115
Crosses

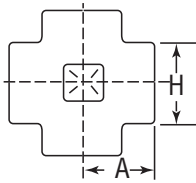

Size		A		H		Unit Weight	
NPS	DN	in	mm	in	mm	lbs	kg
1/8	6	0.81	21	0.88	22	-	-
1/4	8	0.97	25	1.00	25	-	-
3/8	10	1.12	28	1.31	33	-	-
1/2	15	1.31	33	1.50	38	1.40	0.63
3/4	20	1.50	38	1.81	46	2.10	0.95
1	25	1.75	44	2.19	56	3.50	1.59
1 1/4	32	2.00	51	2.44	62	4.30	1.95
1 1/2	40	2.38	60	2.97	75	8.20	3.72
2	50	2.50	64	3.31	84	8.40	3.81
2 1/2	65	3.25	83	4.00	102	17.10	7.76
3	80	3.75	95	4.75	121	20.00	9.07
4	100	4.50	114	6.00	152	32.00	14.51

FIGURE 2113
90° Street Elbows

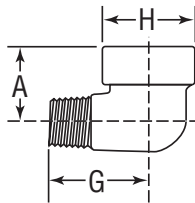

Size		A		G		H		Unit Weight	
NPS	DN	in	mm	in	mm	in	mm	lbs	kg
1/8	6	0.75	19	1.00	25	0.75	19	-	-
1/4	8	0.88	22	1.25	32	1.00	25	0.23	0.10
3/8	10	1.00	25	1.50	38	1.25	32	0.38	0.17
1/2	15	1.12	28	1.62	41	1.50	38	0.53	0.24
3/4	20	1.38	35	1.88	48	1.75	44	0.88	0.40
1	25	1.75	44	2.25	57	2.00	51	1.40	0.63
1 1/4	32	2.00	51	2.62	66	2.44	62	2.40	1.09
1 1/2	40	2.12	54	2.81	71	2.75	70	2.90	1.32
2	50	2.50	64	3.31	84	3.31	84	5.00	2.27

FIGURE 2116
Laterals

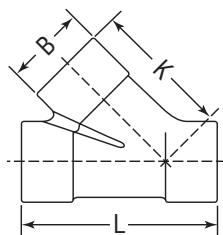

Size		B		K		L		Unit Weight	
NPS	DN	in	mm	in	mm	in	mm	lbs	kg
1/2	15	1.56	39.62	2.56	65.02	3.56	90.42	1.75	0.79
3/4	20	1.84	46.74	3.00	76.20	4.13	104.90	2.75	1.24
1	25	2.22	56.39	3.50	88.90	4.81	122.17	4.65	2.09
1 1/4	32	2.50	63.50	3.94	100.08	5.38	136.65	5.50	2.48
1 1/2	40	3.03	79.96	4.75	120.65	6.44	163.58	10.831	4.87
2	50	3.34	84.84	5.00	127.00	6.63	168.40	9.50	4.28