

Cast Iron Threaded Fittings

Class 125 (Standard)

FIGURE 359
Tee Reducing

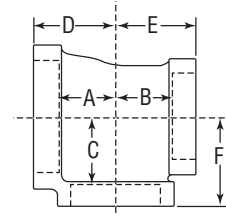

Size				A	B	C	D	E	F	Unit Weight									
NPS	DN	NPS	DN	in	mm	in	mm	in	mm	in	mm	in	mm	lbs	kg				
2	50	1/2	15	1 1/2	40	1 5/16	24	1 3/8	35	1 1/2	38	2	51	1 13/16	47	2 1/8	54	2.95	1.34
				2	50	1 9/16	40	1 7/16	37	1 9/16	40	2 1/4	57	1 7/8	48	2 1/4	57	3.30	1.50
		3/4	20	1 1/4	32	1 3/16	22	1 1/8	29	1 7/16	37	1 7/8	48	1 3/4	44	2 1/16	52	2.50	1.13
				1 1/2	40	1 5/16	24	1 5/16	24	1 1/2	38	2	51	1 13/16	47	2 1/8	54	3.40	1.54
		2	50	1 9/16	40	1 7/16	37	1 9/16	40	2 1/4	57	1 5/8	49	2 1/4	57	3.31	1.50		
				1	25	1 1/16	17	1 1/16	17	1 7/16	37	1 3/4	44	1 5/8	41	2	51	2.70	1.22
		1	25	1 1/4	32	1 3/16	22	1 1/8	29	1 1/2	38	1 7/8	48	1 3/4	44	2 1/16	52	2.94	1.33
				1 1/2	40	1 5/16	24	1 1/4	32	1 1/2	38	2	51	1 13/16	47	2 1/8	54	2.85	1.29
		2	50	2	50	1 9/16	40	1 7/16	37	1 9/16	40	2 1/4	57	2	51	2 1/4	57	3.46	1.57
				2 1/2	65	1 7/8	48	1 13/16	47	1 9/16	40	2 9/16	65	2 3/8	60	2 7/16	62	4.88	2.21
		1 1/4	32	1/2	15	1 1/16	17	1	25	1 7/16	37	1 3/4	44	1 5/8	41	2	51	2.48	1.12
				3/4	20	7/8	22	7/8	22	1 7/16	37	1 9/16	40	1 1/2	38	1 15/16	49	2.50	1.13
		1	25	1	25	1 1/16	17	1	25	1 7/16	37	1 3/4	44	1 5/8	41	2	51	2.73	1.24
				1 1/4	32	1 3/16	22	1 1/8	29	1 7/16	37	1 7/8	48	1 3/4	44	2 1/16	52	2.90	1.32
		1 1/2	40	1 1/2	40	1 5/16	24	1 1/4	32	1 1/2	38	2	51	1 7/8	48	2 1/8	54	3.13	1.42
				2	50	1 9/16	40	1 7/16	37	1 9/16	40	2 1/4	57	2 1/16	52	2 1/4	57	3.71	1.68
		2 1/2	65	1 7/8	48	1 3/4	44	1 9/16	40	2 9/16	65	2 3/8	60	2 7/16	62	4.54	2.06		
				1/2	15	1 3/16	22	1 3/16	22	1 7/16	37	1 1/2	38	1 7/16	37	1 7/8	48	2.34	1.06
		3/4	20	7/8	22	7/8	22	7/8	22	1 7/16	37	1 9/16	40	1 1/2	38	1 15/16	49	2.46	1.12
				1	25	1 1/16	17	1	25	1 7/16	37	1 3/4	44	1 5/8	41	2	51	2.66	1.21
		1 1/4	32	1 1/4	32	1 3/16	22	1 3/16	22	1 7/16	37	1 7/8	48	1 13/16	47	2 1/16	52	2.98	1.35
				1 1/2	40	1 5/16	24	1 5/16	24	1 1/2	38	2	51	1 15/16	49	2 1/8	54	3.24	1.47
		2	50	2	50	1 9/16	40	1 1/2	38	1 9/16	40	2 1/4	57	2 1/8	54	2 1/4	57	3.70	1.68
				2 1/2	65	1 7/8	48	1 15/16	49	1 9/16	40	2 9/16	65	2 9/16	65	2 7/16	62	5.46	2.48
1/2	15	1 1/2	40	1 5/16	24	1 5/16	24	1 1/2	38	2	51	1 15/16	49	2 1/8	54	3.24	1.47		
		2	50	1 9/16	40	1 1/2	38	1 9/16	40	2 1/4	57	2 1/8	54	2 1/4	57	3.70	1.68		
2 1/2	65	1 7/8	48	1 15/16	49	1 9/16	40	2 9/16	65	2 9/16	65	2 9/16	65	2 7/16	62	5.46	2.48		
		1/2	15	1 3/16	22	1 3/16	22	1 7/16	37	1 1/2	38	1 7/16	37	1 7/8	48	2.74	1.24		
3/4	20	7/8	22	7/8	22	7/8	22	1 7/16	37	1 9/16	40	1 9/16	40	1 15/16	49	2.86	1.30		
		1	25	1 1/16	17	1 1/16	17	1 7/16	37	1 3/4	44	1 3/4	44	2	51	3.05	1.38		
1 1/4	32	1 1/4	32	1 3/16	22	1 3/16	22	1 7/16	37	1 7/8	48	1 7/8	48	2 1/16	52	3.38	1.53		
		1 1/2	40	1 5/16	24	1 5/16	24	1 1/2	38	2	51	2	51	2 1/8	54	3.59	1.63		
2 1/2	65	1 7/8	48	1 7/8	48	1 7/8	48	1 9/16	40	2 9/16	65	2 9/16	65	2 7/16	62	5.17	2.34		
		3	100	3	76	3	76	2 7/16	62	3 11/16	94	3 11/16	94	3 1/2	89	7.87	3.57		

Continued on next page.

Note: See page 37 for pressure-temperature ratings.