

WELD CAPS

316L STAINLESS STEEL

- Manufactured in accordance to ASTM A-774 specifications.
- Larger sizes and other gauges are available upon request.
- Dimensions are given in inches.

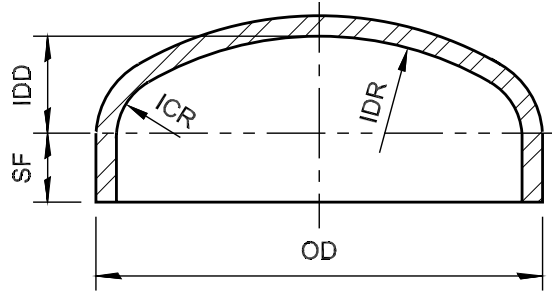

NOMINAL PIPE SIZE	OD	THICKNESS	IDD	IDR	ICR	SF	LBS
2	2.375	.109	.516	1.810	.340	.500	.30
2 1/2	2.875	.120	.690	2.250	.430	.500	.40
3	3.500	.120	.764	2.690	.510	.500	.72
4	4.500	.120	1.003	3.520	.670	.500	1.30
6	6.625	.134	1.520	5.310	1.010	.750	3.30
8	8.625	.148	1.998	6.930	1.330	.750	5.50
10	10.750	.165	2.505	8.770	1.670	.750	11.00
12	12.750	.180	3.005	10.500	2.000	.750	14.50

QUICK CLAMPS

304L STAINLESS STEEL

- Face rings are 316L stainless steel.
- Dimensions are given in inches.

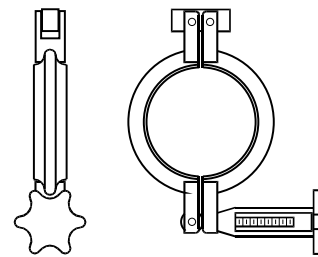

NOMINAL PIPE SIZE	CLAMPS	FACE RINGS				DISC
	LBS	ID	OD	THICKNESS	LBS	LBS
3	2.83	3.520	4.560	10GA	.25	.58
4	3.02	4.520	5.500	10GA	.28	.84
6	3.37	6.650	7.750	10GA	.45	1.66
8	3.76	8.650	9.940	10GA	.67	2.72
10	4.16	10.780	11.840	10GA	.78	3.86
12	4.41	12.780	14.000	10GA	.94	5.28
14	4.80	14.060	15.280	10GA	1.07	6.10
16	5.25	16.060	17.280	10GA	1.21	7.02
18	5.85	18.060	19.280	10GA	1.36	8.20

Felker Stainless Steel Quick Clamps were designed for low pressure service applications. They have been used successfully in food, dairy, paper, chemical, and sewage treatment plants for several years. Quick Clamps are used for connecting pipe and fittings or are used with a solid disc for blanking the end of pipe. 1/8" thick neoprene gaskets are furnished with clamps. Two special face rings are required and must be ordered separately per the chart above.