

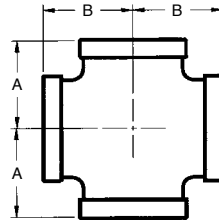

Model 817 Cross



Cross

Unit: Inch

Size	A	B	Wt. Lbs.	Box Q'ty
1/2	1.12	1.12	0.40	90
3/4	1.31	1.31	1.80	60
1	1.50	1.50	0.97	45
1-1/4	1.75	1.75	1.58	25
1-1/2	1.94	1.94	1.89	20
2	2.25	2.25	0.73	10

Model 817 Reducing Cross

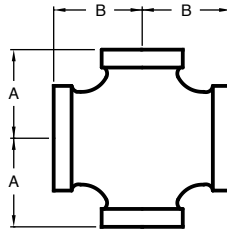

Reducing Cross

Unit: Inch

Size	A	B	Wt. Lbs.	Box Q'ty
1-1/4x1-1/4x1x1	1.67	1.58	1.25	30
1-1/2x1-1/2x1x1	1.80	1.65	1.47	24
2 x 2 x 1 x 1	2.02	1.73	2.64	10

Model 818 Straight Coupling

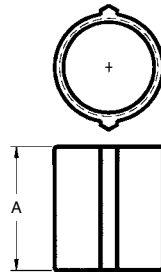

Straight Coupling

Unit: Inch

Size	A	Wrench Size	Wt. Lbs.	Box Q'ty
1/2	1.38	1-1/8"	0.18	360
3/4	1.61	1-3/8"	0.26	200
1	1.77	1-11/16"	0.44	110
1-1/4	2.00	2"	0.55	75
1-1/2	2.20	2-1/4"	0.71	60
2	2.60	2-3/4"	1.15	30
2-1/2	3.00	3-3/8"	2.29	18

Model 819 Plug

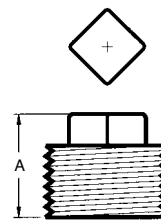

Plug

Unit: Inch

Size	A	Wt. Lbs.	Box Q'ty
1/2	0.93	0.09	500
3/4	1.13	0.18	300
1	1.25	0.25	200
1-1/4	1.36	0.51	110
1-1/2	1.45	0.71	80
2	1.50	0.99	45

Model 820 Cap

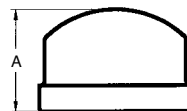

Cap

Unit: Inch

Size	A	Wt. Lbs.	Box Q'ty
1/2	0.89	0.14	500
3/4	1.00	0.20	300
1	1.18	0.33	180
1-1/4	1.32	0.46	110
1-1/2	1.38	0.57	80
2	1.48	0.88	45
2-1/2	1.77	1.54	25