

MODEL

# C306 REDUCING COUPLING FOR COPPER TUBING (CTS)

The Model C306 Reducing Coupling allows direct reduction on a piping run and eliminates the need for a concentric reducer and couplings. The epoxy coated ductile iron coupling housings help eliminate galvanic

local cell and stray current problems. The specially designed rubber gasket prevents the smaller pipe from telescoping into the larger pipe during vertical installation.



### Pressure-Temperature Rating

Nom. Rating	Working Pressure	Max. Service Temperature
Class 150	300 psi @100°F 20 Bar @38°C	EPDM: 230°F / 110°C

\*Working pressure is for connection with roll-grooved Type K copper tubing.

\*Proof test pressure: 1.5 times the working pressure.

\*Burst pressure: 3 times the listed working pressure, min.

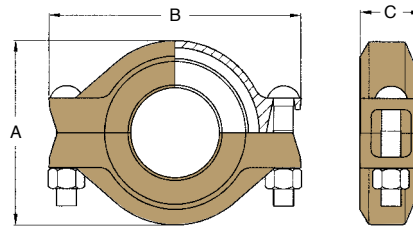

Nominal Size mm / in	Pipe OD mm / in	Max. Working Pressure Bar / PSI	Max. End Load kN / Lbs	Pipe End Separation mm / in	Deflection		Dimensions			Bolt Size in	Weight Kgs / Lbs
					Deg. Per Coupling (°)	Per Pipe mm / m in / ft	A mm / in	B mm / in	C mm / in		
65 x 50 2½ x 2	66.7 x 54.0 2.625 x 2.215	20 300	6.98 1622	1.6 0.06	1° - 22'	24.0 0.29	94 3.70	141 5.55	45 1.77	½ x 3	1.3 2.9
80 x 50 3 x 2	79.4 x 54.0 3.125 x 2.125	20 300	9.89 2300	1.6 0.06	1° - 09'	20.0 0.24	107 4.21	152 5.98	45 1.77	½ x 3	1.5 3.3
80 x 65 3 x 2½	79.4 x 66.7 3.125 x 2.625	20 300	9.89 2300	1.6 0.06	1° - 09'	20.0 0.24	107 4.21	152 5.98	45 1.77	½ x 3	1.4 3.0
100 x 65 4 x 2½	104.8 x 66.7 4.125 x 2.625	20 300	17.23 4007	1.6 0.06	0° - 53'	15.0 0.18	132 5.20	183 7.20	45 1.77	½ x 3	1.9 4.2
100 x 80 4 x 3	104.8 x 79.4 4.125 x 3.125	20 300	17.23 4007	1.6 0.06	0° - 53'	15.0 0.18	132 5.20	183 7.20	45 1.77	½ x 3	1.8 4.0
125 x 100 5 x 4	130.2 x 104.8 5.125 x 4.125	20 300	26.60 6186	1.6 0.06	0° - 42'	12.0 0.15	160 6.30	224 8.82	45 1.77	¾ x 3½	2.5 5.5
150 x 100 6 x 4	155.6 x 104.8 6.125 x 4.125	20 300	37.99 8835	1.6 0.06	0° - 36'	10.3 0.13	185 7.28	251 9.88	45 1.77	¾ x 3½	3.3 7.3

MODEL

# 96 CONTINUITY CLIP

Couplings with rubber gaskets are likely to function as an insulator. Where electrical continuity is required, the Shurjoint continuity clip will restore electrical continuity to the system. The electrical continuity clip satisfies IEE Wiring Regulations. Material: Copper or Brass plate.



Note: The pipe surface where continuity clips come in contact must be conductive. If the surface is painted, the paint should be removed to expose bare metal.

Model	Coupling Size	Box Q'ty/pcs
96-1	1" - 3"	125
96-2	4" - 6"	125
96-3	8" - 12"	100