

WELD CAPS

316L STAINLESS STEEL

- Manufactured in accordance to ASTM A-774 specifications.
- Larger sizes and other gauges are available upon request.
- Dimensions are given in inches.

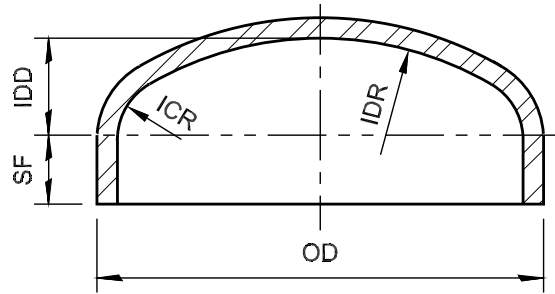

NOMINAL TUBE SIZE	OD	IDD	IDR	ICR	SF	GAUGE	LBS
2	2.000	.516	1.810	.340	.500	12GA	.21
2 1/2	2.500	.640	2.250	.430	.500	12GA	.32
3	3.000	.764	2.690	.510	.500	11GA	.54
4	4.000	1.003	3.520	.670	.500	11GA	.80
6	6.000	1.520	5.310	1.010	.500	10GA	1.90
8	8.000	1.998	6.980	1.330	.750	10GA	3.00
10	10.000	2.505	8.770	1.670	.750	10GA	4.90
12	12.000	3.005	10.500	2.000	.750	10GA	7.40

QUICK CLAMPS

304L STAINLESS STEEL

- Face rings are 316L stainless steel.
- Dimensions are given in inches.

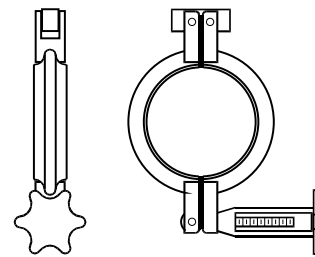

NOMINAL TUBE SIZE	CLAMPS	FACE RINGS				DISC
	LBS	ID	OD	THICKNESS	LBS	LBS
3	2.71	3.020	4.220	10GA	.25	.49
4	2.90	4.020	5.090	10GA	.28	.72
6	3.25	6.020	7.190	10GA	.44	1.43
8	3.64	8.020	9.340	10GA	.64	2.40
10	4.01	10.030	11.250	10GA	.73	3.48
12	4.27	12.030	13.250	10GA	.88	4.83

Felker Stainless Steel Quick Clamps were designed for low pressure service applications. They have been used successfully in food, dairy, paper, chemical and sewage treatment plants for several years. Quick Clamps are used for connecting pipe and fittings or are used with a solid disc for blanking the end of pipe. 1/8" thick neoprene gaskets are furnished with clamps. Two special face rings are required and must be ordered separately per the chart above.