

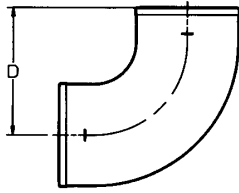

NO-HUB ASA Group 022 BENDS & SWEEPS



QUARTER BEND

Ship Code	UPCode 670610	Size	D	Wt.
S	006848	1½	4¼	1.9
S	006855	2	4½	2.8
S	006862	3	5	4.9
S	006879	4	5½	7.7
S	006886	5	6½	9.7
S	006893	6	7	13.0
S	006909	8	8½	26.2

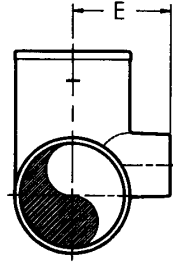

QUARTER BEND w/2" Side Opening

Ship Code	UPCode 670610	Size	D	D'	E	Wt.
S	006923	3	5	4	3¼	4.4
S	006930	4	5½	4 5/16	3¾	7.5

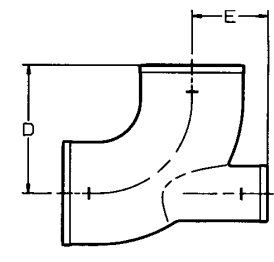
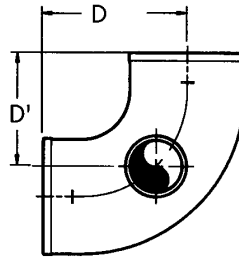

QUARTER BEND w/ 2" Heel Opening

Ship Code	UPCode 670610	Size	D	E	Wt.
S	006947	3	5	2 7/8	4.4
S	006954	4	5½	3¼	6.5

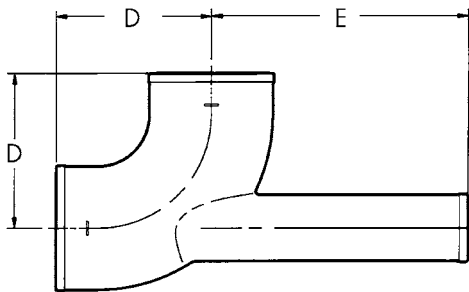

QUARTER BEND EXTENDED LOW HEEL INLET

Ship Code	UPCode 670610	Size	D	E	Wt.
S	011019	3x2	5	10½	7.8

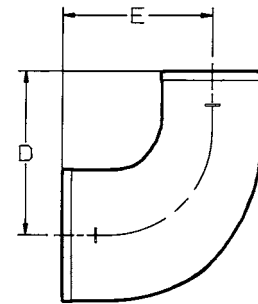

REDUCING QUARTER BEND (FLA. STYLE)

Ship Code	UPCode 670610	Size	D	E	Wt.
S	006916	4x3	5½	5	5.0

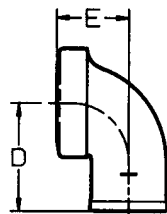

TAP SHORT QUARTER BEND

Ship Code	UPCode 670610	Size	D	E	Wt.
S	006961	1½x1½	3	2	1.5
S	006978	2x1¼	3¼	2¼	1.5
S	006985	2x1½	3¼	2¼	1.5
S	006992	2x2	3¼	2¼	2.6

SHIPPING CODE
S = From Stock
N = Non-Stock; Check in advance for availability.

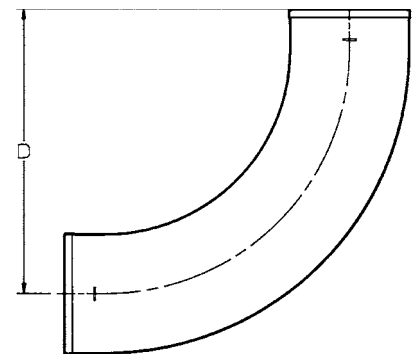

LONG SWEEP

Ship Code	UPCode 670610	Size	D	Wt.
S	007180	1½	9¼	4.1
S	007197	2	9½	6.0
S	007203	3	10	8.5
N	007258	4x3	10½	11.5
S	007210	4	10½	13.4
S	007227	5	11½	17.0
S	007234	6	12	20.9

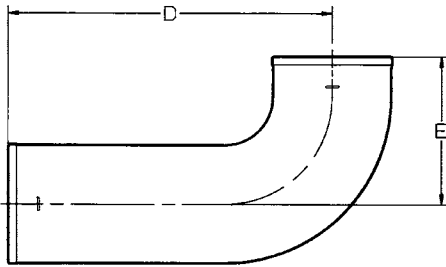

LONG QUARTER BEND

Ship Code	UPCode 670610	Size-Lgth	D	E	Wt.
S	007067	2-12	12	4½	5.0
S	007043	2-14	14	4½	5.6
S	007050	2-16	16	4½	6.3
S	007074	2-18	18	4½	6.7
N	062875	2-24	24	4½	10.7
S	007081	3-12	12	5	7.3
S	007098	3-18	18	5	10.4
S	007104	4-12	12	5½	10.2

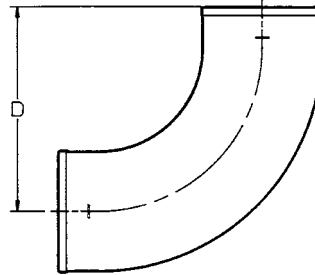

SHORT SWEEP

Ship Code	UPCode 670610	Size	D	Wt.
S	007111	2	6½	4.2
S	007128	3	7	6.2
S	007135	4	7½	9.6
S	007142	5	8½	12.8
S	007159	6	9	15.9
S	007166	8	10½	30.0
S	007173	10	12	55.4
S	376651	12	13¾	70.0
S	376668	15	14¾	130.0

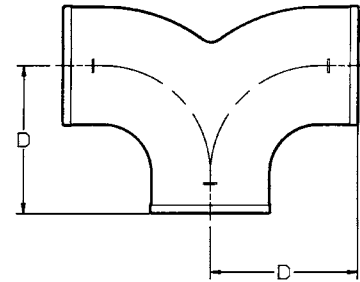

DOUBLE QUARTER BEND

Ship Code	UPCode 670610	Size	D	Wt.
S	007012	2	4½	3.6
S	007029	3	5	6.0
S	007036	4	5½	9.8

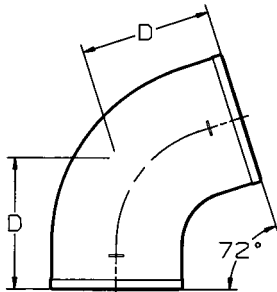

FIFTH BEND

Ship Code	UPCode 670610	Size	D	Wt.
S	007265	2	3 11/16	2.0
S	007272	3	4 1/16	3.5
S	007289	4	4 7/16	5.5

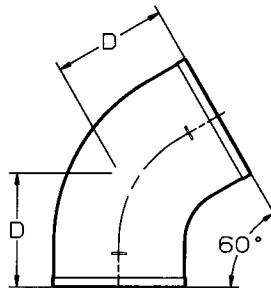

SIXTH BEND

Ship Code	UPCode 670610	Size	D	Wt.
S	007296	2	3 1/2	2.0
S	007302	3	3 1/2	3.0
S	007319	4	3 13/16	5.1

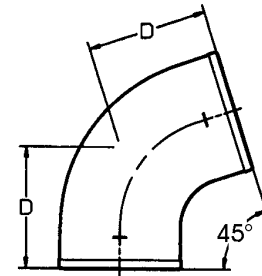

EIGHTH BEND

Ship Code	UPCode 670610	Size	D	Wt.
S	007326	1½	2 5/8	1.1
S	007333	2	2 3/4	2.1
S	007340	3	3	3.3
S	007357	4	3 1/8	4.4
S	007364	5	3 7/8	6.8
S	007371	6	4 1/16	8.5
S	007388	8	5	15.0
S	007395	10	5 15/16	30.7
S	376491	12	6 9/16	39.0
S	376675	15	7 3/16	70.0

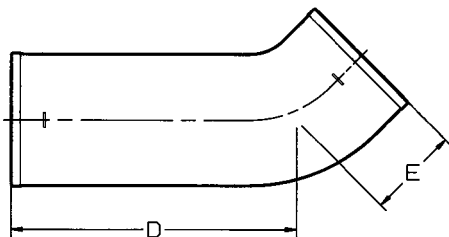

LONG EIGHTH BEND

Ship Code	UPCode 670610	Size - Length	D	E	Wt.
N	382652	2-6	6	3	2.4
S	007401	2-12	12	2¾	4.9
S	007432	2-16	16	2¾	5.9
S	007456	2-18	18	2¾	6.5
S	007425	3-12	12	3	6.9
S	007449	4-12	12	3 1/8	0.4

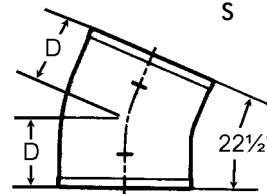

SIXTEENTH BEND

Ship Code	UPCode 670610	Size	D	Wt.
S	007487	1½	2 1/8	1.0
S	007494	2	2 1/8	1.3
S	007500	3	2 1/4	2.4
S	007517	4	2 5/16	3.8
S	007524	5	2 7/8	5.4
S	007531	6	3	7.3
S	007548	8	3 3/4	12.0