



CLEANOUTS

FIG. 4510, 4530 SERIES CLEANOUT TEE W/COUNTERSUNK PLUG AND ROUND ACCESS COVER

FUNCTION: Used in concealed drainage lines where a cleanout is desired. Removable face-of-wall cover allows easy access to closure plug.

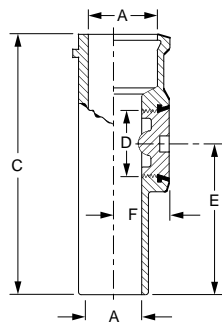

Fig. 4510

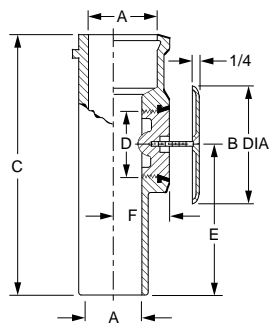

Fig. 4530

OPTIONS:

-LS	6" Long Center Screw	28.00
-LSU	6" Long Vandal Proof Center Screw	85.00
-TH	Plug Tapped 1/4-20 w/T Handle for Plug	78.00
-U	Vandal Proof Screw (1/4-20 X 2 1/2")	58.00
Y	No-Hub Tee (02, 03, 04" only)	N/C

ADD

LESS COVER		A - PIPE SIZE:	02"	03"	04"	05"	06"
4510	Gasket Seal Cast Iron Plug		138.00	172.00	268.00	504.00	763.00
4511	Gasket Seal Bronze Plug		255.00	288.00	385.00	619.00	1,136.00
4512	Taper Thread Bronze Plug		255.00	288.00	385.00	619.00	1,136.00
WITH COVER		COVER MATERIAL	B - COVER SIZE DIA:				
With Cast Iron Plug			4 1/4"	5 1/2"	7"	7"	9 1/4"
4530	Gasket Seal Plug	†Stainless Steel (-SS)	221.00	254.00	372.00	606.00	952.00
		Prime Coated Steel (-PC)	195.00	228.00	346.00	580.00	926.00
		Polished Bronze (-PB)	195.00	228.00	346.00	580.00	926.00
With Bronze Plug							
4531	Gasket Seal Plug	†Stainless Steel (-SS)	338.00	371.00	489.00	725.00	1,325.00
		Prime Coated Steel (-PC)	312.00	345.00	463.00	699.00	1,299.00
		Polished Bronze (-PB)	312.00	345.00	463.00	699.00	1,299.00
With Bronze Plug							
4532	Taper Thread Plug	†Stainless Steel (-SS)	338.00	371.00	489.00	725.00	1,325.00
		Prime Coated Steel (-PC)	312.00	345.00	463.00	699.00	1,299.00
		Polished Bronze (-PB)	312.00	345.00	463.00	699.00	1,299.00
		C	10 1/2"	11 3/4"	12"	*13"	16"
		D SIZE	1 1/2"	2 1/2"	3 1/2"	4 1/2"	6"
		E	6 1/4"	7"	7"	8 1/2"	9"
		F	2"	2 1/2"	3"	4"	4 1/2"

*This Dimension becomes 15" for the 4512 and 4532.

REGULARLY FURNISHED: Duco Cast Iron Cleanout Tee and Countersunk Plug with Stainless Steel Round Cover and Screw as Indicated by Figure Number Selected.

