

# WASHROOM ACCESSORIES

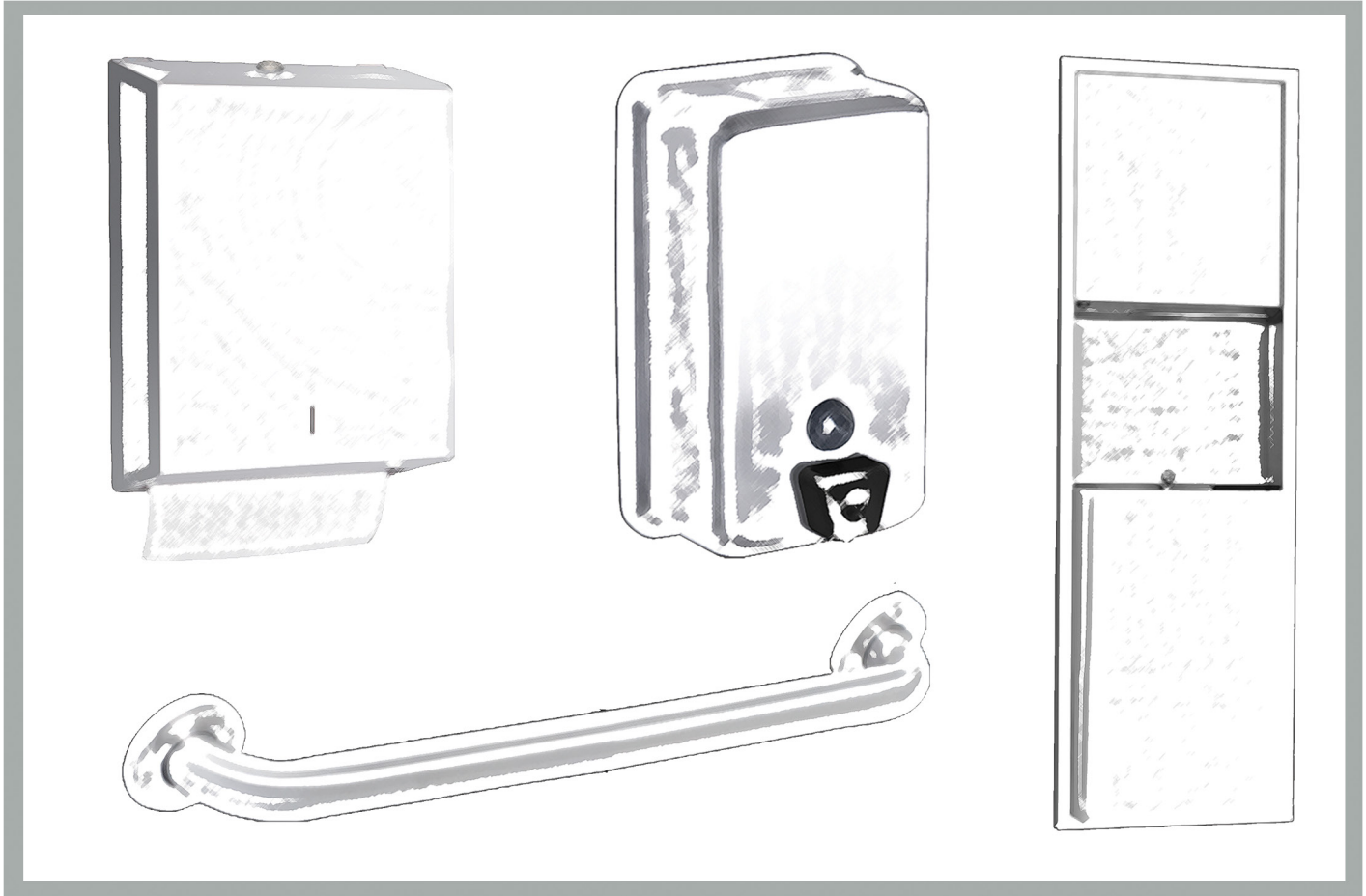

**AMPCO PRODUCTS, LLC**



Florida. Texas. Washington. Tennessee.

TOILET TISSUE DISPENSER



PRODUCT SPECIFICATIONS:

**Body:** Fabricated of type 304 #22 ga stainless steel with #4 satin finish. Concealed inner dispensing mechanism is type 304 #18 ga stainless steel.  
**Back:** fabricated of type 304 #18 ga stainless steel with multiple welds to cabinet body forming a one price construction.  
**Hood:** Fabricated of type 304 #18 ga stainless finish to match cabinet body. Hood is secured with stainless steel hinge rivets to cabinet body. Top roll of tissue will not drop down unless the bottom roll has been depleted. When unit is closed, this will provide a theft resistant, non-control operation and reduce vandalism.  
**Locks:** Pin tumbler, commercial quality locks keyed like all other A & J cabinets.  
**Spindles:** (U005A) Fabricated of one-piece molded high impact black ABS material.  
**Overall Size:** 6"W x 12"H x 6 3/4"D  
 152mm x 305mm x 171mm  
**Capacity:** 2 standard size rolls up to 5 3/4" diameter.  
 \*Sheet capacity may vary from roll to roll depending on the manufacturer and sheet style selected.

TOWEL DISPENSER SURFACE MOUNTED



PRODUCT FEATURES:

**Cabinet:** Type 304 #22 ga stainless steel with #4 satin finish. Striker tabs prevents damage to mounting surface when cover is closed.  
**Cabinet Back:** Type 304 #22 ga stainless steel with embossed towel guides.  
**Hinges:** Full length, heavy duty, stainless steel, piano type hinge. (welded, no rivets)  
**Locks:** Pin tumbler, commercial quality, keyed like all other A & J cabinets.  
**Towel Dispenser:** Area is hemmed to prevent towel tearing and injury.  
 U180: 11"W x 14 1/2"H x 4"D (stainless steel)  
 279mm x 368mm x 102mm  
**Capacity:** 400 C-Fold or 525 Multifold  
 \*Option: TK – Twist lock in lieu of keyed lock.

NAPKIN DISPOSAL SURFACE MOUNTED

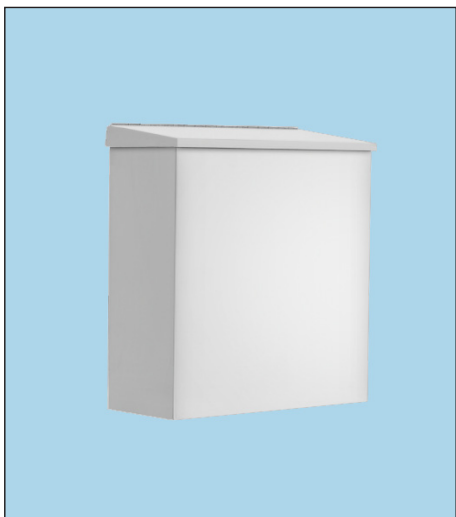

PRODUCT SPECIFICATIONS:

**Cabinet Body:** Type 304 #22 ga stainless steel with #4 satin finish. Seamless construction with radius and hemmed edges.  
**Cabinet Back:** Stainless Steel welded to cabinet body with key hole mounting points.  
**Cover:** Type 304 #22 ga stainless steel #4 satin finish.  
**Hinges:** Heavy duty, full length, stainless steel piano type hinges.  
**Overall Size:** 9"W x 10"H x 4"D  
 229mm x 254mm x 102mm  
**Capacity:** 1.6 gallons

TOWEL DISPENSER/ WASTE RECEPTACLE RECESSED

PRODUCT SPECIFICATIONS:

- Body:** Type 304 #22 ga stainless steel, #4 satin finish.
- Flange:** Type 304 #22 ga stainless steel finished to match cabinet with 1/4" returns. (No miter or welds)
- Cabinet Back:** Type 304 stainless steel formed for rigidity with multiple welds to cabinet body.
- Cabinet Door:** Type 304 #22 ga stainless steel with #4 satin finish.
- Towel Dispenser:** Type 304 #22 ga stainless steel with hemmed edges to prevent injury and towel tearing.
- Removable Waste:** Type 304 #22 ga stainless steel #4 satin finish with all leading edges to have a radius. Unit is secured in place by a bottom bracket guide and top lock.
- Hinge:** Full length, heavy duty, stainless steel piano type hinge.
- Locks:** Pin tumbler commercial quality, keyed like all other A & J cabinets.
- Collars:** Type 304 #22 ga stainless steel, finished to match cabinet. (Used when full recessing cannot be accomplished)



Unit	Depth	Ext. Wst	Mntg	W/O	Capacity
U650	8 1/4"	4"(101)	Rec	4"(101)	12 gal
U650-S2	8 1/4"	4"(101)	S/R	2"(51)	12 gal
U650-SM	8 1/4"	4"(101)	S/M	N/A	12 gal

- Overall Size:** 17 1/4"W x 54"H x 8 1/4"D (wall depth req), 438mm x 1372mm x 108mm
- Wall Opening:** 15 3/4"W x 52 1/2"H, 400mm x 1334mm
- Capacity:** Towels: 600C-Fold or 800 Multifold

TOWEL DISPENSER/ WASTE RECEPTACLE RECESSED  
(ECONOMY SIZE)

PRODUCT SPECIFICATIONS:

- Body:** Type 304 322 ga stainless steel.
- Flange:** Type 304 #22 ga stainless steel with #4 satin finish and 1/4" returns to wall. (No miters or welds)
- Cabinet Back:** Type 304 stainless steel formed for rigidity with multiple welds to cabinet body.
- Cabinet Door:** Type 304 #22 ga stainless steel with #4 satin finish with full length door stop to prevent vandalism
- Towel Dispenser:** Dispensing area has hemmed edges to prevent injury and towel tearing.
- Removable Waste:** Stainless steel removable waste hemmed edges and embossed tabs for liners.
- Hinges:** Heavy duty, full length, stainless steel piano type hinge.
- Lock:** Pin tumbler commercial quality keyed like all other A & J cabinets.
- Collars:** Type 304 #22 ga #4 satin finish stainless steel finished to match cabinet body.
- U626:** Recessed towel dispenser and waste
- Overall Size:** 14 1/4"W x 26"H x 4 1/4"D  
362mm x 660mm x 180mm
- Wall Opening:** 12 3/4"W x 24 1/2"H x 4"D  
324mm x 622mm x 102mm
- Capacity:** Towels: 350 C-Fold or 475 Multifold
- Waste:** 2 gallons (.27 cu ft)
- U626-S2:** Semi-rec with 2" collar, 2" wall open. 51mm
- U626-SM:** Surface mounted with full skirt.
- Optional:** VL3: Reusable vinyl liner.
- \*Option:** TK – Twist lock in lieu of keyed lock.



SANITARY NAPKIN DISPOSAL PART. MTD.

PRODUCT SPECIFICATIONS:

**Body:** Type 304 #22 ga stainless steel, #4 satin finish.  
**Flanges:** Type 304 #22 ga stainless steel, drawn one-piece construction with 1/4" returns to wall surface. One flange is welded to body the other is adjustable to fit 3/4" – 1 1/4" thick partitions. (No miter or welds)  
**Push Panels:** Type 304 #22 ga stainless steel self closing push panel door. \* International graphic symbol optional\*  
**Waste:** Type 304 #22 ga stainless steel removable from one side with pin tumbler type lock securing in place.  
 \*Optional finger grip in lieu of lock\*  
**Locks:** Pin tumbler locks keyed like all other A & J cabinets  
**Hinges:** Full length, heavy duty, stainless steel piano type.  
**Overall Size:** 13"W x 17 1/4"H x 4"D, 330mm x 438mm x 108mm  
**Wall Opening:** 11 1/2"W x 15 3/4"H, 292mm x 400mm  
**Capacity:** 1.5 gallons  
**\*NDL-13-50:** Waxed disposable liners. (50 per Case)  
**U580-PW:** Same as U580 with plastic removable waste.



SOAP DISPENSER 1

PRODUCT SPECIFICATIONS:

**Soap Tank:** Fabricated of type 304 #20 ga stainless steel, #4 satin finish, fully welded one-piece construction.  
**Valve:** All purpose antibacterial soap valve cylinder, black molded plastic push style valve that takes less than 5 lbs of force and one hand to operate complies with barrier free guidelines when mounted at proper height.  
**Viewer:** Clear plastic window allows a constant fluid level check.  
**Concealed Mounting Plate:** Fabricated of heavy gauge stainless steel.  
**Filler Cap:** Fabricated of stainless steel, hinged to allow easy servicing, secured with special key that creates a vandal resistant dispenser.  
**Overall Size:** 4 3/4"W x 8 1/4"H x 3 1/2 (wall to valve), 121mm x 210mm x 127mm  
 Capacity: 40 oz  
 Recommend type soaps without chloric solution for proper operation.  
**Preventative Maintenance:** Each dispenser should be flushed out aprx. Every 30 days with warm to prevent valve from clogging with old soap. Do not use abrasive cleaners to clean dispenser.



SOAP DISPENSER 2

PRODUCT SPECIFICATIONS:

**Soap Tank:** Fabricated of type 304 #20 ga stainless steel, #4 satin finish, fully welded one-piece construction.  
**Valve:** All purpose antibacterial soap valve cylinder, black molded plastic push style valve that takes less than 5 lbs of force and one hand to operate complies with barrier free guidelines when mounted at proper height.  
**Viewer:** Clear plastic window allows a constant fluid level check.  
**Concealed Mounting Plate:** Fabricated of heavy gauge stainless steel.  
**Filler Cap:** Fabricated of stainless steel, hinged to allow easy servicing, secured with special key that creates a vandal resistant dispenser.  
**Overall Size:** 8 1/4"W x 4 3/4"H x 3 1/2"D, 210mm x 121mm x 127mm (Horizontal Mounting)  
**Capacity:** 40 oz.



## CHANNEL FRAMED MIRROR

PRODUCT SPECIFICATIONS:

**Frame:** Fabricated of type 304 #20 ga stainless steel, #4 satin finish. Roll formed 1/2" x 1/2" x 1/2" channel frame has mitered corners and secured with stainless steel rivet.

**Mirror:** Distortion free 1/4" polished plate glass, coated and sealed with uniform electrolytic copper plating, guaranteed against silver spoilage for a period of 15 years.

**Filler:** Full size, 1/8" shock absorbing, water resistant, nonabrasive, polyethylene padding protects all concealed mirror surfaces.

**Back:** #20 ga pre-plated galvanized steel, with embossed horizontal louver mounting brackets. Embossed theft resistant pressure activated clip lock device, locks mirror in place to wall hangers.

**Hangers:** Fabricated of #20 ga pre-plated steel galvanized steel with mounting points.

Mirrors conform to Federal Specifications DD-M-00411b & DD-g-541D.

**Options:**

VC: Safety Glass (Vinyl clad)

T: Tempered Glass

LG: Laminated Glass

PM: Plastic Acrylic

8B: #8 Reflective s/s

**Max Size-8B mirrors:** 72" x 36"

Mirrors are always ordered Width x Height

Fabricated to a tolerance of  $\pm 1/8"$

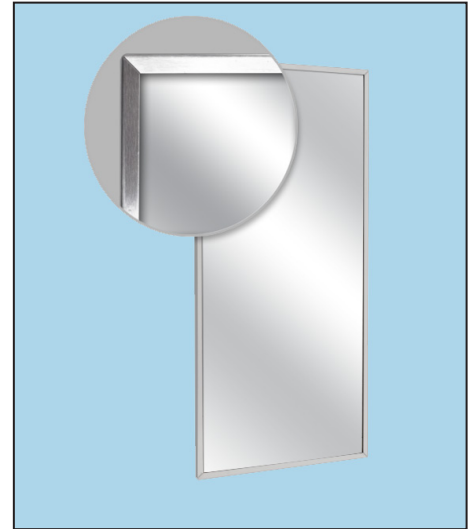

## GRAB BAR

PRODUCT SPECIFICATIONS:

**Tubing:** Fabricated of type 304 #18 g stainless steel with a #4 satin finish. Available in 1 1/2" outside diameter. All bends are formed by an automatic mandrel bending process. All bars maintain a constant 1 1/2" offset.

**Finish:** Standard finish is a #4 satin finish. For a non-stop finish (peened) add suffix X to model number (Ex. UG3X-A)

**Flanges:** Snap flanges are fabricated of 3" diameter, 3/8" deep drawn type 304 #22 ga stainless steel with #4 satin finish to match tubing. Flanges have dimples that secure over mounting plate.

**Strength:** Bars with a 1 1/2" offset clearance will support loads in excess of 900 lbs when properly installed. Bars with greater offsets will support loads up to 250 lbs when properly installed.

**Installation:** Before installing grab bars, verify with all state and local codes requirements on bar diameter and type finish. Recommended mounting heights for grab bars are 33" - 36" centerline above finished floor. All mounting of grab bars when possible should have in wall mounting back plates. Find centerline mounting points and place bar on line making sure to be on center. Transfer mounting points (3 per flange) to wall. Drill pilot holes and secure bar with proper anchors per application. Snap cover mounting plate.

**Standard Lengths:** (Other sizes available upon request): 12", 16", 18", 24", 30", 32", 34", 42", 48", 50", 52", 54", 56"

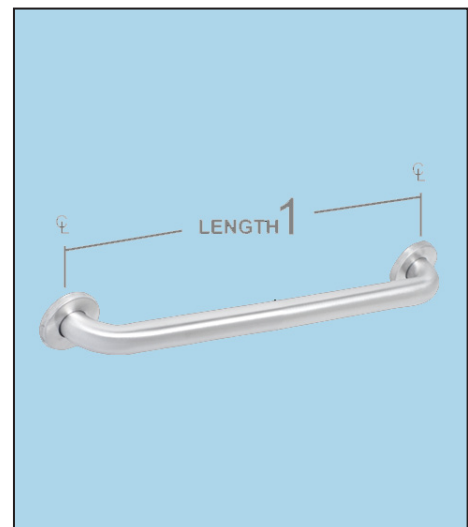

SOAP DISPENSER VANITY MOUNTED

PRODUCT SPECIFICATIONS:

**Piston & Spout:** Highly polished corrosion resistant, type 304 stainless steel. Assembly rotates 360 degrees.

**Flange & Collar:** One piece highly polished chrome on brass.

**Valve Assembly:** All purpose bellows valve, fabricated of ABS material, with stainless steel return spring.

**Shank:** Chrome on brass, secured to collar. Special key provided that unlocks collar for servicing.

**Globe & Collar:** High impact translucent polyethylene.

Unit	Spout	Capacity	Type Finish
U128PC	4" (102)	34 oz.	Polished s/s
U128PCA	6" (152)	34 oz.	Polished s/s

Recommend type soaps without chloric solution for proper operation.  
Preventative Maintenance: Each dispenser should be flushed out aprx. Every 30 days with warm water to prevent supply tube and spout from clogging with old soap. Do not use abrasive cleaners to clean unit.

\*All vanity soap dispensers are designed to be serviced above the counter.



SEAT COVER DISPENSER SURFACE MOUNTED

PRODUCT SPECIFICATIONS:

**Dispenser:** Unit is fabricates type 304 #22 gauge stainless steel with a #4 satin finish. Beveled edge around the dispensing areas ensures a clean dispensing area that prevents product from tearing and injury. Loading of product is accomplished from below without having to open any locking mechanism or access panel. Hat style mounting brackets provides added rigidity for body and acts as a support for the packing.

**Overall sizes:** 15 3/4" w x 11"H x 1 3/4"D

**Capacity:** 500 single fold or 500 half fold covers.

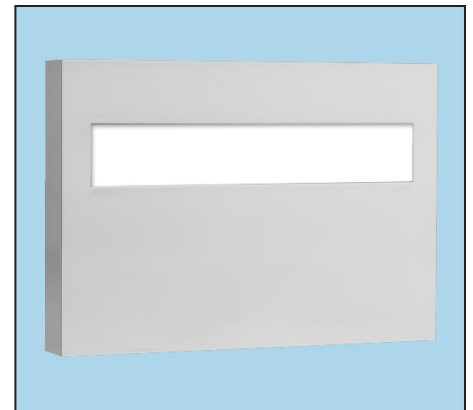

DRAWINGS

TOILET TISSUE DISPENSER

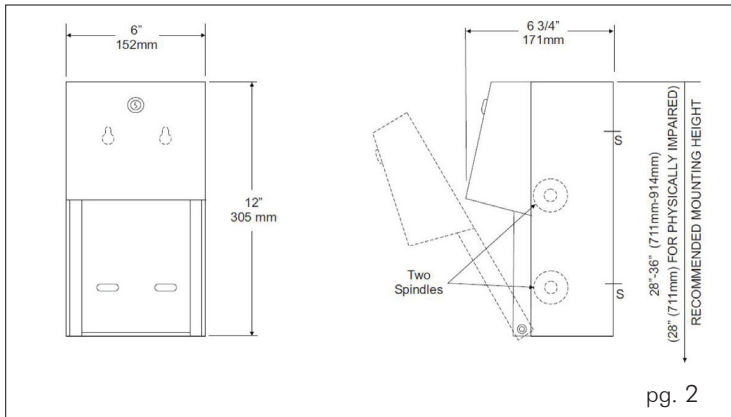

TOWEL DISPENSER SURFACE MOUNTED

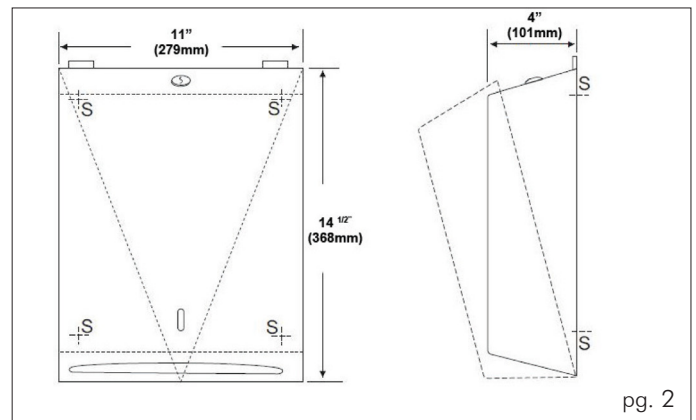

NAPKIN DISPOSAL SURFACE MOUNTED

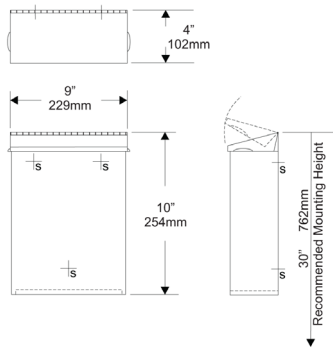

pg. 2

TOILET DISPENSER/ WASTE RECEPTACLE RECESSED

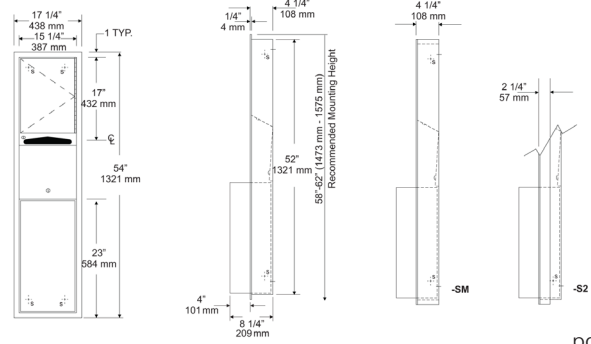

pg. 3

TOILET DISPENSER/ WASTE RECEPTACLE RECESSED (Economy Size)

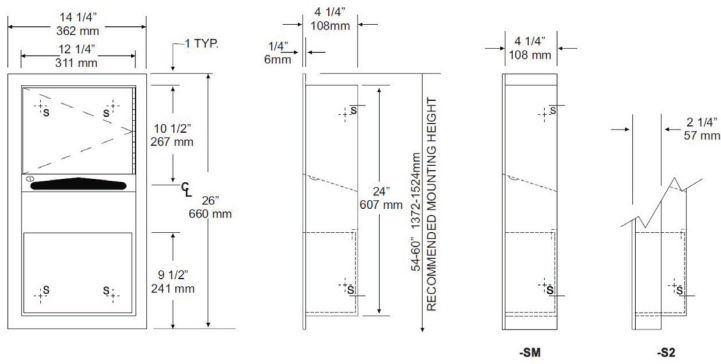

pg. 3

SANITARY NAPKIN DISPOSAL PART. MTD.

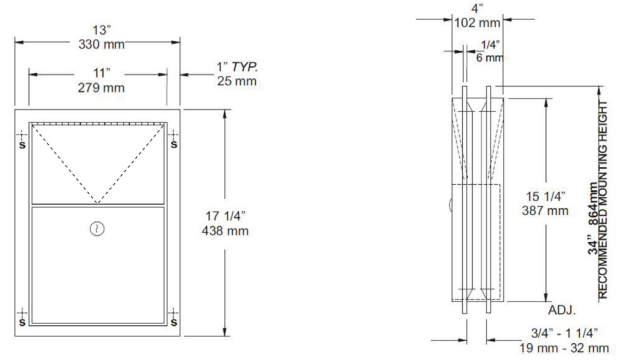

pg. 4

SOAP DISPENSER 1

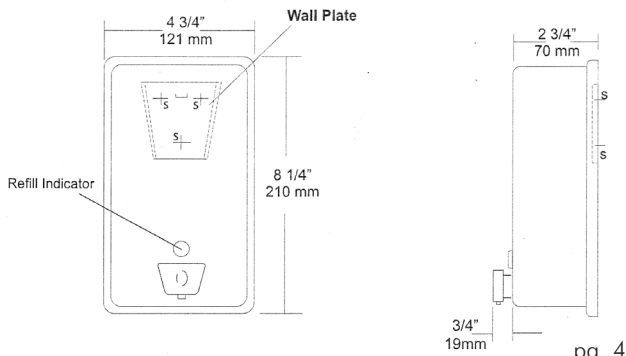

pg. 4

SOAP DISPENSER 2

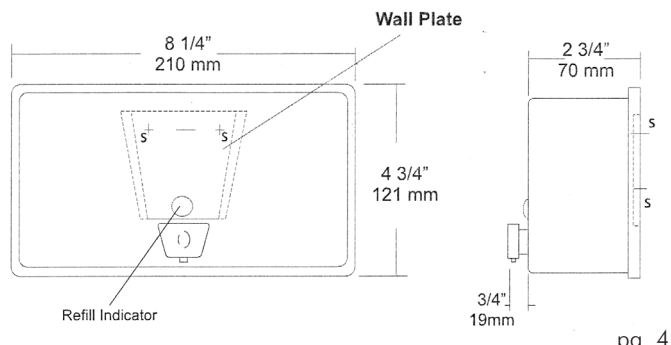

pg. 4

CHANNEL FRAMED MIRROR

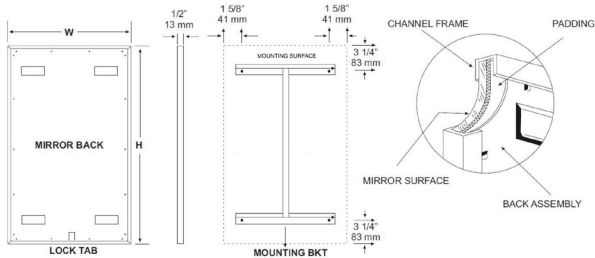

pg. 5

GRAB BAR

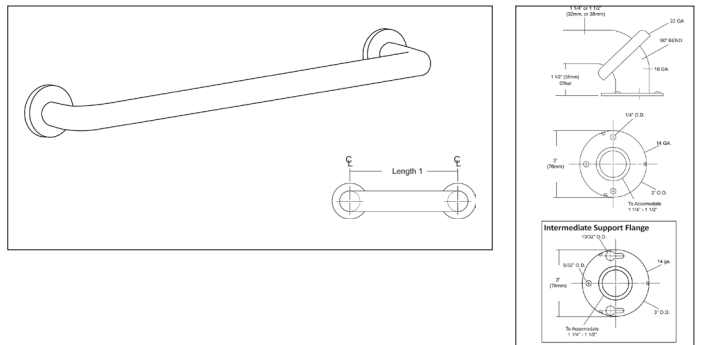

pg. 5

DRAWINGS

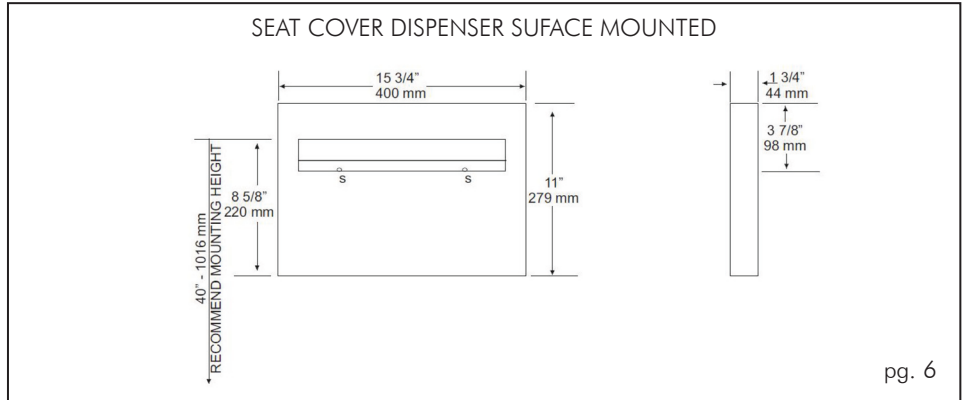
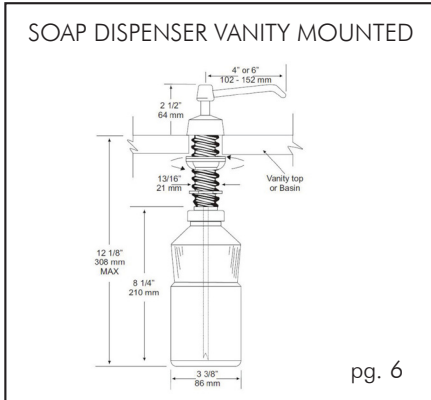

FLORIDA

11400 NW 36th Avenue, Miami  
 Florida 33167  
 P. 305/821-5700 F. 866/216-5300  
 email: florida@ampco.com

TEXAS

201 Railroad Avenue, Sanger  
 Texas 76266  
 P. 940/458-7401 F. 866/372-5300  
 email: texas@ampco.com

TENNESSEE

1200 Violet Street, Morristown  
 Tennessee 37814  
 P. 423/586-3993 F. 866/902-5370  
 email: tennessee@ampco.com

WASHINGTON

4520 B Street NW, Suite B, Auburn  
 Washington 98001  
 P. 253/852-5900 F. 866/323-5300  
 email: washington@ampco.com

AMPCO PRODUCTS LLC

AMPCO has been manufacturing doors and frames since 1961. A network of national and international distributors market AMPCO's family of products.

AMPCO manufactures a wide variety of products to meet the needs of contractors, architects, distributors and builders. Products include wood doors, plastic laminate doors, aluminum adjustable door frames, pre-hung doors and frames, toilet partitions in baked enamel, high pressure laminate, stainless steel, solid surface, phenolic core, solid surface veneer and solid plastic.

AMPCO Products LLC  
 Manufacturers of Restroom Compartments and Door/ Frame Systems which are available through a network of distributors.

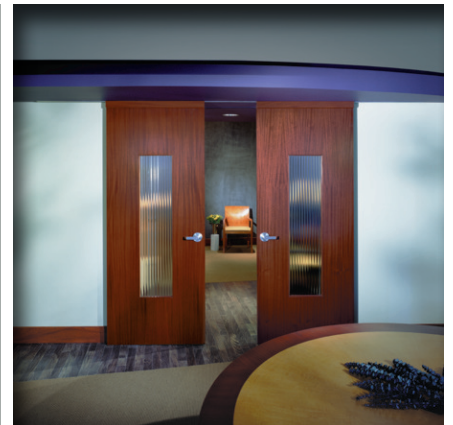

Architectural Flush Wood Doors

Call or Fax for full color catalog of AMPCO products or visit [www.ampco.com](http://www.ampco.com). See us in Sweets.