

ANVILETS

Universal Forged Steel Anvilets

Standard & Extra Strong Socket-Weld

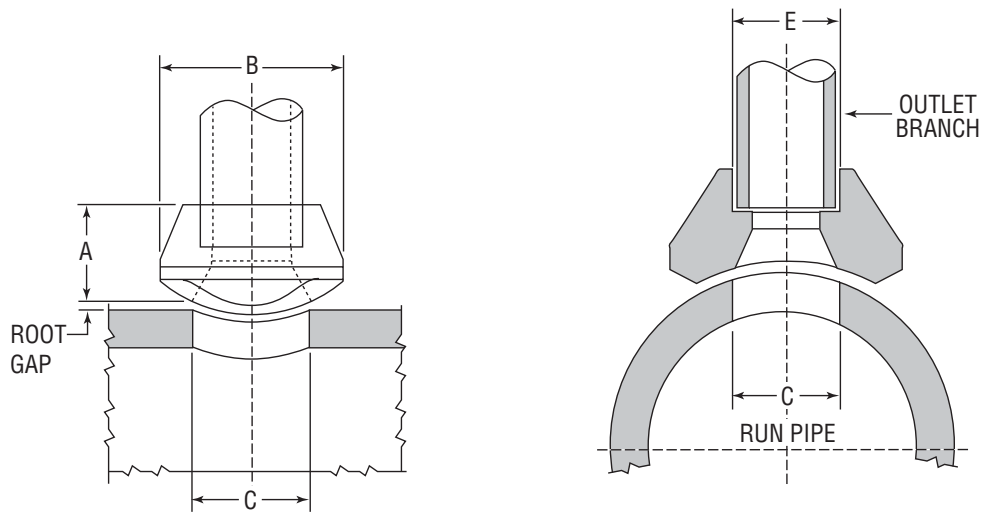

SOCKET-WELD Class 3000



Outlet Size	Dimensions							Unit Weight		
	A		B		C		E		lbs	kg
NPS DN	in	mm	in	mm	in	mm	in	mm		
1/8 6	3/4	19	1	25	0.625	16	9/32	7	0.10	0.05
1/4 8	3/4	19	1	25	0.364	9	3/8	10	0.14	0.06
3/8 10	13/16	21	1 1/16	27	0.493	13	7/16	11	0.14	0.06
1/2 15	1	25	1 15/32	37	0.622	16	9/16	14	0.28	0.13
3/4 20	1 1/16	27	1 45/64	43	0.824	21	9/16	14	0.39	0.18
1 25	1 5/16	33	2 3/32	53	1.049	27	25/32	20	0.73	0.33
1 1/4 32	1 5/16	33	2 17/32	64	1.380	35	23/32	18	0.96	0.44
1 1/2 40	1 3/8	35	2 25/32	71	1.610	41	3/4	19	1.12	0.51
2 50	1 1/2	38	3 5/16	84	2.067	53	13/16	21	1.66	0.75
2 1/2 65	1 13/16	46	3 29/32	99	2.469	63	3/4	19	2.73	1.24
3 80	2	51	4 21/32	118	3.068	78	15/16	24	3.88	1.76
4 100	2 1/4	57	5 13/16	148	4.026	102	1 1/16	27	6.60	2.99

SOCKET-WELD Class 6000



Outlet Size	Dimensions							Unit Weight		
	A		B		C		E		lbs	kg
NPS DN	in	mm	in	mm	in	mm	in	mm		
1/2 15	1 1/4	32	1 3/4	44	0.464	12	1 3/16	21	0.28	0.13
3/4 20	1 7/16	37	2 1/16	52	0.612	16	1 5/16	24	0.39	0.18
1 25	1 5/16	40	2 17/32	64	0.815	21	1 1/32	26	0.73	0.33
1 1/4 32	1 5/8	41	2 1/2	64	1.160	29	1 1/32	26	0.96	0.44
1 1/2 40	1 11/16	43	3 5/16	84	1.338	34	1 1/16	27	1.63	0.74
2 50	2 1/16	52	3 31/32	101	1.687	43	1 3/8	35	1.66	0.75

Each outlet size listed is available to fit any run curvature. Socket dimensions are in accordance with ASME B16.11. Design per MSS-SP-97.

RUN PIPE SIZES Outlet sizes noted above fit a number of run pipe sizes, and the fittings are marked accordingly. See page 121 for run pipe size combination table(s).

FLATS A flat Socket-welded Universal Forged Steel Anvillet for use on welding caps, elliptical heads and flat surfaces is available.

The A, B and C dimensions given for the Branch Connections in the above Table are for reference only and to be used as a guideline. Dimensions B and C are subject to change depending upon the manufacturing process utilized. Although every attempt has been made to insure that the information contained in this table is correct, Anvil reserves the right to change the C dimension as deemed necessary.