

HIGHlite Cine 330 3D HC

3,000 ANSI Lumens | Contrast Ratio: 20,000:1 (Dynamic Black) | Part No:113-123



| | |
|--|--|
| Colour System: 3-chip DLP® | DMD Specification: 1920 x 1080 pixels native. Fast transit pixels for smooth greyscale and improved contrast. |
| Display Type: 3 x 0.65" DarkChip™ DMD™ | Aspect Ratio: 16x9 Fill Factor 87% |

Key Features

Video & Graphics Processing

- HDMI 1.4 for Side by Side, Frame Packing & Top Bottom Formats.
- Dual Flash Processing can be used to multiply the displayed frame rate for 3D sources (example 144Hz display).
- Dual Pipe Processing: Two sources in parallel for Left and Right Eyes.
- Synchronisation of active glasses or polarising switcher.
- High Bandwidth Digital & Analogue Receiver with 10 Bit A-D.
- 24p and 1080p native display.
- DynamicBlack™ for improved black levels in dark scenes.
- The projector automatically detects interlaced video and implements 3:2 or 2:2 extraction as appropriate, with pixel based, motion adaptive interpolation and auto cadence correction.
- Image enhancement for MPEG, Mosquito noise & Colour Transients in composite sources.

Source Compatibility:

HDMI including Deep Color™ processing and 3D standards.
Graphics standards up to 1920 x 1200 resolution at 60Hz via HDMI or VGA.
Component Video (SD and HD) via YPrPb and RGB.

Inputs/Outputs

| Video & Computer | | | Communication & Control | | |
|------------------|--------------|-----|-------------------------|-------------------|-----|
| Type | Connector | Qty | Type | Connector | Qty |
| HDMI 1.4 | HDMI | 2 | 3D Sync Out | BNC | 1 |
| VGA / Analog RGB | 15-pin D-Sub | 1 | 3D Sync In | BNC | 1 |
| Component Video | 3 x RCA | 1 | LAN | RJ45 | 1 |
| Component Video | 3 x BNC | 1 | RS232 | 9-pin D Sub | 1 |
| | | | IR Input | 3.5mm Stereo Jack | 1 |
| | | | 12V Trigger | 3.5mm Stereo Jack | 2 |
| | | | Service Port | USB Type A | 1 |

3D Formats Supported

Frame Packing
 Dual Pipe
 Frame Sequential
 Side By Side (half)
 Top and Bottom

HDTV Formats Supported

1080p (24Hz, 25Hz, 30Hz, 50Hz, 60Hz), 1080i (50Hz, 60Hz), 720p (50, 60Hz)

Computer Compatibility

Up to 1920 x 1200

Bandwidth

200 MHz on analog RGB
 165 Megapixels per second on HDMI

Remote Control

IR Remote Control
 On-Board keypad

Automation Control

RS232
 LAN

Colour Temperature

User selectable from 5500 to 9300K

Lamp Type

1 x 330W High Intensity Discharge

Typical Lamp Life

Full Power: 2000 hours

Lenses

| Lens | Part No. | Focus Range | Lens Shift |
|-------------------------|----------|--------------|---|
| 0.77 : 1 fixed HC | 110-022 | 1.3m - 2.5m | Vert: 0.2 (U) 0.2 (D) frame, Hor: 0.05 (L) 0.05 (R) frame |
| 1.16 : 1 fixed HC | 110-023 | 1.4m - 6.2m | Vert: 0.2 (U) 0.2 (D) frame, Hor: 0.05 (L) 0.05 (R) frame |
| 1.45 - 1.74 : 1 zoom HC | 110-017 | 1.8m - 9.3m | Vert: 0.6 (U) 0.6 (D) frame, Hor: 0.15 (L) 0.15 (R) frame |
| 1.74 - 2.17 : 1 zoom HC | 112-877 | 2.2m - 11.8m | Vert: 0.6 (U) 0.6 (D) frame, Hor: 0.15 (L) 0.15 (R) frame |
| 2.17 - 2.90 : 1 zoom HC | 113-851 | 2.7m - 15.4m | Vert: 0.6 (U) 0.6 (D) frame, Hor: 0.15 (L) 0.15 (R) frame |
| 2.90 - 4.34 : 1 zoom HC | 110-020 | 3.6m - 22.5m | Vert: 0.6 (U) 0.6 (D) frame, Hor: 0.15 (L) 0.15 (R) frame |
| 4.34 - 6.76 : 1 zoom HC | 110-021 | 5.5m - 35m | Vert: 0.6 (U) 0.6 (D) frame, Hor: 0.15 (L) 0.15 (R) frame |

Lens Mount

Motorised shift, zoom and focus.

Mechanical Mounting

Front/Rear Table
 Front/Rear Ceiling
 Adjustable Front/Rear Feet

Orientation

Table Top or Inverted: Yes
Pointing Up: +/-8° from horizontal
Pointing Down: +/-8° from horizontal
Roll (Portrait): No

Power Requirements

100-240VAC 50/60Hz single phase

Power Consumption

480W

Thermal Dissipation

1638 BTU/Hour

Fan Noise

35dBA, Eco 33dBA

Operating/Storage Temperature

Operating: 0 to 40C (32 to 104F)
 Storage: -20 to 60C (-4 to 140F)

Operating Humidity

20% to 90% non-condensing

Weight (Chassis Only)

20 kg
 44.1 lb

Dimensions

L: 51.2 cm W: 49.9 cm H: 21.9 cm
 L: 20.2 in W: 19.6 in H: 8.6 in

Safety & EMC Regulations

CE, FCC Class A, UL, CCC

**Dimensions included for reference only and are subject to change. Please download the full set of CAD files for this display for more accurate information.*

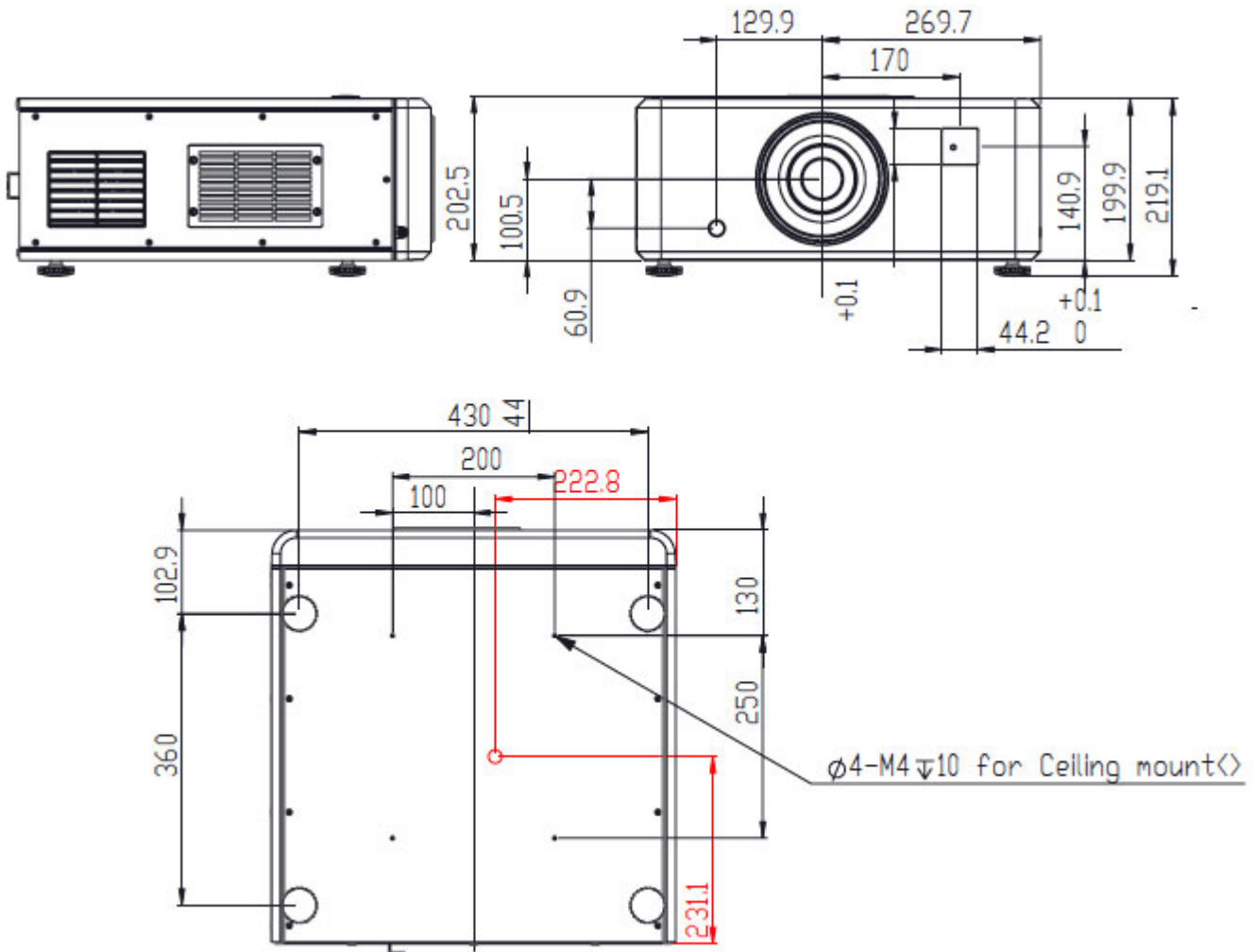

Downloads

[PDF CAD Drawings](#)

[User Guides](#)

[AUTOCAD Drawings](#)

[Important Information](#)

Specifications subject to change without notice. Digital Projection version: 1.1 - 24-Jan-13 ©2012 Digital Projection.
DLP®, Digital Light Processing™ and DMD are trademarks of Texas Instruments, Inc

DIGITAL PROJECTION, INC 55 CHASTAIN ROAD, SUITE 115 KENNESAW, GA. 30144
T: 770.420.1350 | F: 770.420.1360 | www.digitalprojection.com

DIGITAL PROJECTION, LTD GREENSIDE WAY, MIDDLETON MANCHESTER, UK. M24 1XX
T: +44.161.947.3300 | F: +44.161.684.7674 | www.digitalprojection.co.uk

DIGITAL PROJECTION, CHINA TOWER C, RM C1202, CAI FU JIA YUAN, NO. 19 XIAO YING STREET, CHAOYANG DISTRICT BEIJING, PR CHINA 100101
T: +86.10.58239771 | F: +86 10 58239770

DIGITAL PROJECTION, ASIA 16 NEW INDUSTRIAL ROAD, #02-10 HUDSON TECHNOCENTRE SINGAPORE 536204
T: +65.6284.1138 | F: +65.6284.1238