

FLAT PLATE

DATA:
1/4" thick, 1 5/8" wide, holes 9/16" dia.,
spaced 1 7/8" on center & 1 3/16" from end.

FINISH: Electro-Galvanized

F-204
SPLICE PLATE

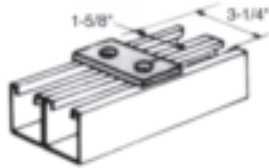

F-211
THREE HOLE CORNER
CONNECTOR

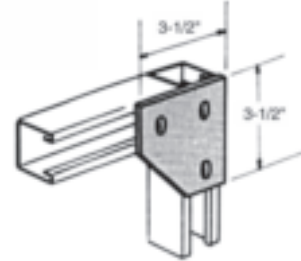

F-217
FOUR HOLE
CONNECTOR

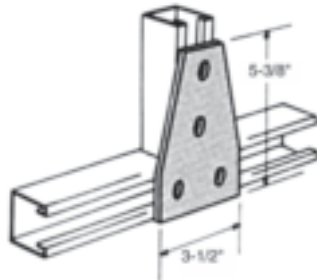

F-218
FOUR HOLE
CORNER CONNECTOR

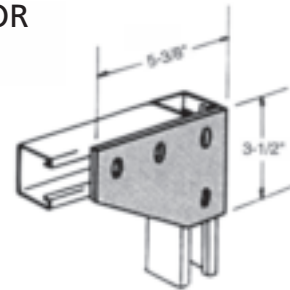

F-219
FIVE HOLE
CONNECTOR

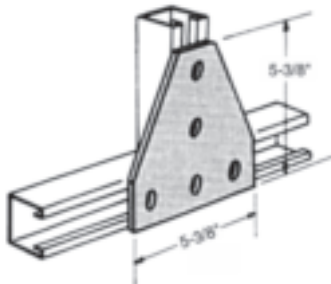

F-220
SEVEN HOLE
CONNECTOR

