

MULTI-STRUT®

ANGLE BRACKETS

DATA:
 1/4" thick, 1 5/8" wide, holes 9/16" dia.,
 spaced 1 7/8" on center & 1 3/16" from end.

FINISH: Electro-Galvanized

A-301
 TWO HOLE
 CORNER ANGLE

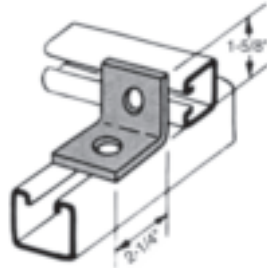

A-302
 CONNECTION
 ANGLE

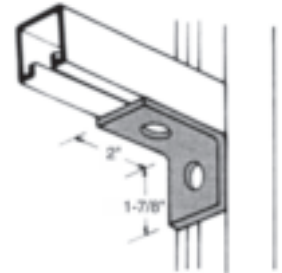

A-303
 NO-TWIST
 CORNER ANGLE
 (1 indent)

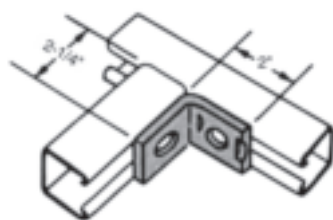

A-304
 NO-TWIST
 CORNER ANGLE
 (2 indents)

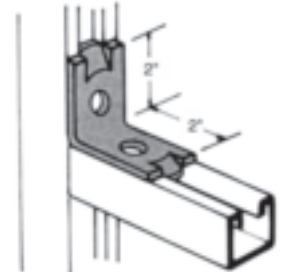

A-305
 THREE HOLE 90°
 BRACKET

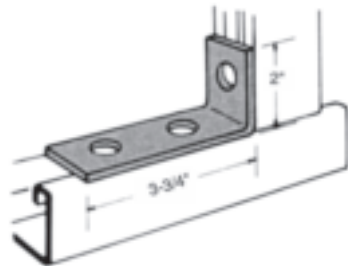

A-306
 THREE HOLE CORNER
 CONNECTOR

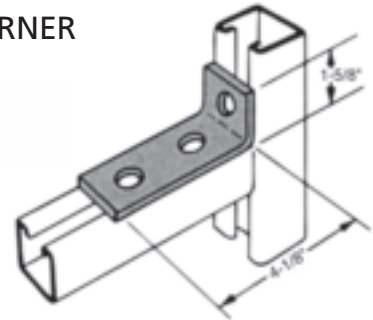

A-309
 FOUR HOLE JOINT
 CONNECTOR
 ANGLE

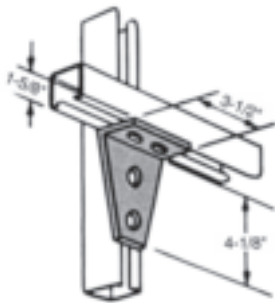

A-310
 FOUR HOLE
 DUPLEX CORNER
 ANGLE

