

# UNIVERSAL STYLE STEAM TRAPS

## WD600LSM-HP

High-Pressure Thermodynamic Steam Trap Module (mounts to Universal Connectors)

Model	<b>WD600LSM-HP</b> (Side Mount Style)
Connections	<b>Fits WU450 Series Universal Connectors</b>
Body Material	<b>Stainless Steel</b>
PMO Max. Operating Pressure	<b>600 PSIG</b>
TMO Max. Operating Temperature	<b>750°F</b>
PMA Max. Allowable Pressure	<b>720 PSIG @ 100°F</b>
TMA Max. Allowable Temperature	<b>800°F @ 600 PSIG</b>



**WD600LSM-HP**  
**HIGH PRESSURE**  
**Thermodynamic**  
**Steam Trap Module**  
(Side Mount Style)

Units: Inches

Steam trap modules can be used with other manufacturers' Universal Connectors.

### TYPICAL APPLICATIONS

**DRIP, TRACER:** The **WD600LSM-HP** steam trap module mounted to a universal connector can be used anywhere conventional thermodynamic steam traps are used. Used on drip, tracing and light process applications where removal of air is not critical. The **WD600LSM-HP** trap module mounts to any Universal Connector.

### HOW IT WORKS

The universal connector is permanently installed into the pipeline where the steam trap would normally be placed. The trap module is bolted to the universal connector with two bolts and sealed with two gaskets. When a new trap module is needed, it can be easily removed and replaced with a standard open-end or socket wrench without disturbing the existing piping.

### FEATURES

- Trap module can be easily removed and replaced in minutes without having to disconnect any piping
- Trap modules can be used with most manufacturers' 2-bolt universal connector
- All stainless steel construction with hardened seat

### SAMPLE SPECIFICATION

The steam trap module shall be designed to attach to the industry standard two-bolt universal connector. Trap module shall be of a thermodynamic design. Universal connector shall conform to the two bolt industry standard with integral strainer and blowdown options.

Model	CAPACITIES – Condensate (lbs/hr)					
	Differential Pressure (PSI)					
	150	200	250	300	450	600
<b>WD600LSM-HP</b>	465	500	550	600	675	730

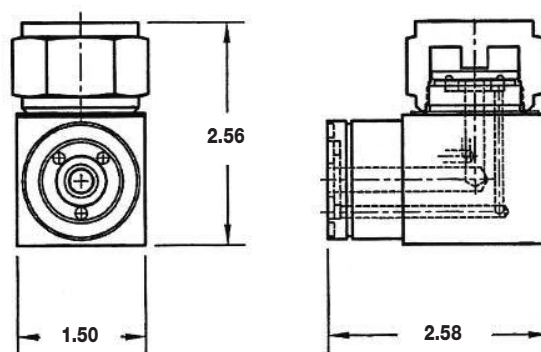

**WD600LSM-HP Thermodynamic**  
**Steam Trap Module**

### INSTALLATION

Isolation valves should be installed before and after the universal connector to facilitate maintenance. Trap module is attached to the connector using two bolts and two sealing gaskets.

### MAINTENANCE

If the trap fails for any reason, replace only the trap module. If universal connector is equipped with an integral strainer it should be cleaned periodically. For full maintenance details see Installation and Maintenance Manual.

### OPTIONS

Universal Connectors are available with an integral strainer and blowdown valve. Connector is purchased separately. See the Universal Connectors section for more information.

### MATERIALS

Body	Stainless Steel, AISI 420
Disc	Stainless Steel, AISI 420
Cap	Stainless Steel, AISI 416
Insulation Cover	Stainless Steel, AISI 304
Bolts	Steel, ASTM A193 GR B7
Gaskets (2)	Spiral Wound 304 Stainless Steel with Grafoil Filler