

J Series Filters

HIGH PRESSURE FILTERS

J Series Filters provide filtration of particulates in gas and liquid systems prior to pressure or flow control components. J Series Filters utilize a pleated, 10 micron filter in 304 Stainless Steel for maximum contaminant control. Cleanable and replaceable elements provide long life and reduced operating costs.

**J88 Mini In-Line
(Replaceable Filter)**



J85 Tee-Type



J82 Mini In-Line



J83 In-Line

Features:

- 303 stainless steel body construction with pleated stainless steel 10 micron filter.
- Consult factory for other material options.
- Operating pressure from 3,000 psig (207 bar) to 10,000 psig (690 bar).
- Cleanable and replaceable filter elements provide long life and reduced operating costs.
- Protects your pressure and flow control components from particulate contamination in gas and liquid service.

J82 MINI IN-LINE SERIES

Maximum Rated Optimum Pressure:

3,000 - 6,000 psig / 207 - 414 bar

Design Maximum Proof Pressure :

4,500 - 9,000 psig / 311 - 621 bar

Materials of Construction:

- Body: 303 Stainless Steel (others available)
- 10 Micron Filter: 304 Stainless Steel

End Connections:

Female and Male NPT 1/4" to 1/2"

Operating Temperature:

-320 °F to 550 °F / -196 °C to 288 °C

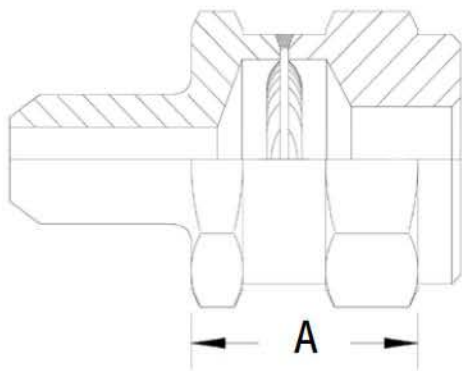

Part Number	Dimensions A
J82-T-2FM	1.185" (30)
J82-U-3FM	1.185" (30)
J82-U-4FM	1.685" (42,8)
J82-T-2FF	1.562" (39,7)
J82-U-3FF	1.562" (39,7)
J82-U-4FF	1.93" (49)

**Typical Flow Curve - Air
J82 (10 Micron Nominal)
100 PSID**

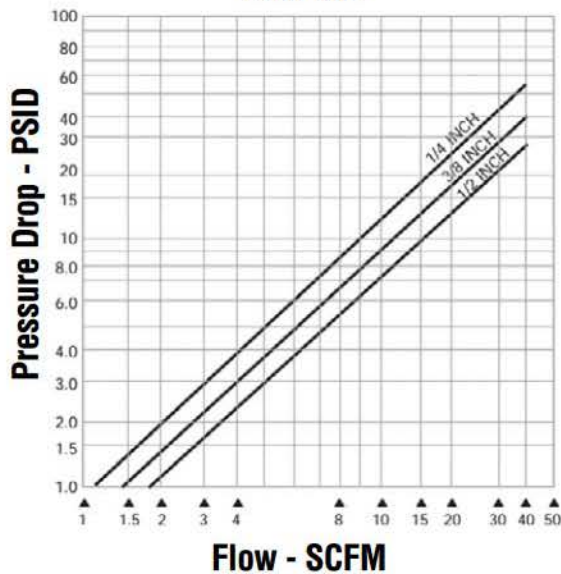

**Typical Flow Curve - Oil
J82 (10 Micron Nominal)
100 Saubolt Second Unit**

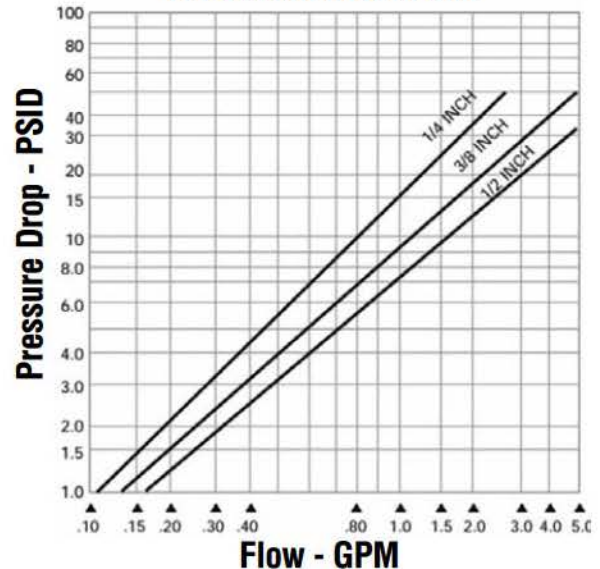

J88 MINI IN-LINE SERIES (REPLACEABLE FILTER)

Maximum Rated Optimum Pressure:

6,000 psig / 414 bar

Design Maximum Proof Pressure :

9,000 psig / 621 bar

Materials of Construction:

- Body: 303 Stainless Steel (others available)
- 10 Micron Filter: 304 Stainless Steel

End Connections:

Female and Male NPT 1/4" to 1/2"

Operating Temperature:

-320 °F to 550 °F / -196 °C to 288 °C

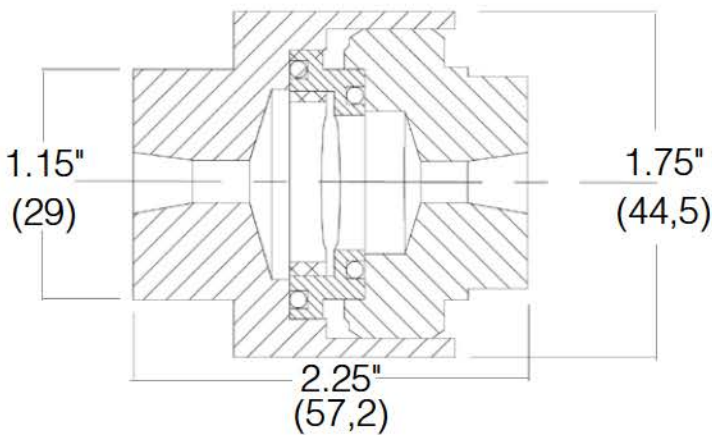

Replaceable Element	
Size	Part Number
ALL	J88-10WN

**Typical Flow Curve - Air
J88 (10 Micron Nominal)
100 PSID**

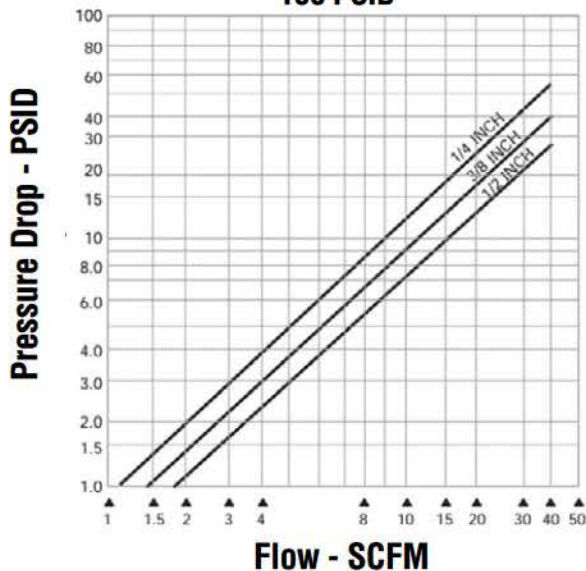

**Typical Flow Curve - Oil
J88 (10 Micron Nominal)
100 Saubolt Second Unit**

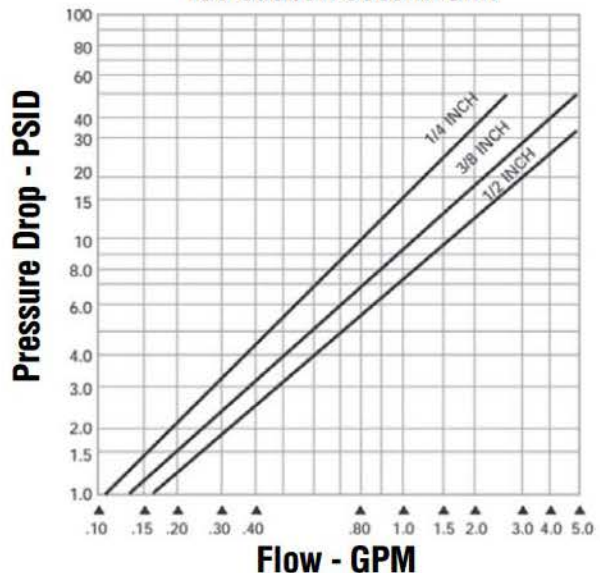

J83 IN-LINE SERIES

Maximum Rated Optimum Pressure:

3,000 - 10,000 psig / 207 - 690 bar

Design Maximum Proof Pressure :

4,500 - 15,000 psig / 310 - 1034 bar

Materials of Construction:

- Body
 - 3,000 psig/207 bar : 303 Stainless Steel (others available)
 - 6,000 and 10,000 psig / 414 and 690 bar : 17-4 Stainless Steel (others available)
- 10 Micron Filter: 304 Stainless Steel
- O-Rings: Buna, PTFE, Viton

End Connections:

Female NPT 1/4" to 1"

Operating Temperature:

- Buna o-ring: -40 °F to 250 °F / -40 °C to 121 °C
- TEV o-ring: -4 °F to 400 °F / -20 °C to 204 °C
- Viton o-ring: -20 °F to 400 °F / -29 °C to 204 °C



PART NUMBER	DIMENSION A INCHES (MM)	DIMENSION B INCHES (MM)	REPLACEMENT ELEMENT	REPLACEMENT O-RING
J83-U-2FF	6.00" (152)	1.75" (44)	J83-713-	B - Buna
J83-U-3FF	6.00" (152)	1.75" (44)	J83-713-	T - TEV
J83-U-4FF	7.75" (197)	2.25" (57)	J83-715-	V - Viton
J83-U-5FF	8.75" (222)	2.5" (64)	J83-716-	
J83-U-6FF	9.25" (235)	2.5" (64)	J83-716-	
J83-T-2FF	6.00" (152)	1.75" (44)	J83-713-	
J83-T-3FF	6.00" (152)	1.75" (44)	J83-713-	
J83-T-4FF	7.75" (197)	2.25" (57)	J83-715-	
J83-T-5FF	8.75" (222)	2.5" (64)	J83-716-	
J83-T-6FF	9.25" (235)	2.5" (64)	J83-716-	
J83-S-2FF	5.62" (143)	1.75" (44)	J83-711-	
				Example: J83-711-B

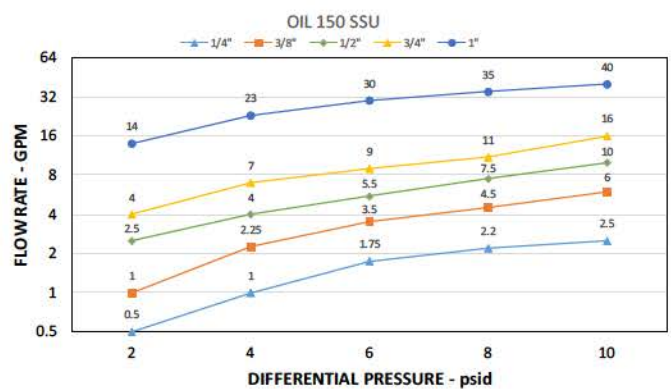
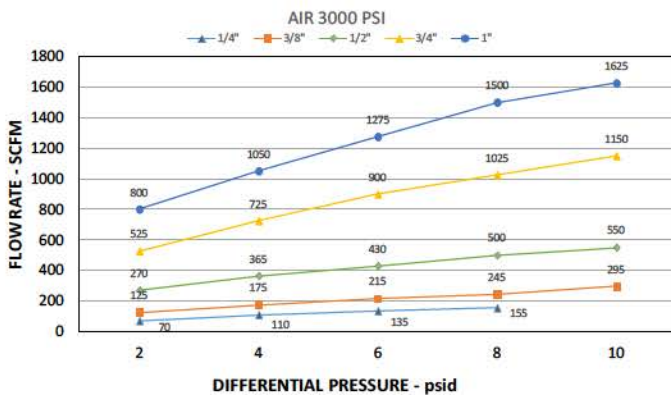
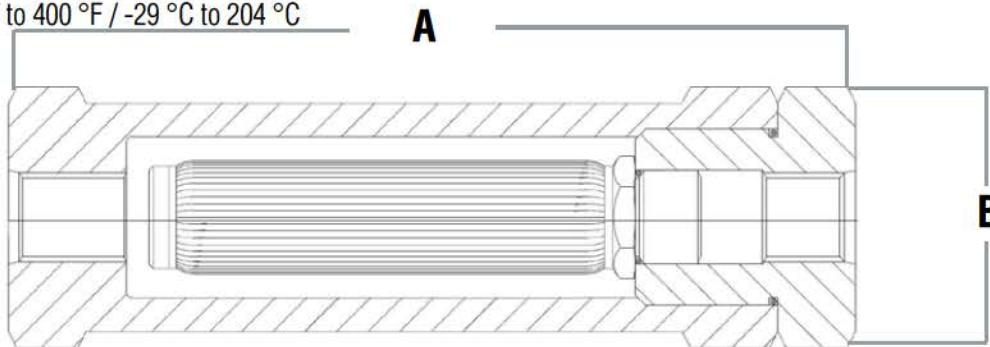

J85 TEE-TYPE SERIES

Maximum Rated Optimum Pressure:

6,000 psig / 414 bar

Design Maximum Proof Pressure :

9,000 psig / 621 bar

Materials of Construction:

- Body: 303 Stainless Steel (others available)
- 10 Micron Filter: 304 Stainless Steel

End Connections:

Female and Male NPT 1/4" to 1/2"

Operating Temperature:

- Buna o-ring: -40 °F to 250 °F / -40 °C to 121 °C
- TEV o-ring: -4 °F to 400 °F / -20 °C to 204 °C
- Viton o-ring: -20 °F to 400 °F / -29 °C to 204 °C

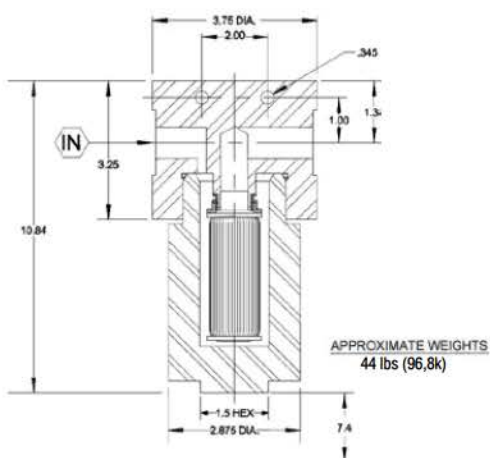
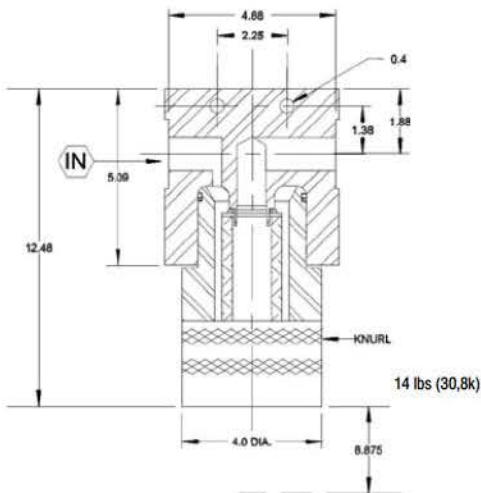

PART NUMBER	DIAMETER INCHES (CM)	DIAMETER INCHES (CM)	REPLACEMENT ELEMENT	REPLACEMENT O-RING
J85-T-2FF	3.75" (9,53)	10.84" (27,5)	J85-284-	B - Buna
J85-T-3FF	3.75" (9,53)	10.84" (27,5)	J85-284-	T - TEV
J85-T-4FF	3.75" (9,53)	10.84" (27,5)	J85-284-	V - Viton
J85-T-5FF	3.75" (9,53)	10.84" (27,5)	J85-284-	
J85-T-6FF	3.75" (9,53)	10.84" (27,5)	J85-284-	
				Example: J85-284-B

PART NUMBER	DIAMETER INCHES (CM)	DIAMETER INCHES (CM)	REPLACEMENT ELEMENT	REPLACEMENT O-RING
J85-T-2FF	5" (12,7)	12.84" (31,7)	J85-284-	B - Buna
J85-T-3FF	5" (12,7)	12.84" (31,7)	J85-284-	T - TEV
J85-T-4FF	5" (12,7)	12.84" (31,7)	J85-284-	V - Viton
J85-T-5FF	5" (12,7)	12.84" (31,7)	J85-284-	
J85-T-6FF	5" (12,7)	12.84" (31,7)	J85-284-	
				Example: J85-284-B

J85 TEE-TYPE SERIES

J85 Filter Assembly Less Element

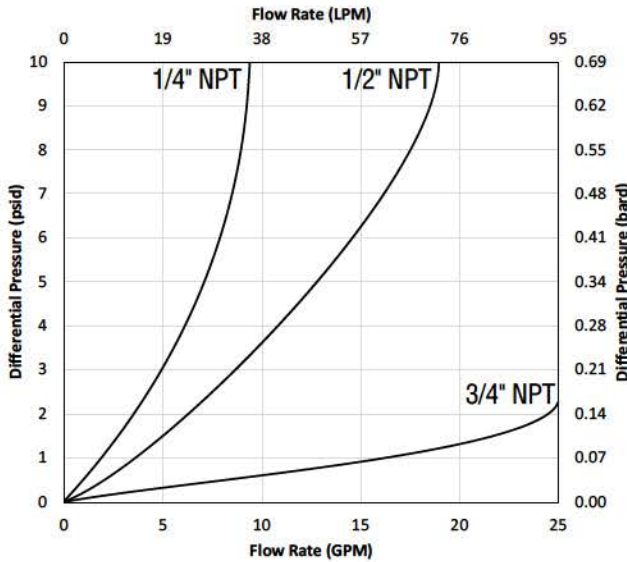

J85 Filter Stainless Elements

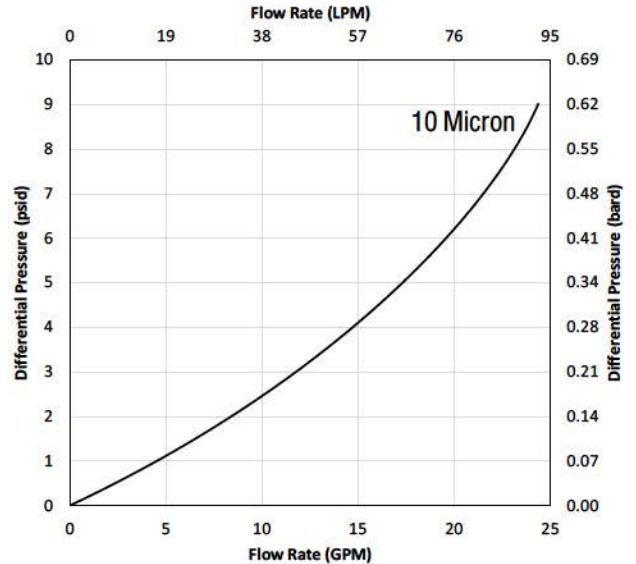

J85 HOUSING OPTIONS

Bypass Relief Valve

The bypass relief valve allows the system fluid to bypass the element assembly at a predetermined set point until the element is either cleaned or replaced. Standard set point: 50 psid / 3.4 bard cracking pressure.

ΔP Indicator

A stainless steel Visual Differential Pressure Indicator enables an operator to assess contaminant buildup before the filter element is plugged. The indicator is mounted on the top of the J85 filter. Once cleaned, the pressure indicator will automatically reset. Standard set point is 40 psid / 2.8 bard.

Electrical ΔP Indicator

A 303 stainless steel electrical Visual Differential Pressure Indicator is ideal for applications where visual inspection is difficult due to location or when remote monitoring using centralized process equipment. An adjustable electric, normally open, reed switch Δ P indicator can be used to operate signal devices. The contacts close when the Δ P increases and automatically resets when Δ P decreases. There is a 3/4" male pipe connection for the electrical connection. Voltage requirements: 10W-DC resistive 110 VA-AC resistive. The switch current is 0.5 amps. A relay is required for heavier loads.

J SERIES FILTERS ORDERING SCHEMATIC

J82 MINI IN-LINE			
Series	Pressure Rating	Inlet Port Size	Inlet and Outlet Port Type
J82	U - 3000 psig (207 bar)	2 - 1/4"	FM - Female NPT/ Male NPT
	T - 6000 psig (414 bar)*	3 - 3/8"	FF - Female NPT/ Female NPT
		4 - 1/2"	
Example: J82-T-2FM			

J88 SERIES MINI IN-LINE (REPLACEABLE FILTERS)			
Series	Pressure Rating	Inlet Port Size	Inlet and Outlet Port Type
J88	T - 6000 psig (414 bar)*	2 - 1/4"	FM - Female NPT/ Male NPT
		3 - 3/8"	FF - Female NPT/ Female NPT
		4 - 1/2"	
Example: J88-T-2FM			

J83 SERIES IN-LINE				
Series	Pressure Rating	Inlet Port Size	Inlet and Outlet Port Type	O-Ring Material
J83	U - 3000 psig (207 bar)	2 - 1/4"	FF - Female NPT/ Female NPT	Standard:
	T - 6000 psig (414 bar)	3 - 3/8"		L - Buna
	S - 10,000 psig (690 bar)*	4 - 1/2"		Optional:
		5 - 3/4"		N - Teflon
		6 - 1"		M - Viton
				Z - Ethylene Propylene
			K - Kalrez	
Example: J83-T-2FF-L				

J85 SERIES TEE-TYPE					
Series	Pressure Rating	Inlet Port Size	Inlet and Outlet Port Type	O-Ring Material	Housing Options
J85	T - 6000 psig (414 bar)	2 - 1/4"	FF - Female NPT/ Female NPT	Standard:	E - Electrical
	S - 10,000 psig (690 bar)*	3 - 3/8"		L - Buna	V - Visual
	4 - 1/2"	Optional:		B - Bypass	
	5 - 3/4"	N - Teflon		VB - Visual P Indicator and Bypass Relief Valve	
	6 - 1"	M - Viton			
				EB - Electrical	
Example: J85-T-2FF-LVB					

*1/4" ONLY