

**Valve Specifications**

**Operating Pressure (Air)**

**Maximum:**

150 PSIG  
 200 PSIG for Model No. 0R37TB (PTFE diaphragm)

**Minimum:**

3 PSIG  
 50 PSIG for Model No. 0R37TB (PTFE diaphragm)

**Operating Temperature:**

Urethane: 0°F to 180°F\* (-18°C to 80°C)  
 Nitrile: 0°F to 180°F\* (-18°C to 80°C)  
 Fluorocarbon: 0°F to 400°F\* (-18°C to 205°C)  
 PTFE: 0°F to 500°F\* (-18°C to 260°C)

\* Ambient temperatures below freezing require moisture-free air.  
 Ambient temperatures below freezing and above 180° require lubricants especially selected for suitability at these temperatures.  
 Pneumatic valves should be used with filtered and lubricated air.

**Component Materials**

**Body Material**..... Die cast aluminum  
**Static Seals**.....Nitrile standard with urethane (Others see below)  
**Diaphragm** ..... Standard – Urethane  
 Optional – Fluorocarbon, PTFE, or Nitrile (Depending on size)

**Mounting Bracket Kit –**

**No. 03640 8100**

(Including body screws)

For “0R12” and “0R25” sizes  
 with 7/8” “A” Dimension.

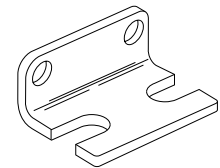

**General Information**

Quick exhaust valves provide rapid exhaust of control air when placed between control valve and actuator. They can also be used as shuttle valves. Diaphragm materials are available in urethane, Nitrile, Fluorocarbon, and PTFE to meet a wide variety of operating conditions.

**Model Selection, Performance Data and Dimensions**

Port			Flow (SCFM) <sup>†</sup>	Model Number		A	B	C	Service Kit No.
1	2	3		NPTF	BSPP “G”				
<b>STANDARD URETHANE DIAPHRAGMS (Nitrile static seals)</b>									
1/4"	1/4"	3/8"	150	<b>0R25NB</b>	0RB25NB	1" Hex	2.06	2.44	03340 0105
	3/8"	3/8"	240	<b>0R25PB</b>	—	1" Hex	2.06	2.44	03340 0105
3/8"	3/8"	3/8"	240	<b>0R37B</b>	0RB37B	1" Hex	2.06	2.44	03340 0105
1/2"	1/2"	1/2"	450	<b>0R50B</b>	0RB50B	1-1/2" Hex	2.88	3.38	03475 0109
3/4"	3/4"	3/4"	550	<b>0R75B</b>	0RB75B	1-1/2" Hex	2.88	3.38	03475 0109
<b>NITRILE DIAPHRAGMS (Nitrile static seals)</b>									
1/8"	1/8"	1/8"	70	<b>0R12B</b>	0RB12B	7/8" Sq.	1.75	1.88	03640 8000
	1/8"	1/4"	70	<b>0R12NB</b>	0RB12NB	7/8" Sq.	1.75	1.88	03640 8000
1/4"	1/4"	1/4"	90	<b>0R25B</b>	0RB25B	7/8" Sq.	1.75	1.88	03640 8000
	1/4"	3/8"	90	<b>0R25NFB</b>	0RB25NFB	7/8" Sq.	1.75	1.88	03340 8000
3/8"	3/8"	3/8"	240	<b>0R37FB</b>	0RB37FB	1" Hex	2.06	2.44	03340 8000
3/4"	3/4"	3/4"	550	<b>0R75FB</b>	0RB75FB	1-1/2" Hex	2.88	3.38	03475 9000
<b>FLUOROCARBON DIAPHRAGMS for extended temperature operation (Fluorocarbon static seals)</b>									
1/8"	1/8"	1/8"	70	<b>0R12VB</b>	0RB12VB	7/8" Sq.	1.75	1.88	03650 8000
	1/8"	1/4"	70	<b>0R12NVB</b>	0RB12NVB	7/8" Sq.	1.75	1.88	03650 8000
1/4"	1/4"	1/4"	90	<b>0R25VB</b>	0RB25VB	7/8" Sq.	1.75	1.88	03650 8000
3/8"	3/8"	3/8"	240	<b>0R37VB</b>	0RB37VB	1" Hex	2.06	2.44	03340 0319
1/2"	1/2"	1/2"	450	<b>0R50VB</b>	0RB50VB	1-1/2" Hex	2.88	3.38	03475 0120
3/4"	3/4"	3/4"	550	<b>0R75VB</b>	0RB75VB	1-1/2" Hex	2.88	3.38	03475 0120
<b>PTFE DIAPHRAGMS for higher pressure and temperature (Fibre static seals)</b>									
3/8"	3/8"	3/8"	240	<b>0R37TB</b>	0RB37TB	1" Hex	2.06	2.44	03340 0504

† At 100 PSIG inlet pressure with full pressure drop.

**BOLD ITEMS ARE MOST POPULAR.**

**D**  
 Tanks & Air Chucks  
 Mufflers & Silencers  
 Relief & Exhaust Valves  
 Pressure Switches  
 AirGuard Protection  
 Drain Valves  
 Safety Blow Guns