

Model

SS-5 Stainless Steel Rigid Coupling

- Angle-Pad Design -

The Shurjoint Model SS-5 is an angle-pad design stainless steel coupling for use with Sch. 5S, Sch. 10S or Sch. 40S stainless steel pipe where a rigid connection is desired. The angle-pad design allows the coupling housings to slide along the bolt pads when tightened. The result is an offset clamping action which provides a rigid joint which resists so called 'snaking' of a long straight run. With the removal of only one

bolt you can make a fast and easy "swing-over" installation. The SS-5 couplings are comprised of two identical CF8 (304) or CF8M (316) housing segments, EPDM gaskets and stainless steel track bolts and heavy duty nuts.

The Shurjoint Model SS-5 is available with a standard "C" shaped or *GapSeal* gasket in a variety of grades to meet your specific service requirements.

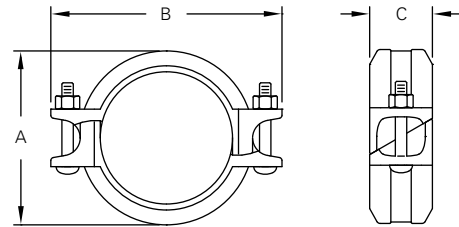

| Nominal Size | Pipe O.D. | Max. Working Pressure (CWP)** | Max. End Load (CWP) | Axial Displacement † | Dimensions | | | Bolt | | Weight |
|--------------|-----------|-------------------------------|---------------------|----------------------|------------|-------|------|------|--------|--------|
| | | | | | A | B | C | No. | Size | |
| in | in | PSI | Lbs | in | in | in | in | No. | in | Lbs |
| mm | mm | Bar | kN | mm | mm | mm | mm | | | Kgs |
| 1¼ | 1.660 | 600 | 1298 | 0 ~ 0.05 | 2.60 | 4.00 | 1.81 | 2 | ¾ x 2½ | 1.4 |
| 32 | 42.2 | 42 | 5.77 | 0 ~ 1.2 | 66 | 102 | 46 | 2 | ¾ x 2½ | 0.6 |
| 1½ | 1.900 | 600 | 1700 | 0 ~ 0.05 | 2.83 | 4.29 | 1.81 | 2 | ¾ x 2½ | 1.5 |
| 40 | 48.3 | 42 | 7.56 | 0 ~ 1.2 | 72 | 109 | 46 | 2 | ¾ x 2½ | 0.7 |
| 2 | 2.375 | 600 | 2657 | 0 ~ 0.07 | 3.35 | 4.61 | 1.85 | 2 | ¾ x 2¾ | 1.7 |
| 50 | 60.3 | 42 | 11.82 | 0 ~ 1.7 | 85 | 117 | 47 | 2 | ¾ x 2¾ | 0.8 |
| 2½ | 2.875 | 600 | 3893 | 0 ~ 0.07 | 3.86 | 5.20 | 1.85 | 2 | ¾ x 2¾ | 2.1 |
| 65 | 73.0 | 42 | 17.32 | 0 ~ 1.7 | 98 | 132 | 47 | 2 | ¾ x 2¾ | 0.9 |
| 3 | 3.500 | 600 | 5770 | 0 ~ 0.07 | 4.45 | 5.83 | 1.88 | 2 | ¾ x 2¾ | 2.6 |
| 80 | 88.9 | 42 | 25.67 | 0 ~ 1.7 | 113 | 148 | 48 | 2 | ¾ x 2¾ | 1.2 |
| 4 | 4.500 | 600 | 9538 | 0 ~ 0.16 | 5.75 | 7.17 | 2.09 | 2 | ¾ x 2¾ | 4.1 |
| 100 | 114.3 | 42 | 42.43 | 0 ~ 4.1 | 146 | 182 | 53 | 2 | ¾ x 2¾ | 1.9 |
| 5 | 5.563 | 600 | 14576 | 0 ~ 0.16 | 6.89 | 9.02 | 2.09 | 2 | ½ x 3 | 5.7 |
| 125 | 141.3 | 42 | 64.84 | 0 ~ 4.1 | 175 | 229 | 53 | 2 | ½ x 3 | 2.6 |
| 6 | 6.625 | 600 | 20672 | 0 ~ 0.16 | 8.00 | 9.80 | 2.13 | 2 | ½ x 3 | 6.8 |
| 150 | 168.3 | 42 | 91.96 | 0 ~ 4.1 | 203 | 249 | 54 | 2 | ½ x 3 | 3.1 |
| 8 | 8.625 | 600 | 35038 | 0 ~ 0.19 | 10.40 | 12.99 | 2.52 | 2 | ¾ x 4¾ | 13.4 |
| 200 | 219.1 | 42 | 155.86 | 0 ~ 4.8 | 264 | 330 | 64 | 2 | ¾ x 4¾ | 6.1 |

**The working pressure shown is based on roll-grooved Sch. 40S pipe. For other pipe schedules and cut-grooved pipe, see page 101.

† Allowable Axial Displacement and Angular Movement (deflection) figures are for roll grooved standard steel pipe. Values for cut grooved pipe will be double that of roll grooved. These values are maximums; for design and installation purposes these figures should be reduced by: 50% for ¾"/DN20 - 3½"/DN90; 25% for 4"/DN100 and larger to compensate for jobsite conditions.