

Threaded Accessories

B3248 - Steel Washer Plate

Size Range: 3/8" thru 1" rod sizes

Material: Steel

Function: Heavy duty washer for use on top of channels or angles to support hanger rod.

Finish: Plain. Contact customer service for alternative finishes and materials.

Order By: Figure number size and finish

Part No.	Rod Size C	A		T		Approx. Wt./100	
		in.	(mm)	in.	(mm)	Lbs.	(kg)
B3248-3/8	3/8"-16	2"	(50.8)	1/4"	(6.3)	27	(12.2)
B3248-1/2	1/2"-13	2"	(50.8)	1/4"	(6.3)	27	(12.2)
B3248-5/8	5/8"-11	2 1/2"	(63.5)	1/4"	(6.3)	47	(21.3)
B3248-3/4	3/4"-10	2 1/2"	(63.5)	3/8"	(9.5)	52	(23.6)
B3248-7/8	7/8"-9	3"	(76.2)	3/8"	(9.5)	85	(38.5)
B3248-1	1"-8	4"	(101.6)	3/8"	(9.5)	160	(72.6)

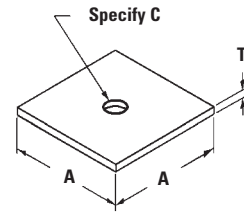

B200 - Series Square Washer

Material: Steel

Standard Finish: Electro-Galvanized

Service: Designed as a washer to suspend hanger rods.

Approvals: Qualified for static, wind, and seismic loading in concrete. Included in our Seismic Engineering Guidelines approved by the State of California Office of Statewide Health Planning and Development (OSHPD). For additional load, spacing and placement information relating to OSHPD projects, please refer to our Seismic Engineering Guidelines, OPM-0052-13.

Order by: Figure number and finish.

Part No.	Hole Size A		Bolt Size	Thickness		Approx. Wt./100	
	in.	(mm)		in.	(mm)	Lbs.	(kg)
B200	3/8"	(9.5)	5/16"-18	1/4"	(6.3)	18	(8.1)
B201	7/16"	(11.1)	3/8"-16	1/4"	(6.3)	18	(8.1)
B202	9/16"	(14.2)	1/2"-13	1/4"	(6.3)	17	(7.7)
B202-1	1 1/16"	(17.4)	5/8"-11	1/4"	(6.3)	16	(7.2)
B202-2	1 3/16"	(20.6)	3/4"-10	1/4"	(6.3)	15	(6.8)

OPM

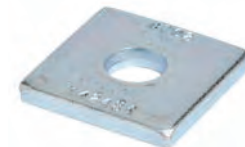
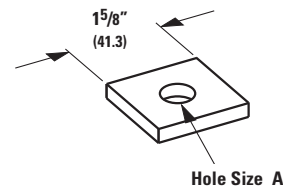

Threaded Accessories

B3234 - Bevel Washer

Size Range: 3/8"-16 thru 7/8"-9 bolt

Material: Malleable Iron

Function: Designed to match taper of flange of I-beam or channel to permit right angle fastening of bolt.

Finish: Plain. Contact customer service for alternative finishes and materials.

Order By: Figure number size and finish

Part No.	For Bolt Size	A		T ¹		T ²		Approx. Wt./100	
		in.	(mm)	in.	(mm)	in.	(mm)	Lbs.	(kg)
B3234-3/8	3/8"-16	1 1/4"	(31.7)	5/32"	(3.9)	11/32"	(8.7)	9	(4.1)
B3234-1/2	1/2"-13	1 1/4"	(31.7)	5/32"	(3.9)	11/32"	(8.7)	9	(4.1)
B3234-5/8	5/8"-11	1 1/2"	(38.1)	5/32"	(3.9)	13/32"	(10.3)	14	(6.3)
B3234-3/4	3/4"-10	1 1/2"	(38.1)	7/32"	(5.5)	15/32"	(11.9)	16	(7.2)
B3234-7/8	7/8"-9	2"	(50.8)	7/32"	(5.5)	9/16"	(14.3)	33	(14.9)

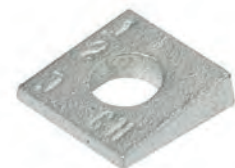
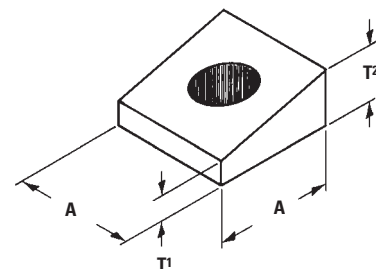

All dimensions in charts and on drawings are in inches. Dimensions shown in parentheses are in millimeters unless otherwise specified.