

HWA Series – 2/2 Normally Closed

Specifications	
Function	Normally Closed, energise to open 
Body Material up to 3"	Aluminium
Body Material above 3"	Cast Iron
Closing Time:	Less than 1 second
Springs	Stainless Steel 302 & 316
Seal Material (Std)	NBR
Connection Type (Std)	BS21 & flanged PN16
Electrical Characteristics	
Coil Voltage AC 50 Hz (~)	110 V, 230 V
Voltage Tolerance	+10% / -15%
Protection Class (Std)	IP5X (BS EN 60529)
Electrical Connection (Std)	Suitable for M20 Conduit
Power Rating (Std)	90 VA, 50 W (Inrush), 9 VA, 9 W (Hold)

Seal Material ¹ and Media Temp. Range	Ambient Temperature Range °C	
	Min	Max
NBR (-10 °C to +80 °C)	0	60

¹ See corrosion reference guide and sealing solutions for material compatibility.

Electro-Thermal Links

Rotork also offers a range of electro-thermal links that can be wired into the power supply of the HWA series valve offering shut down in the event of a fire.



Part Number	Description
10904209	Electro-thermal link 73 °C

Features and Benefits

- Approved for mains gas safety shut off
- Suitable for automatic burners
- Suitable for fire protection systems
- Ideal for low pressure natural gas
- Fully ported orifices for high flow
- Zero pressure rated
- Slow opening
- Closed position volt free contacts available
- Fitted with pressure test points as standard
- First, second and third family gases
- Approved to EN161
- Compliant with Gas Appliance Regulation (EU) 2016/426 (GAR)
- Classification: Group 2 controls (BS EN 13611)



Pipe Size	Connection Type	Cv (gpm)	Kv (m³/h)	OPD (mBar)	P. Max Bar	Hold VA	Orifice (mm)	Weight (kg)
1¼"	BS21	54	46.5	0-345	5	9	68.00	9.6
1½"	BS21	54	46.5	0-345			68.00	9.6
2"	BS21	95	82	0-345			68.00	9.6
2"	Flanged	95	82	0-345			68.00	11.6
2½"	BS21	157	135	0-345			87.00	10.5
2½"	Flanged	157	135	0-345			87.00	13.1
3"	BS21	188	162	0-345			87.00	10.5
4"	Flanged	226	195	0-345			104.00	38.4
6"	Flanged	423	365	0-200			154.00	62.4

How to use the flow chart

1. Select the required flow.
2. Note the corresponding pressure drop.
3. Based on where the two points intersect select the most appropriate model.

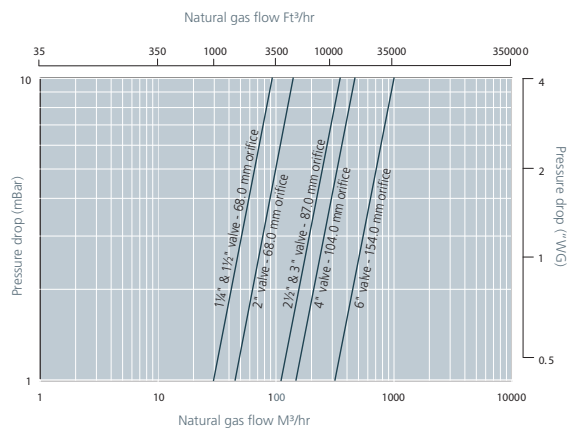

HWA Series – 2/2 Normally Closed

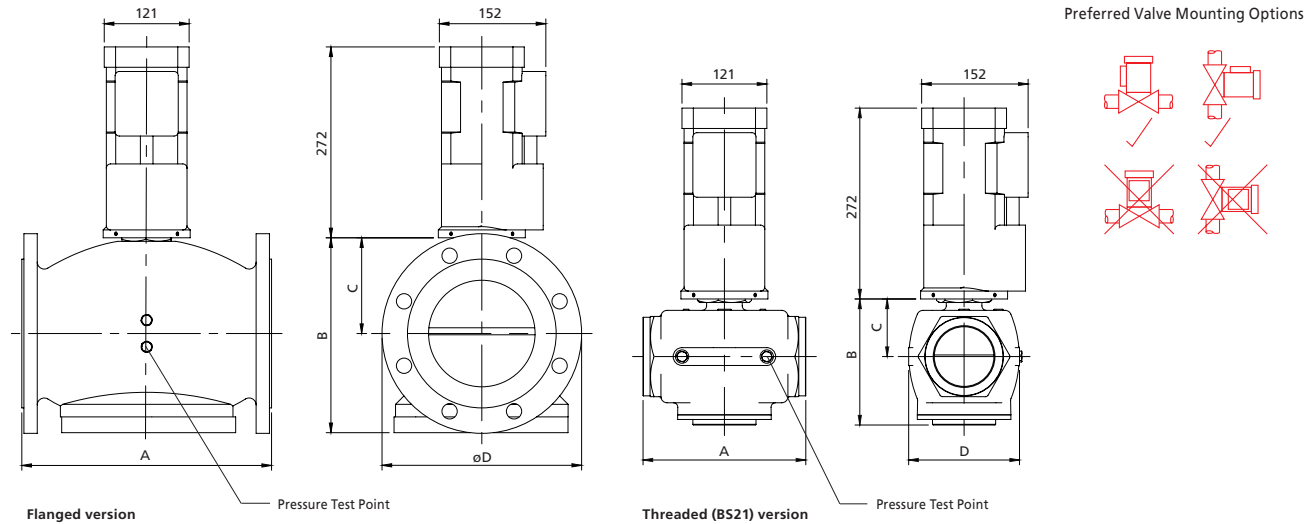

Dimensions

Pipe Size	A	B (without CPI)	B (with CPI)	C (without CPI)	C (with CPI)	D
1½" BS21	177.5	150.3	185.7	70.9	106.3	123.1
1½" BS21	177.5	150.3	185.7	70.9	106.3	123.1
2" BS21	177.5	150.3	185.7	70.9	106.3	123.1
2" Flanged	210	150.3	185.7	70.9	106.3	165
2½" BS21	232	180.5	215.9	83.7	119.1	158

Pipe Size	A	B (without CPI)	B (with CPI)	C (without CPI)	C (with CPI)	D
2½" Flanged	290	180.5	215.9	83.7	119.1	185
3" BS21	232	180.5	215.9	83.7	119.1	158
4" Flanged	292	227.8	263.2	94.3	129.7	220
6" Flanged	356	277.8	313.2	136.4	171.8	285

Standard flange size PN16 all others screwed BS21
Dimensions given in mm

Coding chart

Main Valve Assembly

Model		Valve Body Conn. Size ¹		Connection Type		Operation	Body Material		Seals		Style		Enclosure		Voltage / Frequency		Electrical Connection		
49	HWA	G	1¼"	1	B521	1	AUTO	3	Aluminium (up to and including 3")	A	NBR	1	Standard	7	Motorised	K1	110 V / 50 Hz	0	M20 Conduit
		H	1½"	4	FLANGED (PN16 STD)	4	Cast Iron (4" and above)	A		NBR	1	Standard	7	Motorised	K2	110 V / 50 Hz inc. Closed Position Indicator			
		J	2"												K5	230 V / 50 Hz			
		K	2½"												K6	230 V / 50 Hz inc. Closed Position Indicator			
		L	3"																
		M	4"																
		N	6"																
49		•	•	1	Z	•	A	1	-	7	••	0							

¹ See features chart for available connection types.

Product coding example:

49M41Z4A1-7K60 - HWA Series
4" Flanged, closed position indicator, auto operation,
cast iron, NBR seals, 230 V / 50 Hz.

Coil options

Enclosure	Voltage / Frequency	Electrical Connection
7	K1 110 V / 50 Hz	0
	K2 110 V / 50 Hz inc. Closed Position Indicator	M20 Conduit
	K5 230 V / 50 Hz	
	K6 230 V / 50 Hz inc. Closed Position Indicator	

Spares

Part Number	Description
7K10SA	110 V / 50 Hz actuator (without closed position indicator)
7K20SA	110 V / 50 Hz actuator (with closed position indicator)
7K50SA	230 V / 50 Hz actuator (without closed position indicator)
7K60SA	230 V / 50 Hz actuator (with closed position indicator)

Important Note: The new HWA actuator is not compatible with pre-1995 models, identified by an alpha-numeric date code on the valve body. The digits indicate the year and the letter indicates the month i.e. A = January, B = February, etc with M = December - (note the letter 'I' is not used). For example 94J = September 1994. In addition, pre-1995 valves have a flanged centre boss that is fitted to the body with 4 socket head screws, valves post 1995 have a centre boss with a screw in post.