

**DCAP SERIES**

**DUAL CHECK WITH ATMOSPHERIC PORT BACKFLOW PREVENTER**

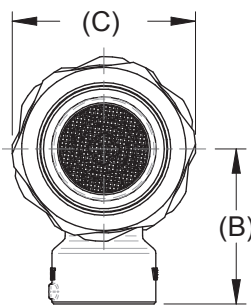
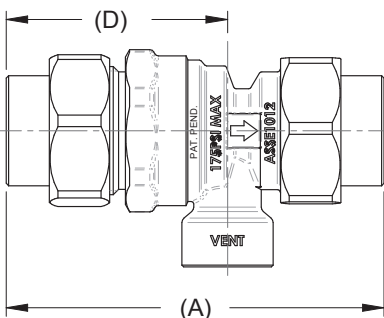

The Apollo® DCAP Series Backflow Preventer is designed to protect residential and commercial water supply lines from back-siphonage or back-pressure of non-potable (non-hazardous) substances. It has an intermediate atmospheric vent to insure protection from backflow conditions. It consists of two independently acting and spring-loaded check valves in a corrosion resistant material.

**OPERATION**

During normal flow operation, the vent valve is closed, and the two check valves are open allowing flow of water through the unit. Each check valve is designed to hold at least 1 psi in the direction of flow. When a back-siphonage condition occurs, both check valves close and the atmospheric vent opens to permit air to enter the intermediate zone. In the event of back-pressure and if the second check valve is prevented from closing tightly, leakage will be vented to the atmosphere through the vent port.

**FEATURES**

- Corrosion Resistant
- Low Head Loss
- Independently Acting Check Valves
- Ease of Repair and Installation
- Economical
- Suitable for Hot or Cold Water Service
- Durable
- Lead-Free Option
- 5 Year Warranty

**PERFORMANCE RATING**

- Maximum Working Pressure: 175 psig
- Inlet Temperature Range: 33° to 210°F
- Maximum backflow temperature: 250°F

**APPROVALS**

- ASSE 1012
- CSA B64.3
- NSF/ANSI 372 Lead Free (4ALF only)

**STANDARD MATERIALS LIST**

<b>BODY</b>	Forged Brass C87800
<b>UNION NUT &amp; TAILPIECES</b>	Forged Brass C87800
<b>SEAT DISCS</b>	EPDM (FDA/NSF 61)
<b>SEAT STEM &amp; RETAINER</b>	Forged Brass C46500
<b>SPRINGS</b>	Stainless Steel

**DIMENSIONS**

PART NUMBER	DIMENSIONS (IN.)				WT. (LB.)
	A	B	C	D	
4ALF4A33A, 4ALF4A33AC	4.1	1.6	1.9	2.4	1.31
4ALF4H33H, 4ALF4H33HC	3.9	1.6	1.9	2.3	1.24
4ALF4A44A, 4ALF4A44AC	4.3	1.6	1.9	2.5	1.32
4ALF4H44H, 4ALF4A44HC	4.4	1.6	1.9	2.6	1.29

**PART NUMBER MATRIX**

4A [X]	4 X	X - X	X	X
	UNION INLET CONNECTION	INLET AND OUTLET SIZE	UNION OUTLET CONNECTION	OPTION
4A - STANDARD	A - FNPT	3 - 1/2"	A - FNPT	C - CANADIAN (DISCHARGE PORT NOT THREADED)
4ALF - LEAD FREE	H - SOLDER JOINT	4 - 3/4"	B - MNPT	
			H - SOLDER JOINT	

BACKFLOW PREVENTION