



**Applications:**

- Clean Air
- Fume Exhaust
- Spark Resistant Construction

## Model TDI Direct Drive

Model TDI direct drive tube axial fans are best suited for applications moving relatively clean, dry and cool air in commercial and industrial applications.

### Quick Build Performance

Capacities range from 3,000 to 49,000 cfm and up to 1.1 in. wg of static pressure.



**Applications:**

- Clean Air
- Fume Exhaust
- Spark Resistant Construction

## Model TBI-CA Belt Drive

Model TBI-CA belt drive is a good selection where the motor must be mounted out of the airstream. Used with temperatures up to 200°F or contaminated air. Three levels of construction available.

### Quick Build Performance

Capacities range from 1,300 to 95,000 cfm and up to 3.5 in. wg of static pressure.



**Applications:**

- Industrial Space
- Contaminated Air
- High Temperature Process
- UL/cUL Emergency Smoke

## Model TBI-FS Belt Drive

Model TBI-FS belt drive fans have motors out of the airstream. They are a good choice for clean or contaminated airstreams with temperatures up to 400°F. Three levels of construction available.

### Quick Build Performance

Capacities range from 6,000 to 77,000 cfm and up to 4.5 in. wg of static pressure.

UL/cUL 705 Power Ventilators  
E40001 - TDI and TBI-CA

UL/cUL Power Ventilators for Smoke Control Systems  
MH17511 - TBI-FS



Model TDI and TBI-CA are AMCA Licensed for Air Performance

Model TBI-FS is AMCA Licensed for Sound and Air Performance

**Best Available Program**  
10 Days

Standard Construction	TDI	TBI-CA	TBI-FS
Housing - continuously welded, steel	■	■	■
Cast aluminum hub and blades - airfoil	■	■	
Fabricated steel hub and blades - airfoil			■
Belt tube and bearing cover		■	■
Minimum bearing life of L <sub>10</sub> 80,000 hours		■	■
Universal mounting system	■	■	■
Extended lubrication lines	■	■	■
Permatecor™ protective powder coating	■	■	■
Options and Accessories	TDI	TBI-CA	TBI-FS
Motor cover		■	■
Guards - inlet, outlet	■	■	■
Belt guard		■	■
Companion flanges	■	■	■
Isolators - base, hanging, spring	■	■	■
Easy access construction - bolted		■	■
Inspection door - bolted, hinged	■	■	■
Inspection section with removable access panel	■	■	■
NEMA rated disconnect switch	■	■	■
Mounting rails		■	■
Shaft seal		■	■
Inlet bell	■	■	■
Decorative or protective powder coating	■	■	■
Continuous Duty High Temperature			■
UL/cUL Listed Power Ventilators	■	■	■

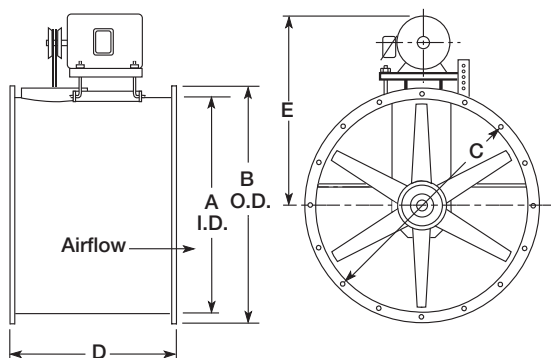

### Dimensions for TDI, TBI-CA, TBI-FS

TDI • Level 3					TBI-CA • Level 3						TBI-FS • Levels 3 and 4					
Model Size	A (ID)	B (OD)	C (BC)	D	Model Size	A (ID)	B (OD)	C (BC)	D	E	Model Size	A (ID)	B (OD)	C (BC)	D	E
18	18 <sup>3</sup> / <sub>8</sub>	21 <sup>1</sup> / <sub>8</sub>	19 <sup>3</sup> / <sub>4</sub>	18	18	18 <sup>3</sup> / <sub>8</sub>	21 <sup>5</sup> / <sub>8</sub>	19 <sup>3</sup> / <sub>4</sub>	22	21 <sup>3</sup> / <sub>4</sub>	3L24, 3H24				23	26
20	20 <sup>3</sup> / <sub>8</sub>	23 <sup>1</sup> / <sub>8</sub>	21 <sup>3</sup> / <sub>4</sub>	19	20	20 <sup>3</sup> / <sub>8</sub>	23 <sup>5</sup> / <sub>8</sub>	21 <sup>3</sup> / <sub>4</sub>	27	26 <sup>1</sup> / <sub>4</sub>	4L24, 4H24	24 <sup>3</sup> / <sub>8</sub>	27 <sup>5</sup> / <sub>8</sub>	25 <sup>3</sup> / <sub>4</sub>	28	28
24	24 <sup>3</sup> / <sub>8</sub>	27 <sup>1</sup> / <sub>8</sub>	25 <sup>3</sup> / <sub>4</sub>	19	24	24 <sup>3</sup> / <sub>8</sub>	27 <sup>5</sup> / <sub>8</sub>	25 <sup>3</sup> / <sub>4</sub>	28	28	3L30, 3H30	30 <sup>3</sup> / <sub>8</sub>	33 <sup>5</sup> / <sub>8</sub>	32	24	29 <sup>3</sup> / <sub>4</sub>
30	30 <sup>3</sup> / <sub>8</sub>	33 <sup>3</sup> / <sub>8</sub>	32	21	30	30 <sup>3</sup> / <sub>8</sub>	33 <sup>5</sup> / <sub>8</sub>	32	24	29 <sup>3</sup> / <sub>4</sub>	4L30, 4H30	30 <sup>3</sup> / <sub>8</sub>	33 <sup>5</sup> / <sub>8</sub>	32	33	32 <sup>3</sup> / <sub>4</sub>
36	36 <sup>3</sup> / <sub>8</sub>	39 <sup>3</sup> / <sub>8</sub>	38	21	36	36 <sup>3</sup> / <sub>8</sub>	39 <sup>5</sup> / <sub>8</sub>	38	29	33 <sup>3</sup> / <sub>4</sub>	3L36, 3H36	36 <sup>3</sup> / <sub>8</sub>	39 <sup>5</sup> / <sub>8</sub>	38	29	33 <sup>3</sup> / <sub>4</sub>
42	42 <sup>1</sup> / <sub>2</sub>	45 <sup>3</sup> / <sub>4</sub>	44 <sup>1</sup> / <sub>4</sub>	27	42	42 <sup>1</sup> / <sub>2</sub>	45 <sup>3</sup> / <sub>4</sub>	44 <sup>1</sup> / <sub>4</sub>	30	37 <sup>1</sup> / <sub>4</sub>	4L36, 4H36	36 <sup>3</sup> / <sub>8</sub>	39 <sup>5</sup> / <sub>8</sub>	38	34	35 <sup>3</sup> / <sub>4</sub>
48	48 <sup>1</sup> / <sub>2</sub>	52 <sup>3</sup> / <sub>4</sub>	50 <sup>3</sup> / <sub>4</sub>	27	48	48 <sup>1</sup> / <sub>2</sub>	52 <sup>3</sup> / <sub>4</sub>	50 <sup>3</sup> / <sub>4</sub>	33	40 <sup>1</sup> / <sub>2</sub>	3L42, 3H42	42 <sup>1</sup> / <sub>2</sub>	45 <sup>3</sup> / <sub>4</sub>	44 <sup>1</sup> / <sub>4</sub>	30	37 <sup>3</sup> / <sub>4</sub>
					54	55	59 <sup>1</sup> / <sub>4</sub>	57 <sup>1</sup> / <sub>4</sub>	37 <sup>1</sup> / <sub>2</sub>	47 <sup>1</sup> / <sub>4</sub>	4L42, 4H42	42 <sup>1</sup> / <sub>2</sub>	45 <sup>3</sup> / <sub>4</sub>	44 <sup>1</sup> / <sub>4</sub>	39	40
					60	61	65 <sup>1</sup> / <sub>4</sub>	63 <sup>1</sup> / <sub>4</sub>	40	50 <sup>3</sup> / <sub>4</sub>	3L48, 3H48	48 <sup>1</sup> / <sub>2</sub>	52 <sup>3</sup> / <sub>4</sub>	50 <sup>3</sup> / <sub>4</sub>	33	40 <sup>1</sup> / <sub>2</sub>
											4L48, 4H48	48 <sup>1</sup> / <sub>2</sub>	52 <sup>3</sup> / <sub>4</sub>	50 <sup>3</sup> / <sub>4</sub>	44	45 <sup>1</sup> / <sub>2</sub>
											3L54, 3H54	55	59 <sup>1</sup> / <sub>4</sub>	57 <sup>1</sup> / <sub>4</sub>	37 <sup>1</sup> / <sub>2</sub>	47 <sup>1</sup> / <sub>4</sub>
											4L54, 4H54	55	59 <sup>1</sup> / <sub>4</sub>	57 <sup>1</sup> / <sub>4</sub>	48	49 <sup>3</sup> / <sub>4</sub>

All dimensions are in inches.

ID = Inside Diameter  
 OD = Outside Diameter  
 BC = Bolt Center