



UL/cUL 762 Power Ventilators for Restaurant Exhaust Appliances - MH11745 - USGF, USGF-HP



UL/cUL Listed 762 is standard on USGF, USGF-HP models.

Model USGF is AMCA Licensed for Sound and Air Performance

8

Best Available Program

10 Days

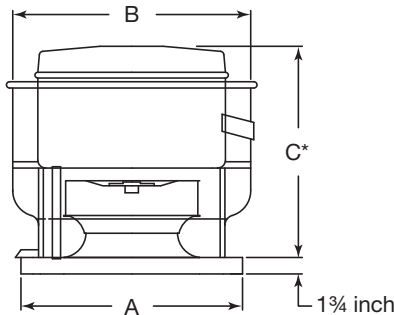

Model USGF Belt Drive

Severe duty centrifugal upblast fans are designed for exhausting highly contaminated air in roof mounted applications.

Quick Build Performance

USGF capacities range from 330 to 6,800 cfm and 2.75 in. wg of static pressure.

Standard Construction	
Housing - heavy-gauge steel	
Housing fully welded to curb cap with drain trough	
Wheel - backward-inclined, heavy-gauge steel	
Non-stick coating on wheel	
One piece windband - steel	
Corrosion-resistant fasteners	
NEMA-3R disconnect switch	
Assembled hinged base - <i>NFPA required</i>	
Clean-out port - <i>NFPA required</i>	
Ball bearing motor - 1/4 hp and larger	
Dual drives	
Relubricatable bearings	
Heat baffle	
Double-studded vibration isolators	
Lifting lugs	
Adjustable motor pulley	
Permatector™ protective powder coating	
Options and Accessories	Stock
Damper - <i>not for use in kitchen applications</i>	
Roof curb - <i>NFPA requires vented roof curb</i>	✓
Roof curb accessories - seals, adaptors, extensions	
Grease trap and drain connection - <i>NFPA required</i>	
Windband extension	
Tie-down points	
NEMA rated disconnect switch	
Decorative or protective powder coating	
Certified for high wind and seismic applications	

Dimensions for USGF

Model Size	A	B	C*	Nominal Sq. Sizes	
				Roof Curb	Roof Opening
140, 160	26	28 ⁷ / ₈	29 ³ / ₄	26	18 ¹ / ₂
180, 200	30	35 ³ / ₈	28 ³ / ₈	30	20 ¹ / ₂

All dimensions are in inches. Dimension A given is the inside dimension of the curb cap.
*May be greater depending on motor.