

DUPLEX MULTI-FUNCTION LIQUID LEVEL CONTROLLER

A SINGLE CONTROL FOR 3 FLOATS, 4 FLOATS OR A TRANSDUCER...
WITH THE CAPACITY TO INCLUDE EVEN MORE FEATURES

- A standard option for applications that require a wide range of functionality
- Newfound flexibility to simultaneously standardize fleet and expand control feature set
- Multiple functions are embedded in the product to offer:
 - 1) ease of ordering and stocking
 - 2) easy to configure transducer set points during field installation
 - 3) expand functionality as application needs diversify
 - 4) capability to accept high level float that could operate pumps should the transducer fail (redundancy) and
 - 5) savings versus ordering a la carte features



G&G CONTROLS

A Division of Stancor, L.P.

DEWATERING | ENVIRONMENTAL | MUNICIPAL | RESIDENTIAL

NEWFOUND SIMPLICITY

By definition, the implementation of customized controls indicates a level of complexity. The Duplex Multi-Function Liquid Level Controller, however, manages to offer more functionality while reducing complexity often associated with specification, ordering and field implementation.

To help match performance with need, there are two versions: Eco and Industrial. The industrial version is the baseline. The Eco version has fewer features for less demanding applications.

Core features are standard—leveraging decades of design experience into a comprehensive package. And the control is a platform on which additional features can be added to increase system functionality and leverage existing technology into a system solution. It has never been easier to add functionality that offers increased control over the system and the resulting performance results.

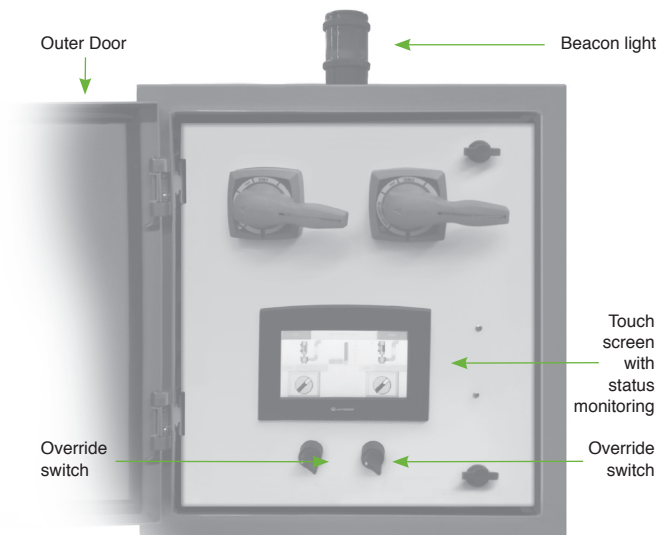

Industrial Version Dimensions: 20" wide / 24" tall / 12" deep

INDUSTRIAL VERSION FEATURES

STANDARD FEATURES – GRAPHICAL CONTROL

- Pump status
- HOA (hand/off/auto)
- Hour meters
- Cycle counters
- Built-in pump alternation
- Graphical and numerical level indicators (transducer)
- Float level status (floats)
- Seal fail status
- Temperature status

STANDARD FEATURES – HARDWARE

- 7-inch touch screen
- Molded case circuit breakers (MCCB)
- IEC contactors
- Control transformer
- Control circuit breakers
- Heavy-duty dead front enclosure with inner door
- Heavy-duty, individually lockable disconnect switches
- Individual pump disconnect switch
- Anti-condensate heater with thermostats
- Seal failure/temperature (wired socket only)

STANDARD FEATURES – ALARM NOTIFICATION

- High level dry contact (building monitoring)
- Low level dry contact (building monitoring)
- Pump overload dry contact (building monitoring)
- Active alarm display
- Alarm history display (time and date)
- Beacon light and audible horn
- Silence and test

AVAILABLE OPTIONS

- Enclosure offered in: stainless steel, poly carbonate or metal epoxy coating
- Module to activate seal failure/thermal
- Upgrade package to intrinsically safe version
- Equipped with variable drive package installed with either set point speeds, speed control, potentiometer or PID-maintained set point
- NEMA contactors
- Remote monitoring access through any electronic device