

**NEW**

WEIGH MODULES

**RL50219SS-TA**

50lb-500lb Capacity Mini Tank Weighing Module, Stainless Steel



*Picture is a representation of actual product.*

The RL50219SS-TA weigh module kit provides a cost-effective alternative for your customers' low-range weighing needs. A variety of features makes this kit easy to install and an exceptional choice for various indoor weighing applications where checking requirements are low. Environmentally protected load cells, neoprene isolation/compression mounts and other Rice Lake Weighing Systems components are the keys to this module's outstanding performance.

*Module with RL50219SS cantilever beam load cell; capacities (per module): 50 lb (22.7 kg), 100 lb (45.4 kg), 150 lb (68.0 kg) and 250 lb (113.4 kg). 500 lb model features stainless steel single-ended beam load cell.*



*RL50219SS-TA stainless (50 lb-250 lb)*

**Complete Kit Includes**

- One JB4SS NEMA Type 4X stainless steel signal trim junction box
- Three or four RL50219SS cantilever beam load cells (50-250 lb models)
- Three or four stainless steel single-ended beam load cells (500 lb models)
- Three or four neoprene isolation/compression mounts
- 25 ft of our hostile environment EL147HE SURVIVOR® load cell cable

**Standard Features**

- Stainless steel modules
- Lower weighing ranges from 50-500 lb (22.7-226.8 kg) per module
- Environmentally protected load cells
- Neoprene isolation/compression mounts allow for minor misalignment, thermal expansion and shock absorption
- Overload stop for 500 lb (226.8 kg) modules provides durability

**Applications**

- Small tanks and hoppers
- Conveyor/In-motion weighing
- Small platform scales where minor shock loading may be a problem

**Dimensions**

Rated Capacity	C	C1	H	H1	L	L1	L2	W	W1	W2	W3
<b>lb/in</b>											
50-250	0.34	—	3.13	0.50	4.00	3.25	2.38	3.88	3.00	2.25	—
500	0.44	0.56	3.88	0.50	6.00	4.00	3.38	5.50	4.00	3.00	4.13
<b>kg/mm</b>											
22.7-113.4	8.6	—	79.5	12.7	101.6	82.6	60.5	98.6	76.2	57.2	—
226.8	11.2	14.2	98.6	12.7	152.4	101.6	85.9	139.7	101.6	76.2	104.9

**Order Information**

Load Rating (Per Module)*	Part#	Price
<b>Stainless Steel Single Module (Includes Load Cell)</b>		
50 lb	196829	\$625.00
75 lb	196830	\$625.00
100 lb	196831	\$625.00
150 lb	196832	\$625.00
250 lb	196833	\$625.00
500 lb	17954	\$640.00
<b>Stainless Steel 3-Module Kit</b>		
50 lb	196840	\$2,125.00
75 lb	196841	\$2,125.00
100 lb	196842	\$2,125.00
150 lb	196843	\$2,125.00
250 lb	196844	\$2,125.00
500 lb	30394	\$2,135.00
<b>Stainless Steel 4-Module Kit</b>		
50 lb	196845	\$2,750.00
75 lb	197015	\$2,750.00
100 lb	196846	\$2,750.00
150 lb	196848	\$2,750.00
250 lb	196849	\$2,750.00
500 lb	30393	\$2,795.00

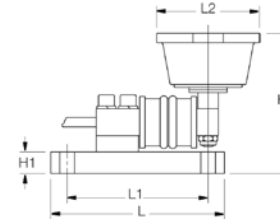
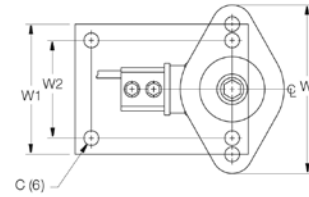

50-250 lb (22.7-113.4 kg)

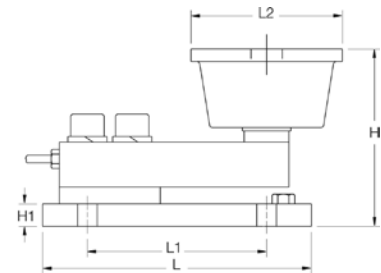
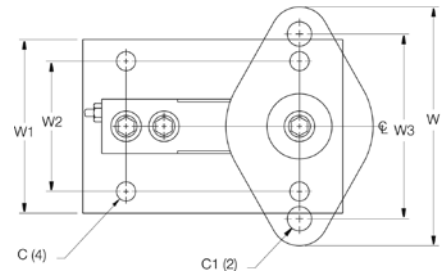

500 lb (226.8 kg)