

DULCO flex Control

Intelligent peristaltic metering pump!



ProMinent®

The new **DULCO flex Control** is an intelligent peristaltic metering pump that is valve-free and has the accuracy of a diaphragm pump. Applications include gaseous, highly viscous, abrasive, shear-sensitive and chemically aggressive fluids.

The liquid end of the pump is designed for a quick and simple replacement of the tubing, utilizing a unique exchange process. The pump display provides precise instructions on the steps required for the tube replacement. High-performance tubing consists of a **TPV (Santoprene)** or **PUR (Polyurethane)** material that provides excellent chemical resistance and a long service life.

The **DULCO flex Control** is powered by a DC motor and will provide continuous metering from **0.048 GPD (0.18 L/D)** to **7.92 GPH (30 L/H)**. Additional features such as communication protocol includes PROFIBUS, CANbus, Modbus and PROFINET will be available early 2020.

Features & Benefits

- Volume adjustment in GPH or LPH
- Manual, Analog, Contact and Batch modes optional
- High visibility of LED-indicator lights
- Large illuminated display
- New configurable input/output port
- Pump is available as an FDA design
- CIP (cleaning in place) enabled system
- Turn down ratio up to 3,000:1
- Reverse flow is possible
- Dosing head can be aligned in four directions: Left, Right, Up and Down
- Integrated 7-day timer
- Viscosities to 10,000 cPs
- DULCOneX-enabled

DULCO flex Control

Technical data

Capacity Data									
Pump Version	Capacity at Maximum Backpressure				Max. speed	Connector size	Suction Lift		Shipping Weight
	PSIG	(bar)	GPH	(L/H)	rpm	in	ft	(m)	lbs (kg)
DULCO flex Control (DFXa)									
0730	101.5	(7)	7.92	(30)	100	1/2" x 3/8"	16.4	(5)	12.8 (5.8)
0530	72.5	(5)	7.92	(30)	100	1/2" x 3/8"	16.4	(5)	12.8 (5.8)

Tube material:TPV (Santoprene): available with pump versions 0730 and 0530

.....PUR (Polyurethane): available with pump version 0530 only

Tube connectors:.....PVDF/PTFE

Metering reproducibility:.....±2% with retracted tube (after approx. 200 revolutions)

Turndown:3,000:1

Electrical connection:100 - 230 V ±10%, 50/60 Hz

Nominal power:.....approx. 45 W

Degree of protection:IP 66, NEMA 4X Indoor

Permissible ambient temperature:14 - 113 °F

Optional relay modules:1 x switch over contact, 230 V – 8 A or 2 x On, 24 V – 100 mA

Capacity data represents minimum values, tested using water at 68 °F (room temperature)

Dimensional Drawing

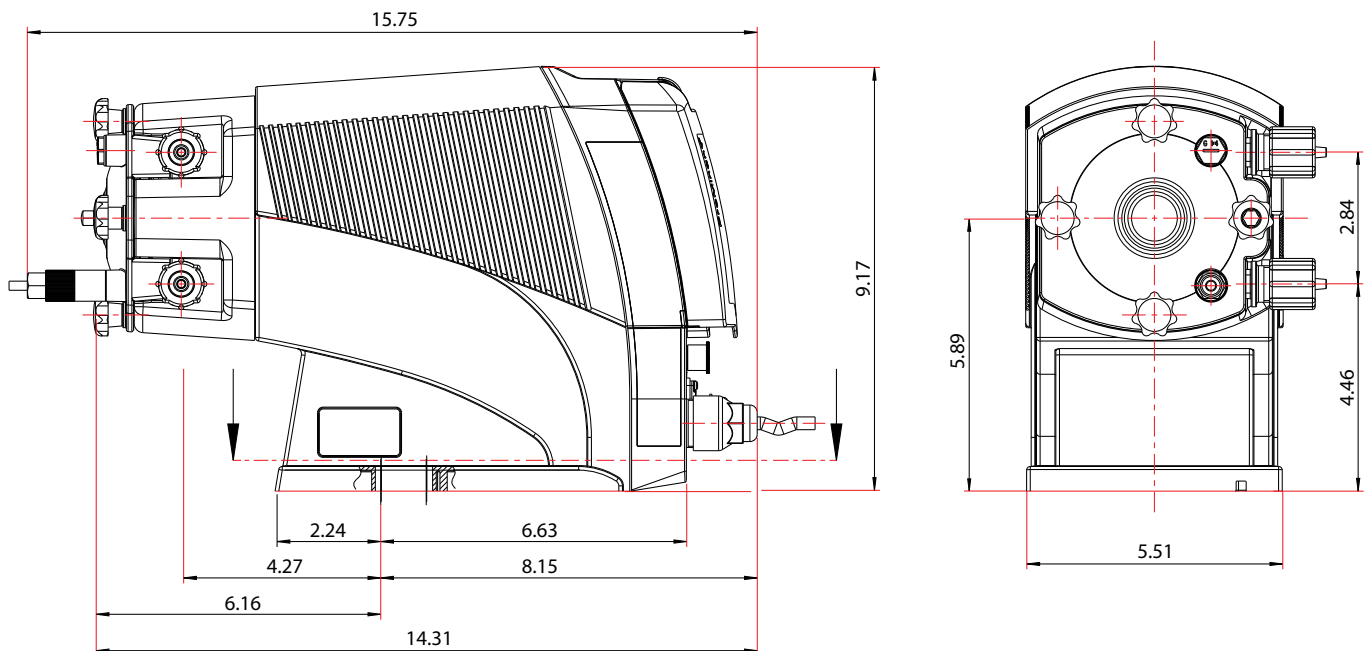

Note: All above measurements are in inches

© 2019 ProMinent Fluid Controls, Inc. • All Rights Reserved • PN: 7750018 • DULCO_flex_Control.indd rev5 • 1/2/2020