

SERIES 215 SIGHT FLOW INDICATORS

CLASS 150 FLANGED CONNECTION / WINDOW TYPE
 CONSTRUCTION: CARBON STEEL, 316 STAINLESS STEEL OR PVC
 NEOPRENE SEAL GASKETS AS STANDARD

CARBON STEEL OR 316 STAINLESS STEEL

Plain, Ball Action, Flapper, Drip Tube or Rotating Wheel

Pressure Rating:

Furnished with Tempered glass: 200 PSI
 (*PVC 100 PSI with Tempered glass @ 75°F)

Temperature Rating:

Up to 500°F depending on glass and gasket selection

Flange Connections:

- Raised Face: Carbon Steel, 316 Stainless Steel
- Flat Face: PVC

*NOTE: PVC only available in Model EFI 215-P, or 215-B.

PTFE gaskets standard with PVC.

Consult Ernst Flow Industries for PVC dimensions and weights.



MODEL EFI 215-P
(Plain)



MODEL EFI 215-R
(Rynite® Rotating Wheel)

CARBON STEEL OR 316 STAINLESS STEEL				
Flange Size	Dimensions in Inches			Approx. Weight (lbs.)
	A	B	C	
1	7	1-3/4	4-1/4	10
1-1/2	7-1/4	1-3/4	5	13
2	9	3	6	21
2-1/2	9	3	7	27
3	9-1/4	3	7-1/2	32
4	9-1/4	3	9	42
6	9-1/4	3	11	53

MODEL EFI 215-P
(Ball Action)

not shown... specify ball material

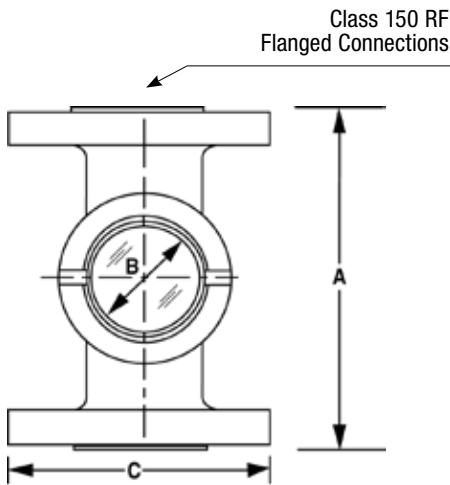

MODEL EFI 215-F
(Rynite® Flapper)

Not recommended for downward flow



MODEL EFI 215-D
(Drip Tube)