

# SERIES 2000 SIGHT FLOW INDICATORS

THREADED CONNECTION / WINDOW TYPE

CONSTRUCTION: CARBON STEEL OR 316 STAINLESS STEEL

**PRESSURE RATING: CLASS 150 OR CLASS 300**

**FEATURES:**

- Full ASME rated
- Independent glass retainer bolting contributes to ease and added safety to field maintenance and replacement procedures
- Investment Castings
- Tempered borosilicate glass standard in all units
- Gylon® 3504 gasketing standard in all units
- Acrylic enamel coating on bodies and cover plates (all carbon steel models)
- Cast steel glass retainers standard on all carbon steel models
- Stainless steel glass retainers standard on all stainless steel models
- All units 100% Hydrostatic pressure tested
- Other alloys of construction are available upon request.

*Optional gasket materials: Available upon request.*

Class 150 Threaded Units				
NPT Conn.	Dimensions in Inches			Approx. Weight (lbs.)
	A	B	C	
1/2	3-3/4	1-1/4	3-7/8	6
3/4	3-3/4	1-1/4	3-7/8	6
1	4-1/4	1-1/4	4-1/8	11
1-1/2	5-1/2	1-3/4	5-3/8	12
2	6-1/4	2	6-1/8	17

Class 300 Threaded Units				
NPT Conn.	Dimensions in Inches			Approx. Weight (lbs.)
	A	B	C	
1/2	3-3/4	1-1/4	4	7
3/4	3-3/4	1-1/4	4	7
1	4-1/4	1-1/4	4-1/2	13
1-1/2	5-1/2	1-3/4	5-7/8	14
2	6-1/4	2	6-3/8	20

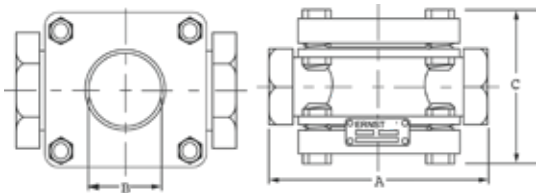

Every indicator has a stainless steel tag riveted to the body for easy identification of size, psi, temperature rating and model. (Example shown above)



## PLAIN

**MODEL EFI 20-00-T**

These units show system flow visually without the use of internal indicators. They will operate effectively in any position to detect either the presence or absence of solutions, or to observe fluids for turbulence, color or clarity.

## DRIP TUBE

**MODEL EFI 20-10-T**

These models have a drip tube on the media entry end in order to pass low or intermittent flow directly into the viewing area. They have no obstructions and are best adapted for downward vertical flow.



## FLAPPER

**MODEL EFI 20-20-T**

These units must be installed with the flow in the direction of the arrow on the body casting. These models have a hinged flap visible through the viewing window that indicates changes in flow rates by the position of the flap. They are best suited for flow indication of transparent or slightly opaque solutions. They may be used with horizontal and upward vertical flows.

## ROTOR

**MODEL EFI 20-30-T**

A PTFE rotor spins to indicate flow in this type unit. Flow indication at a great distance is possible with dark as well as transparent flow. These indicators can be mounted horizontally or vertically.



# SERIES 2000 SIGHT FLOW INDICATORS

FLANGED CONNECTION / WINDOW TYPE

CONSTRUCTION: CARBON STEEL OR 316 STAINLESS STEEL

**PRESSURE RATING: CLASS 150 OR CLASS 300**

**FEATURES:**

- Full ASME rated
- Independent glass retainer bolting contributes to ease and added safety to field maintenance and replacement procedures
- Investment Castings
- Tempered borosilicate glass standard in all units
- Gylon® 3504 gasketing standard in all units
- Acrylic enamel coating on bodies and cover plates (all carbon steel models)
- Cast steel glass retainers standard on all carbon steel models
- Stainless steel glass retainers standard on all stainless steel models
- All units 100% Hydrostatic pressure tested
- Other alloys of construction are available upon request.

*Optional gasket materials: Available upon request.*

Class 150 Flanged Units					
Flange Size	Dimensions in Inches				Approx. Weight (lbs.)
	A	B	C	D	
1/2	4-5/8	1-1/4	4-3/16	3-1/2	6
3/4	4-5/8	1-1/4	4-3/16	3-7/8	6
1	5-5/8	1-1/4	4-1/8	4-1/4	11
1-1/2	6-1/2	1-3/4	5-3/8	5	17
2	7-7/8	2	6-1/8	6	27
3	9-3/8	3-3/16	7-3/4	7-1/2	56
4	11	4-3/8	10-5/8	9	75
6	14-1/4	6-7/8	12-3/4	11	150

Class 300 Flanged Units					
Flange Size	Dimensions in Inches				Approx. Weight (lbs.)
	A	B	C	D	
1/2	5-7/8	1-1/4	4-3/16	3-3/4	9
3/4	5-7/8	1-1/4	4-3/16	4-5/8	9
1	6-7/8	1-1/4	4-1/2	4-7/8	12
1-1/2	7-1/2	1-3/4	5-7/8	6-1/8	19
2	8-5/8	2	6-3/8	6-1/2	30
3	11-3/8	3-3/16	8-3/8	8-1/4	62
4	13-1/4	4-3/8	12-1/4	10	84

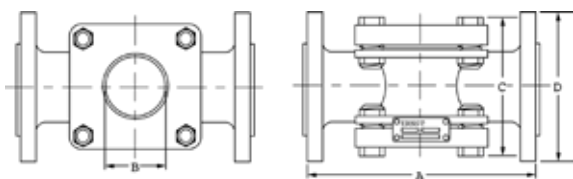

Every indicator has a stainless steel tag riveted to the body for easy identification of size, psi, temperature rating and model. (Example shown above)

## PLAIN

### MODEL EFI 20-40-F

These units show system flow visually without the use of internal indicators. They will operate effectively in any position.



## DRIP TUBE

### MODEL EFI 20-50-F

These models have a drip tube on the media entry end in order to pass low or intermittent flow directly into the viewing area. They have no obstructions and are best adapted for downward vertical flow.

## FLAPPER

### MODEL EFI 20-60-F

These units must be installed with the flow in the direction of the arrow on the body casting. These models have a hinged flap visible through the viewing window that indicates changes in flow rates by the position of the flap. They are best suited for flow indication of transparent or slightly opaque solutions. They may be used with horizontal and upward vertical flows.



## ROTOR

### MODEL EFI 20-70-F

A PTFE rotor spins to indicate flow in this type unit. Flow indication at a great distance is possible with dark as well as transparent flow. These indicators can be mounted horizontally or vertically.



PFA Lined EFI Series 2000 Flanged units now available for corrosive applications. Available 1" through 8" sizes. Contact Ernst Flow Industries for details.