

# SERIES 1400 SIGHT FLOW INDICATORS

NPT THREADED CONNECTION / WINDOW TYPE

CONSTRUCTION: BRONZE, CARBON STEEL OR 316 STAINLESS STEEL

FKM (Viton™) SEAL GASKETS AS STANDARD

## PLAIN

Pressure Rating: 200 PSI\*;  
400 PSI with tempered glass\*\*

When the color and clarity of your liquids are of prime importance.



**MODEL**  
EFI 1420 Carbon Steel  
EFI 1430 Bronze  
EFI 1470 316 Stainless Steel  
EFI 1480 Ductile Iron

## FLAPPER

Pressure Rating: 200 PSI\*;  
400 PSI with tempered glass\*\*

These units must be installed with the flow in the direction of the arrow on the body casting. These models have a hinged flap visible through the viewing window that indicates changes in flow rates by the position of the flap. They are best suited for flow indication of transparent or slightly opaque solutions. They may be used with horizontal and upward vertical flows.



**MODEL**  
EFI 1422 Carbon Steel  
EFI 1432 Bronze  
EFI 1472 316 Stainless Steel  
EFI 1482 Ductile Iron

## ROTATING DELRIN® WHEEL

Pressure Rating: 200 PSI\*;  
400 PSI with tempered glass\*\*

The best way to show flow of opaque liquids... also ideal for observations at a distance. Flow from right to left is standard. Specify if left to right flow is required.

**NOTE:** Ryton® Wheel furnished for 400 PSI rating

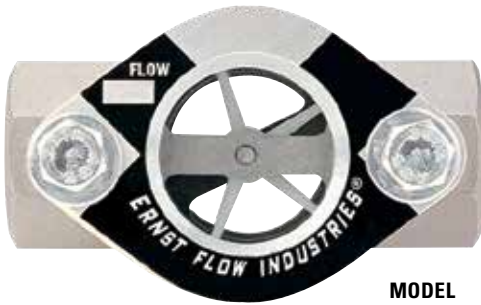

**MODEL**  
EFI 1421 Carbon Steel  
EFI 1431 Bronze  
EFI 1471 316 Stainless Steel  
EFI 1481 Ductile Iron

## DRIP TUBE

Pressure Rating: 200 PSI\*;  
400 PSI with tempered glass\*\*

Ideal for gravity, extremely low or intermittent flow, keeps product from dripping on glass... assures constant see-through vision. Recommended for vertical downward flow.



**MODEL**  
EFI 1423 Carbon Steel  
EFI 1433 Bronze  
EFI 1473 316 Stainless Steel  
EFI 1483 Ductile Iron

**NOTE:** 400 PSI rated units are furnished with an extra-heavy cover in addition to the tempered glass. Tempered glass should not be used with 200 PSI rated units.

CONN. SIZE 1/4" TO 1" WITH 2 - BOLT GLASS RETAINING COVER  
CONN. SIZE 1-1/4" TO 2" WITH 4 - BOLT GLASS RETAINING COVER

\*200 PSI @ 150°F;  
135 PSI @ 250°F

\*\*400 PSI @ 150°F;  
200 PSI @ 350°F

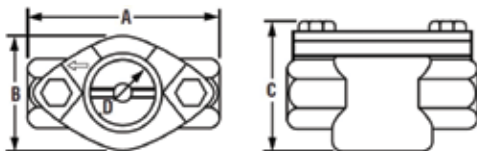

	NPT Connection (Dimensions in Inches)							
	1/4	3/8	1/2	3/4	1	1-1/4	1-1/2	2
A Over-all Length	3-1/4 <sup>1</sup>	3-1/4 <sup>1</sup>	3-1/4 <sup>1</sup>	4-1/4 <sup>2</sup>	4-1/4	5-1/4 <sup>3</sup>	5-1/4 <sup>3</sup>	5-1/2 <sup>3</sup>
B Over-all Width	2	2	2	2-9/16	2-9/16	3-5/16	3-5/16	3-5/16
C Over-all Height	2-3/8	2-3/8	2-3/8	3-1/4	3-1/4	4-5/16	4-5/16	4-5/16
Over-all Height w/ Tempered Glass	2-9/16	2-9/16	2-9/16	3-7/16	3-7/16	4-1/2	4-1/2	4-1/2
D Diameter of Sight Opening	1-1/8	1-1/8	1-1/8	1-1/2	1-1/2	2	2	2
Approx. Weight (lbs.)	1.6	1.6	1.4	3.0	2.7	8.4	7.9	6.6

1. Stainless Steel Units are 3-5/8" 2. Bronze Units are 4-1/8" 3. Stainless Steel Units are 5-5/8"

# SERIES 1400 SIGHT FLOW INDICATORS

CLASS 150 FLANGE CONNECTION / WINDOW TYPE  
 CONSTRUCTION: CARBON STEEL OR 316 STAINLESS STEEL  
 FKM (Viton™) SEAL GASKETS AS STANDARD



## PLAIN

Pressure Rating:  
 200 PSI\*;  
 275 PSI with tempered glass\*\*

When the color and clarity of your liquids are of prime importance.

MODEL  
 EFI 1420-F Carbon Steel  
 EFI 1470-F Stainless Steel

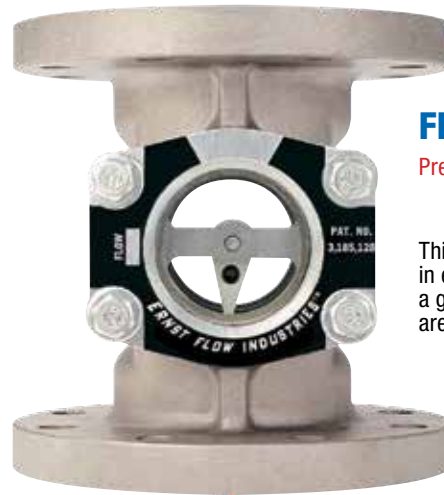

## FLAPPER

Pressure Rating:  
 200 PSI\*;  
 275 PSI with tempered glass\*\*

This bi-directional indicator points in either direction to show you at a glance which way your liquids are flowing.

MODEL  
 EFI 1422-F Carbon Steel  
 EFI 1472-F Stainless Steel

## ROTATING DELRIN® WHEEL

Pressure Rating: 200 PSI\*;  
 275 PSI with tempered glass\*\*

The best way to show flow of opaque liquids... also ideal for observations at a distance. Flow from right to left is standard. Specify if left to right flow is required.

NOTE: Ryton® Wheel furnished for 275 PSI rating

## DRIP TUBE

Pressure Rating: 200 PSI\*;  
 275 PSI with tempered glass\*\*

Ideal for gravity, extremely low or intermittent flow, keeps product from dripping on glass... assures constant see-through vision. Recommended for vertical downward flow.



MODEL  
 EFI 1421-F Carbon Steel  
 EFI 1471-F Stainless Steel



MODEL  
 EFI 1423-F Carbon Steel  
 EFI 1473-F Stainless Steel

	Flanged Connection (Dimensions in Inches)				
	1	1-1/2	2	3	4
A Over-all Length	5	6-1/2	7	8	9
B Dia. of Sight Opening	1-1/2	2	2	3	3
C Flange Diameter	4-1/4	5	6	7-1/2	9
D Bolt Circle Diameter	3-1/8	3-7/8	4-3/4	6	7-1/2
E No. Bolt Holes & Size	(4)5/8	(4)5/8	(4)3/4	(4)3/4	(8)3/4
F Dia. of Raised Face	2	2-7/8	3-5/8	5	6-3/16
G Thickness of Flange	15/32	19/32	11/16	13/16	1
Approx. Weight (lbs.)	5.4	11.1	15	29.3	35

NOTE: Optional O/A lengths also available for the following flanged connections:

Size	O/A Length
2"	7-7/8"
3"	9-3/8"
4"	11"

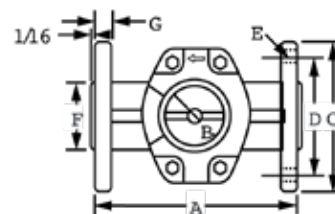

NOTE: 275 PSI rated units are furnished with an extra-heavy cover in addition to the tempered glass. Tempered glass should not be used with 200 PSI rated units.

FLANGE SIZE 1" FURNISHED WITH 2 - BOLT GLASS RETAINING COVER  
 FLANGE SIZE 1-1/2" TO 4" WITH 4 - BOLT GLASS RETAINING COVER

\*200 PSI @ 150°F; 135 PSI @ 250°F  
 \*\*Stainless Steel units rated at 275 PSI @ 100°F; 205 PSI @ 350°F  
 Steel units rated at 285 PSI @ 100°F; 215 PSI @ 350°F

Note: For connections 6" through 12", inquire with factory.