

# TANK BOTTOM DIAPHRAGM VALVE

## Manual or Pneumatically Actuated Vessel Outlet Valve

Tank bottom diaphragm valves are sterile vessel outlet valves. They are designed for use at the bottom vessels to enable draining of process fluids while minimizing dead leg to prevent waste entrapment and contamination from bacteria or microorganisms.

## SPECIFICATIONS AND FEATURES\*

### Connection Size:

- » Standard Valve: 1/2" - 4" (DN15 - DN100)

### Outlet Connection Type:

- » Standard Valve: Tri-clamp, Extended Tube End

### Additional Ports or Tandem Access Valve:

- » As special Option

### Materials:

- » Standard: Barstock, ASME SA479 316L (UNS 31603) or EN 10272:2000 GR 1.4435
- » Optional: AL-6XN®, Hastelloy® C-22 and others readily available

### Surface Finish:

- » Wetted Interior:
  - Standard:
    - ASME BPE SF1, 20 Ra  $\mu\text{m}$  (0,5 Ra  $\mu\text{m}$ )
    - ASME BPE SF5, 20 Ra  $\mu\text{m}$  (0,5 Ra  $\mu\text{m}$ ) Electropolish
  - Optional:
    - ASME BPE SF4, 15 Ra  $\mu\text{m}$  (0,4 Ra  $\mu\text{m}$ ) Electropolish. Better finish upon request.
- » Exterior:
  - Optional: 40 Ra  $\mu\text{m}$  (1,0 Ra  $\mu\text{m}$ ) and better upon request

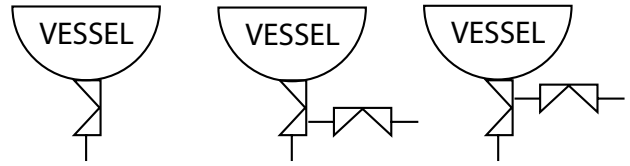

## APPLICATIONS

Manual or Air Actuated Outlet Valve for sterile vessel

- » Upstream:
  - Bioreactor/Fermenter: vessels
  - Perfused Bioreactors: Retentate or permeate vessels
- » Downstream:
  - Outlet valve for process vessels in the following production areas:
    - Separation
    - Filtration
    - Chromatography
    - Formulation
    - Fill Finish

\* See page 6 & 7 for GENERAL FEATURES, GENERAL SPECIFICATIONS regarding features and specifications that apply to all valves

## DIMENSIONS (TANK BOTTOM DIAPHRAGM VALVE)

INCHES				
SIZE	A	B	C	D
1/2"	3.0	0.5	According to BPE or as specified	
3/4"	3.5	0.5		
1"	4.5	0.5		
1-1/2"	5.5	0.56		
2"	7.0	0.5		
2-1/2"	9.0	0.75		
3"	10.0	0.75		
4"	14.0	1.0		

METRIC				
SIZE	A	B	C	D
DN15	76,2	12,7	According to BPE or as specified	
DN20	88,9	12,7		
DN32	114,3	12,7		
DN40	139,7	14,2		
DN50	177,8	12,7		
DN65	228,6	19,1		
DN80	254,0	19,1		
DN100	355,6	25,4		

1/2" - 4" (DN15-DN100)

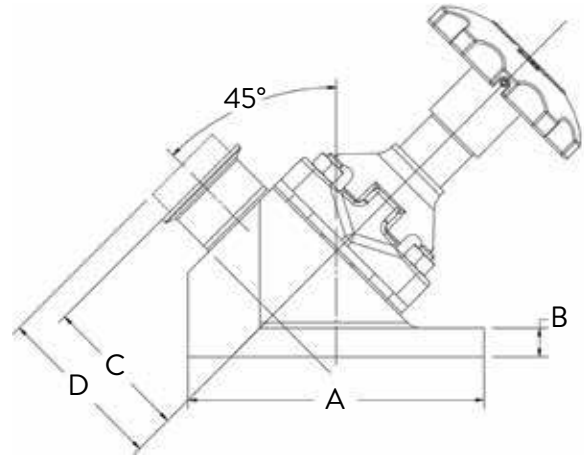

Please Contact Factory for special vessel connection sizes or valve configurations. All queries are welcome.

## ORDERING SCHEMATIC (TANK BOTTOM DIAPHRAGM VALVE)

MODEL	TYPE	SIZE	CONNECTION	FINISH	ACTUATION	DIAPHRAGM	ACCESSORIES
SV							

1	TYPE
6	Tank Bottom Valve

2	SIZE
4	1/2"
5	3/4"
6	1"
7	1-1/2"
8	2"
9	2-1/2"
A	3"
B	4"

3	CONNECTION
1	OD Tube
2	Clamp
Z	Non-standard

4	FINISH
1	SF1 20Ra
2	SF4 15Ra EP
3	SF5 20Ra
Z	Non-standard, consult factory

5	ACTUATION
1	Manual
2	Manual Vented
3	Spring to Close
4	Spring to Open
5	Double Acting
6	Eclipse, Spring to Close (1/2" - 2" standard)
7	Eclipse, Spring to Open (1/2" - 2" standard)

6	DIAPHRAGM
1	EPDM
2	TFM/EPDM
Z	Non-standard

7	ACCESSORIES
1	Switch 2 Position
2	Positioner 4-20 mA
Z	Non-standard, consult factory