



All of our advanced interior accessories have been designed to enhance the functional or aesthetic aspects of our furniture systems. Each one has been built to our exact standards for quality, reliability and durability to provide years of trouble-free operation.



PRO RACK

Integration of professional equipment, conforming to EIA 19" rack standards



STORAGE

Solidly built, multifunctional pull-out shelves and infinitely adjustable shelves



VENTILATION

Active cooling system protects electronics

CABINETS / PRO RACK

- 1 Frame
- 2 Style
- 3 Display
- 4 Interiors
- 5 Accessories

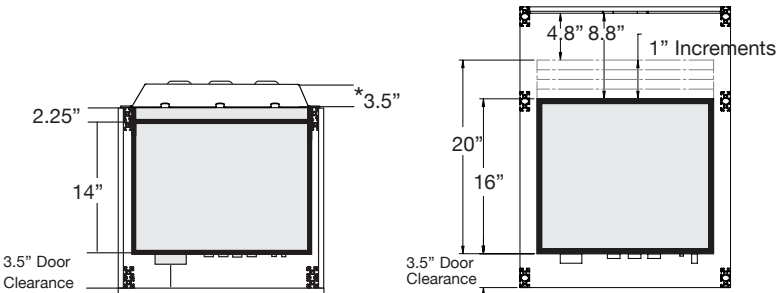

* When using optional Extended Rear Panel.



Pull-Out Rack Cartridge

- Pull-out 19" standard rack with rails front and back
- Cabinet guide rails and in-line caster base provide simple use and transport
- Weight capacity of 200 lb
- Heavy duty bearing wheels for easy installation, removal, and manoeuvring of full equipment racks during service
- Rugged 12-gage powder coated steel construction
- Flexible wire management wire loom allows for removal of rack from cabinet with 360 degrees of access to components without disconnecting from cabinet. An absolute step up from slide out and rotational racks service constraints.
- Tool-less removal / installation for service

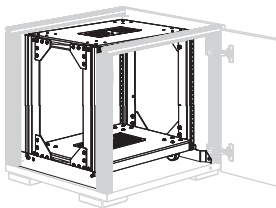

FI/C20/CRK/B
7-U Pull-Out Rack Cartridge
Kit for 20"H Cabinets

Not Adjustable

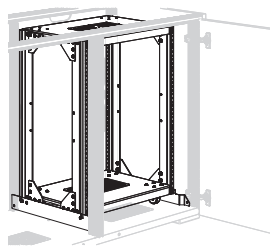

FI/C30/CRK/B
13-U Pull-Out Rack Cartridge
Kit for 30"H Cabinets

Not Adjustable

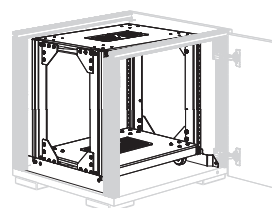

FI/C20/CRK/A
7-U, Adjustable Depth
Pull-Out Rack Cartridge

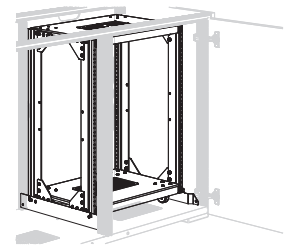

FI/C30/CRK/A
13-U, Adjustable Depth
Pull-Out Rack Cartridge

- Adjustable in 1" increments from 16 to 20".
- Use with Deep Profile Cabinets to take advantage of the full range of adjustability.
- Can be used in a 21"D cabinets (from 16 – 18" range) with an extended rear panel.

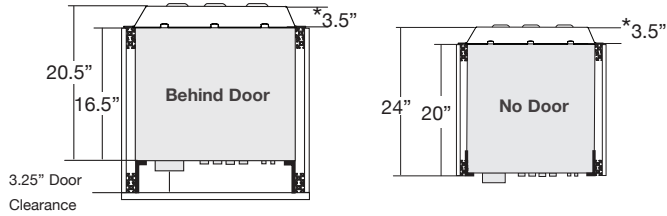

Rack Rail Kits

- Universal holes are spaced on consecutive intervals of 5/8" and 1/2" allowing for mounting of equipment with attachment holes either wide or universally spaced
- Threaded for 10-32 screws. Black powder coated steel
- Rack Rail sets (2) may be attached to front or rear of the cabinet and are reversible for use without doors (diagram above)
- Rails are compatible with all industry standard 19" components and accessories

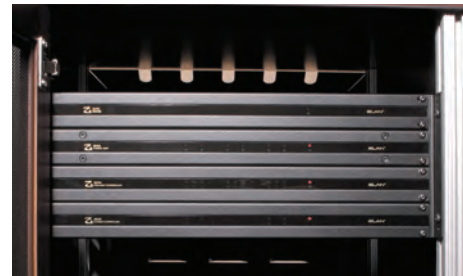

Component-Length Rack Rails

FI/RM4U	4-U Rack Rails, 7"H
FI/RM3U	3-U Rack Rails, 5.25"H
FI/RM2U	2-U Rack Rails, 3.6"H

- Attaches to front or rear cabinet posts
- Doors can be used with component length rails, placed away from hinges
- Allow for 1.5" clearance for each hinge
- Includes two, black, powder coated rails per set. Threaded for 10-32 screws.

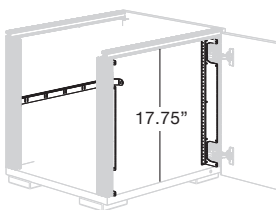

FI/C20/RMK/A
Pro Rack Rails 20A Kit

- (1) 10-U Rack Rails
- (1) Wire Lacing Bar

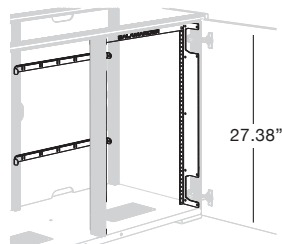

FI/C30/RMK/A
Pro Rack Rails 30A Kit

- (1) 15-U Rack Rails
- (2) Wire Lacing Bar

CABINETS / PRO RACK ACCESSORIES

- 1 Frame
- 2 Style
- 3 Display
- 4 Interiors
- 5 Accessories



Wire Lacing Bars for Cartridge

RM/LB2	Pull-Out Rack Cartridge Lacing Bar, Set of 2
---------------	---

- Mounts to Rack Cartridge and any 19" standard rack
- Infinitely adjustable wire management
- Includes one velcro wrap strap
- Black powder coated steel



Wire Lacing Bar Kit

FI/RMLB	Cabinet Mounted Wire Lacing Bar Kit, Set of 3
----------------	--

- Mounts to vertical cabinet posts
- Black powder coated steel
- Set of 3 lacing bars



Vertical Racks

FI/RM/VR/3U	Vertical Rack Mount, 3U
FI/RM/VR/5U	Vertical Rack Mount, 5U

- Rack is mounted to cabinet frame or wall, for industry standard 19" pro audio rack mounting
- 3 and 5 rack units of vertical mounted, knob up component storage
- Threaded for 10-32 screws
- Black powder coated steel
- Lift and load design for easy install



Power Distribution Unit

SA/RM/PDU	Power Distribution Unit, 9 Outlets
------------------	---

- Multi-port rack mounted Power Distribution Unit with surge protection
- 8 Rear Ports, 1 Front Port
- Maximum Output Current: 15 Amps
- See full specs on page 33
- USA Compatibility
- Premium quality Furman brand



Vented Shelves

Face Plates

RM/VS2U	Vented Shelf, 2U - 14"D
RM/VS3U	Vented Shelf, 3U - 14"D
RM/VS4U	Vented Shelf, 4U - 14"D

RM/VFP1U	Vented Face Plate, 1U
RM/VFP2U	Vented Face Plate, 2U
RM/VFP3U	Vented Face Plate, 3U
RM/VFP4U	Vented Face Plate, 4U

- Mounts to Pull-Out Rack Cartridge and any 19" standard rack
- 19" EIA standard rack mount, 14" deep, vented shelf
- Black powder coated steel

- Mounts to Pull-Out Rack Cartridge and any 19" standard rack
- Black powder coated steel
- Perforated 16ga steel for component air flow (allows 62% free air flow)

CABINETS / INTERIOR STORAGE

- 1 Frame
- 2 Style
- 3 Display
- 4 Interiors
- 5 Accessories

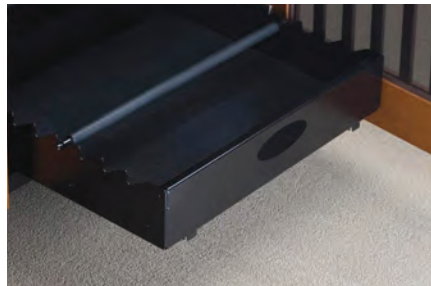

Drawers

- Interior Dimensions: 18"W x 6.75"H x 15.75"D
- Load Capacity: 100 lbs

3" Drawer

- Metal construction, matte black finish
- Interior: 17.125"W x 15.875"D x 3.5"H
- Maximum Weight Capacity: 30 lbs

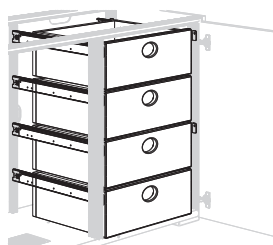

**FI/C30/IDK/A
Drawers 30A Kit**

(4) 6" Drawers

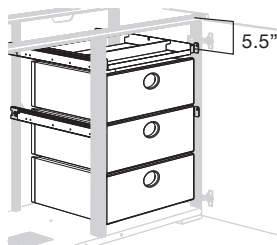

**FI/C30/IDK/B
Drawers 30B Kit**

(1) Pull-Out Storage Tray
(3) 6" Drawers

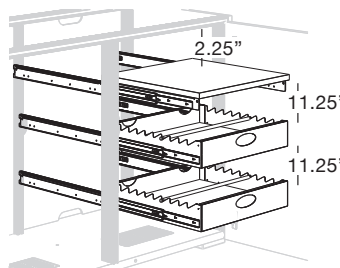

**FI/C30/SLK/C
Shelving 30C Kit**

(1) Pull-Out Shelf
(2) 3" Drawers

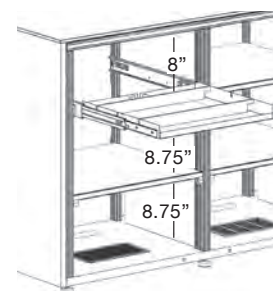

**FI/C30/SLK/D
Shelving 30D Kit**

(1) Pull-Out Tray
(1) Adjustable Shelf

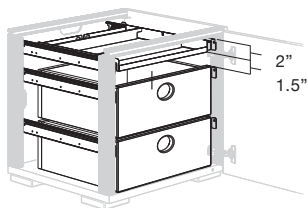

**FI/C20/IDK/B
Drawers 20B Kit**

(1) Pull-Out Storage Tray
(2) 6" Drawers

All shelf and drawer positions are fully adjustable.
Dimensions shown are factory assembled locations.

INTERIOR STORAGE / CABINETS

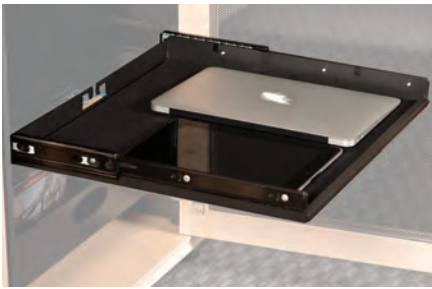

Pull-Out Storage Tray

- Utilizes heavy duty ball bearing slides
- Black steel body with felt liner
- Maximum Weight Capacity: 50 lbs
- 17.25" W (438 mm) x 16" D (406 mm) x 1.625" H (42 mm)
- 2 dividers located at 4" 8.5" and 12.75" from the front edge



Adjustable Shelves

- Fully adjustable
- Matte black, powder-coated MDF
- Weight Capacity: 75 lbs (34 kgs)
- 19.68"W (502 mm) x 17.5"D (445 mm) x .625"TH (16 mm)

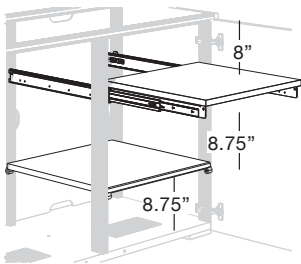

**FI/C30/SLK/B
Shelving 30B Kit**

- (1) Pull-Out Shelf
- (1) Standard Shelf

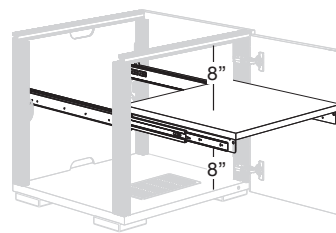

**FI/C20/SLK/B
Shelving 20B Kit**

- (1) Pull-Out Shelf

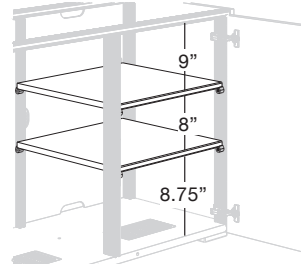

**FI/C30/SLK/A
Shelving 30A Kit**

- (2) Standard Shelf

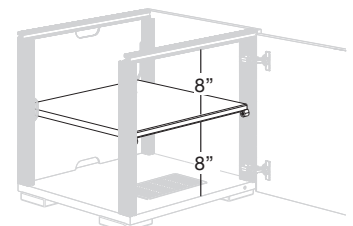

**FI/C20/SLK/A
Shelving 20A Kit**

- (1) Standard Shelf

Adjustable Trays

- Compatible with Low Profile Cabinets only
- 19.75"W (502mm) x 7.875"D (200mm) x 1.5"H (38mm)
- Maximum Weight Capacity of 30 lbs (13.6 kgs)
- Constructed of 1/2" (12mm) MDF
- Shelves can be used flat or add a backstop or two to convert shelves to adjustable trays



**FI/C30DI/SLK/A
Shelving 30A Kit**

- (2) Standard Shelves
- (4) Shelf Stops



CABINETS / INTERIORS

- 1 Frame
- 2 Style
- 3 Display
- 4 Interiors
- 5 Accessories



File Storage

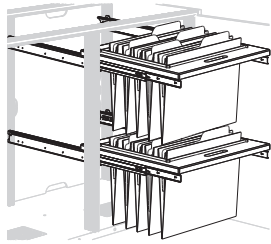

FI/C30/FSK/A
File Storage 30A Kit

- (2) Hanging File

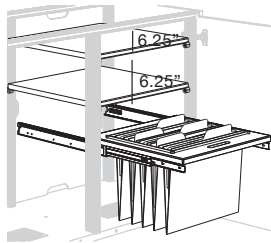

FI/C30/FSK/B
File Storage 30B Kit

- (2) Standard Shelves
- (1) Hanging File

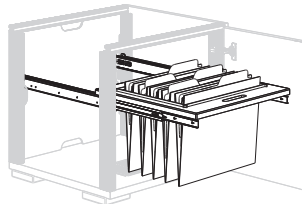

FI/C20/FSK/A
File Storage 20A Kit

- (1) Hanging File



Waste Bins

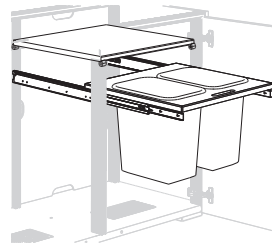

FI/C30/TRK/A
Waste Receptacles 30A Kit

- (1) Pull-Out Trash & Recycling Bin
- (1) Shelf

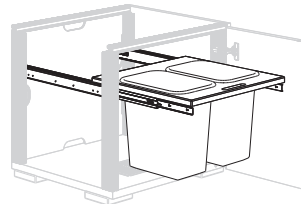

FI/C20/TRK/A
Waste Receptacles 20A Kit

- (1) Pull-Out Trash & Recycling Bin

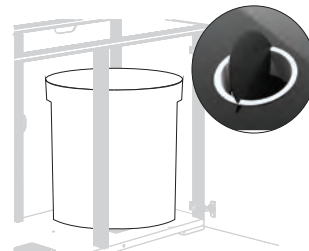

FI/C30/TRK/B
Waste Receptacle 30B Kit

- Top Shelf Grommet Cut-Out
- (1) Trash Bin



Refrigeration

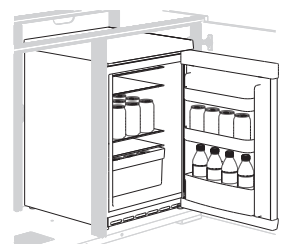

FI/C30/RGK/A
Refrigeration 30A

- (1) Refrigerator

- Built into a cabinet bay and hidden
- 2.5 Cubic feet capacity
- Factory Installed
- USA Compatible

ACTIVE COOLING & REARS / CABINETS



Standard Active Cooling Rears

FI/AC20	Active Cooling Rear Panel for 20"H Cabinets
FI/AC30	Active Cooling Rear Panel for 30"H Cabinets

- Exhaust fan vents warm air. (Air Flow: 26 CFM)
- Thermostatically controlled cooling system turns on at approx 80° F, maximum speed is reached at 95° F.
- Quiet (22 dBA) dual 120mm fans
- Power consumption: 1W in standby mode; 4 W in mid speed; 8-10 W in full speed
- Thermistor: Remote with 20" lead
- USA Compatible
- Export Version Available



Extended Active Cooling Rears

FI/XR20/AC	Extended, Active Cooling Rear Panel for 20"H Cabinets
FI/XR30/AC	Extended, Active Cooling Rear Panel for 30"H Cabinets

- Exhaust fan vents warm air. (Air Flow: 26 CFM)
- Thermostatically controlled cooling system turns on at approx 80° F, maximum speed is reached at 95° F.
- Quiet (22 dBA) dual 120mm fans
- Power consumption: 1W in standby mode; 4 W in mid speed; 8-10 W in full speed
- Thermistor: Remote with 20" lead
- Adds 3.5" to inside depth of cabinet, extending to 23.5"
- Constructed of heavy-weight black powder-coated steel
- USA Compatible
- Export Version Available



Standard Rears

203-720	Standard Rear Panel for 20"H Cabinets
203-730	Standard Rear Panel for 30"H Cabinets

- Easy access, pinch-out panels



Extended Rears

FI/XR20	Extended Rear Panel for 20"H Cabinets
FI/XR30	Extended Rear Panel for 30"H Cabinets

- Adds 3.5" to inside depth of cabinet, extending to 23.5"
- Constructed of heavy-weight black powder-coated steel



Locking Rears

FI/C30/LRP	Locking Rear Panel for 30"H Cabinets
-------------------	---



- USA Compatible
- Export Version Available

Bottom Vent Active Cooling

FI/BVAC	Bottom Vent Active Cooling
----------------	-----------------------------------

CABINETS / SPEAKER INTEGRATION

- 1 Frame
- 2 Style
- 3 Display
- 4 Interiors
- 5 **Accessories**

Salamander's cabinets feature quality craftsmanship and high-fidelity sound by Leon Speakers. Each speaker is hand-crafted and built-to-order to fit seamlessly into our cabinets. Each speaker features world-class Peerless woofers and cloth-dome tweeters, creating a high-fidelity system with exceptional sonic clarity.

- Custom built to seamlessly integrate with cabinets
- Exclusive mounting brackets allow for articulation to optimize sound dispersion
- High-performance sound platform, world-class woofers and cloth-dome tweeters for exceptional sonic clarity
- Solid MDF construction, meticulously crafted by hand in the USA



Center Channel

FI/SPK1/C	Center Channel, Fits Single-Width Bay
------------------	--

- 5" midrange woofers; 1" audiophile-grade tweeters
- Matte black finish, sealed MDF enclosure with removable, black grill
- Impedance: 8Ω
- Rec. Power: 50–250W
- Maximum Output: 104 dB avg; 110 dB peak
- Coverage: Horiz: 110°; Vert: 140°
- Freq. Response: 74–22kHz (+/- 3dB)
- Sensitivity: 88dB@2.83V/1m
- Connections: 5-way binding post
- Mounting: Includes swivel/tilt bracket, Infinitely adjustable +15° -15°

Soundbar / LCR (Left-Center-Right)

FI/SPK2/C	Soundbar, Fits Double-Width Bay
FI/SPK3/C	Soundbar, Fits Triple-Width Bay

- 5" midrange woofers; 1" audiophile-grade tweeters
- Matte black finish, sealed MDF enclosure with removable, black grill
- Impedance: 6Ω
- Rec. Power: 50–250W
- Maximum Output: 101 dB avg; 110 dB peak
- Coverage: Horiz: 110°; Vert: 140°
- Freq. Response: 74–22kHz (+/- 3dB)
- Sensitivity: 88dB@2.83V/1m
- Connections: 5-way binding post
- Mounting: Includes swivel/tilt bracket, Infinitely adjustable +15° -15°

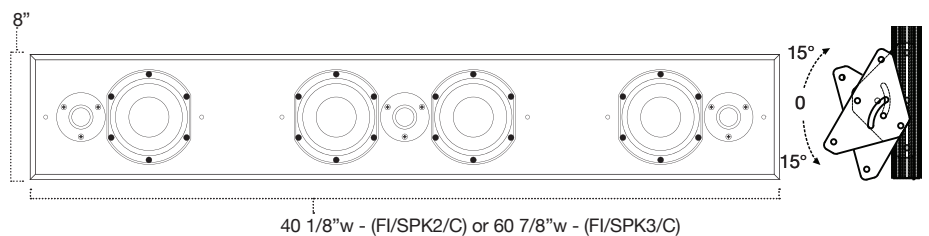
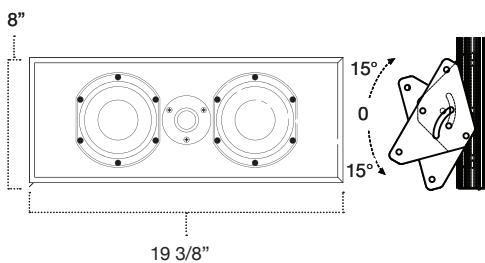



Power Distribution Unit

FI/RM/PDU	Multi-port rack mounted Power Distribution Unit with surge protection.
------------------	--



- 8 Rear Ports, 1 Front Port
- Maximum Output Current: 15 Amps
- Line Cords: 6 ft. captive, 14 AWG, with 3-conductor Edison Plug
- Operating Voltage: 120VAC 60Hz
- Spike Protection Mode: Line to neutral
- Energy Dissipation: 170 Joules
- Peak Impulse Current: 12,000 Amps
- Maximum Continuous Operating Voltage: 130 VAC RMS
- Let Through Voltage (@ 125 amps, 8/20uS waveform): 400 volts
- Noise Attenuation (Transverse Mode):
Greater than 23db, 200Khz to 10MHz
- Dimensions: 1.75" H x 19" W x 3.75" D
- Weight: 4.9 lbs. (2.2 kg)
- Safety Agency Listing: cTUVus
- Three Year Limited Warranty:
Covering defects in materials and workmanship
- USA Compatible
- Premium Furman Brand

Power & USB Ports

FI/PWR/AC	2 AC Power Outlet, Black
FI/PWR/USB	2 USB and 1 AC Power Outlet, Black

- Cable is pre-wired and requires no electrical wiring by the installer
- ETL listed, UL Rated 817D, CSA STD 22.2 42.1-00
- Includes 3ft. Pre-wired Power Cord and Décor Wall Plate
- USA Compatible

Power Receptacle:

- UL Listed Receptacle 351B
- Tamper Resistant
- Power Rating: 15A-125V

USB:

- Save space-no adapter required
- USB Power Rating: 5V DC/CC 700mA
- Indicator light confirms charging status



Power Conditioner

FI/RM/PCK	Power Conditioner Kit with Mounting Bracket
------------------	--

- Includes 8 AC Outlets, 2 CATV connectors, 2 pair of satellite connectors, in/out telco connectors with phone line splitter, 8' power cord, accepts add-on signal line modules.
- 1650 Joules single pulse energy dissipation
- Measures: 12"W x 5"D x 1.7"H
- Lifetime product and \$5 million connected equipment protection provided by Panamax
- Connects to the aluminium frame slot, can be mounted to interior or rear of cabinet
- USA Compatible

CABINETS / PORTS

- 1 Frame
- 2 Style
- 3 Display
- 4 Interiors
- 5 Accessories

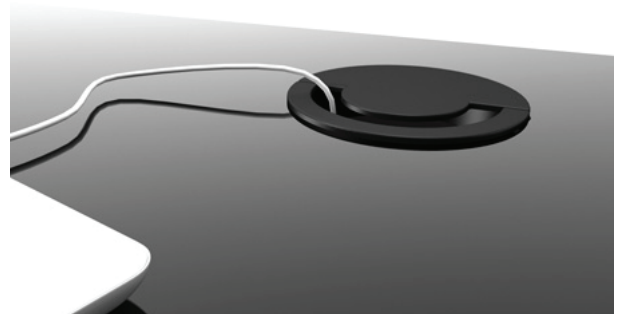

Brush Cable Port

FI/CP1/BK	Rectangular Brush Cable Port, Matte Black
------------------	---

- Opening: 1.3" x 2.63"
- Ports can be installed on cabinet tops, end panels and modesty panels. Call for details

Round Cable Port

FI/CP2/BK	3-3/8" Round Cable Port, Matte Black
FI/CP2/SN	3-3/8" Round Cable Port, Satin Nickel

- 3/8" cable thickness clearance. Splits to fit large ends of wires
- Installed on cabinet tops only. Call for details.

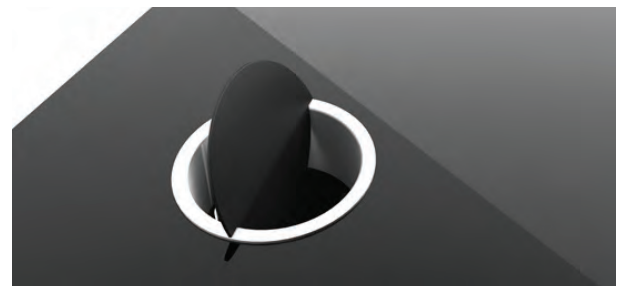

Rectangular Cable Port

FI/CP3/A	Rectangular Brush Cable Port, Satin Aluminum
-----------------	--

- 13 7/8" W x 2 13/16" H
- Ports can be installed on cabinet tops, end panels and modesty panels. Call for details.

Trash Port

FI/TP1/SS * Standard/Deep Profile Cabinet Only	6" Round Trash Port, Satin Stainless Steel
FI/TP1C/BK * Standard/Deep Profile Cabinet Only	Cover for Round Trash Port, Matte Black

- Installed on cabinet tops only. Call for details.



Security Locks

FI/C/DL/	Door Lock - Black (FI/C/DL/BK), Bronze (FI/C/DL/BZ), Nickel (FI/C/DL/NK), White (FI/C/DL/WH)
FI/C30/LRP * Standard/Deep Profile Cabinet Only	Locking Rear Panel for 30"H Cabinets
FI/C/MDL	Invisible Magnetic Door Locks

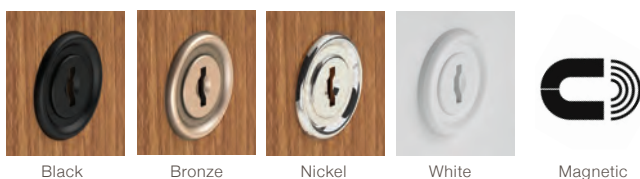

Lighting System

SD/LS2/W	Lighting System with Remote, White LED 15" Bar (Expandable)
SD/LSX15/W	Expansion Lights Bar, 15" White LED, set of 2
SD/LSX24/W	Expansion Lights Bar, 24" White LED, set of 2



IR Repeater System

SD/IR	Salamander All-In-One IR Repeater Kit
SD/IRX2	IR Flasher, Dual-Head Emitter, additional

- Plasma Proof, interference filtering
- Receiver mounting hardware for surface mount and countersink applications
- Measures: 4.25" W x 1" H x 1" D
- Includes: 4 IR Emitters (Expandable to 8), Versatile Mounting Hardware and Wire Manager
- Power Supply Voltage: 110V
- IR Frequency Range: 30kHz-60kHz
- IR Pickup Range: 40ft @38kHz / 25ft @56kHz
- Receiver Wire: 3'
- Emitter Wire: 9.5'
- USA Compatible, Export version available



- LED technology for low energy use, low heat and longer life
- Infrared remote for full dimming and program control
- Adjustable Light temperature from cool white (6500 Kelvin) to warm (3200 Kelvin). LED back-lighting lighting reduces eye-strain.
- Sleep timer, auto-off feature
- Low profile design fits in small spaces
- Power Supply: 110/240V, interchangeable international plugs included
- USA Compatible

CABINETS / FOOTING & WALL MOUNTS

Saturn Wheels



FI/C/4/BK	Set of 4 - Saturn Wheels, Satin Black
FI/C/4	Set of 4 - Saturn Wheels, Satin Chrome
FI/C/6/BK	Set of 6 - Saturn Wheels, Satin Black
FI/C/6	Set of 6 - Saturn Wheels, Satin Chrome
FI/C/8	Set of 8 - Saturn Wheels, Satin Chrome
FI/C/8/BK	Set of 8 - Saturn Wheels, Satin Black

- Adds 3" to cabinet height. 100 lb capacity, each wheel.

Heavy Duty Casters



FI/HDC/4	Set of 4 - Heavy Duty Casters, Black
FI/HDC/6	Set of 6 - Heavy Duty Casters, Black
FI/HDC/8	Set of 8 - Heavy Duty Casters, Black

- Adds 4" to cabinet height. 250 lb capacity, each wheel.

Tube Base



FI/TB/N/B	Tube Base for Twin-Width Cabinet, Black
FI/TB/L/B	Tube Base for Triple-Width Cabinet, Black
FI/TB/Q/B	Tube Base for Quad-Width Cabinet, Black

- Adds 5" to cabinet height. 600 lb capacity.

Wood Block Feet



FI/BF2/4/B	Set of 4 - Black
FI/BF2/4/E	Set of 4 - Espresso
FI/BF2/6/B	Set of 6 - Black
FI/BF2/6/E	Set of 6 - Espresso
FI/BF2/8/B	Set of 8 - Black
FI/BF2/8/E	Set of 8 - Espresso

- Adds 1.25" to cabinet height. 150 lb capacity, each foot.
- Hidden adjustable levers.
- Can be installed on Low Profile Cabinets

Stiletto Feet



FI/SFA/4	Set of 4 - Stiletto Feet, Aluminum
FI/SFB/4	Set of 4 - Stiletto Feet, Black
FI/SFA/6	Set of 6 - Stiletto Feet, Aluminum
FI/SFB/6	Set of 6 - Stiletto Feet, Black
FI/SFA/8	Set of 8 - Stiletto Feet, Aluminum
FI/SFB/8	Set of 8 - Stiletto Feet, Black

- Adds 6" to cabinet height. 150 lb capacity, each foot.

Robot Feet



FI/RFB/4	Set of 4 - Robot Feet, Black
FI/RFB/6	Set of 6 - Robot Feet, Black
FI/RFB/8	Set of 8 - Robot Feet, Black

- Adds 3" to cabinet height. 150 lb capacity, each foot.

Wall Mounting Kit



CU/WK1	Wall Kit for Single-Width Cabinet
CN/WK1	Wall Kit for Twin-Width Cabinet
CL/WK1	Wall Kit for Triple-Width Cabinet
CQ/WK1	Wall Kit for Quad-Width Cabinet

ORDERING FOOTING

Single-Width	Set of 4
Twin-Width	Set of 4
Triple-Width	Set of 8
Quad-Width	Set of 10