

880/880 Plus Performance™ Series

Digital Weight Indicator/Controller



880 Plus Universal

880 Panel Mount

Board Information:
Previous green CPU board is 5.0" wide
Current blue CPU board is 5.5" wide

Standard Features

- LED display, 0.56 in (14 mm), six-digit, 14-segment
- RS-232 or RS-485 serial port
- USB device port connects directly to a PC
- Ethernet TCP/IP polled or continuous
- AC or DC models
- Built-in DIN-rail clips on controller box (panel mount)
- Display and controller can be separated up to 250 ft (panel mount)
- Hardware slot for one option card
- Operator functions through menu key for audit trail, preset tare, accumulator, time & date and setpoints
- Audit trail tracking for configuration and calibration changes. Password protection for user and configuration changes.
- 20 setpoints with latched batch engine or unlatched outputs
- Four onboard digital I/O channels
- Programmable ticket formats up to 1,000 characters for header text, gross, net, accumulator and setpoints
- Local/remote operation
- Multi-range or multi-interval weighing
- Filter settings for light, medium and heavy noise

Options/Accessories

- Metrological hardware sealing kit
- Adapter plate for converting 310 A and 520 panel mounts
- Panel mount kit for universal enclosure
- Truck in/out program for 100 vehicle IDs

Specifications

Power:

Line voltages: 100-240 VAC
Frequency: 50-60 Hz
DC voltages: 12-24 VDC
Power consumption: AC: 15 W, DC: 20 W

Excitation Voltage:

10 VDC, 16 x 350Ω or 32 x 700Ω load cells

Analog Signal Input Range:

-45 mV to 45 mV

Analog Signal Sensitivity:

0.3 μV/graduation minimum at 7.5 Hz;
1.0 μV/graduation recommended

A/D Sample Rate:

7.5 to 960 Hz, software selectable

Resolution:

Internal: 8 million counts/8,000,000 23 bit
Display: 999,999

System Linearity:

± 0.01% full scale

Digital I/O:

Four I/O onboard (max), primary keys, pseudo functions, batching functions

Communication Ports:

RS-232 full duplex or RS-485 half duplex; USB micro A/B connector 2.0; Ethernet TCP/IP

Status Annunciators:

Gross, net, center of zero, standstill, lb, kg, tare, preset tare, multi-range/interval 1/2/3

Display:

LED, 0.56 in (14 mm), six-digit, 14-segment with decimal or comma

Keys/Buttons:

Membrane panel, tactile feel

Temperature Range:

Certified: 14°F to 104°F (-10°C to 40°C)
Operating: 14°F to 122°F (-10°C to 50°C)

Dimensions (W x H x D):

Panel: 6 in x 4 in x 4.95 in
(152 mm x 102 mm x 126 mm)
Universal: 9.87 in x 9.38 in x 4.33 in
(251 mm x 238 mm x 110 mm)

Weight:

Panel: 2.5 lb (1.2 kg);
Universal: 12 lb (5.4 kg)

Rating/Material:

Display bezel NEMA Type 4X, Type 12, and IP69K
Panel display: stainless steel
Controller box: aluminum
Universal: stainless steel

Warranty:

Two-year limited warranty

EMC Immunity:

EN 50082 Part 2 IEC EN 61000-4-2, 3, 4, 5, 6, 8, and 11

Approvals:

NTEP CC 13-080 Class III/IIIL, 10,000d
Measurement Canada AM-5931C
Class III/IIHD, 10,000d
OIML R76/1992-GB1-04.02 Class III, 10,000d
EU Test Certificate TC8463
UL/cUL Listed (universal)
UL/cUL Recognized (panel mount)
CE Marked

Approvals



Measurement
Canada
Approved



880/880 Plus Performance™ Series

Digital Weight Indicator/Controller

Part Number/Price

Part #	Description	Est. Weight	Price
880 Panel Mount AC Powered*			
177976	115-230VAC	4 lb	\$1,075.00
177979	115-230VAC with analog output	4 lb	\$1,400.00
177980	115-230VAC with relay board	4 lb	\$1,400.00
177982	115-230VAC with EtherNet/IP	4 lb	\$1,650.00
177983	115-230VAC with ProfiNet	4 lb	\$1,650.00
177984	115-230VAC with Modbus/TCP	4 lb	\$1,650.00
177985	115-230VAC with Profibus DP	4 lb	\$1,650.00
177986	115-230VAC with DeviceNet	4 lb	\$1,650.00
179155	115-230VAC with EtherCAT	4 lb	\$1,650.00
880 Panel Mount DC Powered*			
177987	12-24VDC	4 lb	\$1,175.00
880 Plus Universal AC Powered			
177989 †	115VAC	8 lb	\$1,300.00
178496 †	115VAC, with analog output	8 lb	\$1,625.00
178499 †	115VAC, with relay board	8 lb	\$1,625.00
179147 †	115VAC with EtherNet/IP	8 lb	\$1,875.00
179148 †	115VAC with Profinet	8 lb	\$1,875.00
179149 †	115VAC with Modbus/TCP	8 lb	\$1,875.00
179150 †	115VAC with Profibus	8 lb	\$1,875.00
179152 †	115VAC with DeviceNet	8 lb	\$1,875.00
179154 †	115VAC with EtherCAT	8 lb	\$1,875.00
177990 ††	115-230VAC	8 lb	\$1,300.00
178497 ††	115-230VAC with analog output	8 lb	\$1,625.00
178500 ††	115-230VAC, with relay board	8 lb	\$1,625.00
880 Plus Universal DC Powered			
178495	12-24VDC	8 lb	\$1,400.00

*Power cord not included



† US plug (NA) - Type B



†† Euro Plug - Type E

Options/Accessories

Part #	Description	Price
Option Cards (5.5 in CPU only)		
179156	Analog output, 0-10 VDC, 0-20 mA, 4-20 mA	\$325.00
179157	Relay board, four dry contact outputs	\$325.00
197343**	Digital I/O, 24-channel TTL output	\$310.00
197347**	Serial ports, dual-channel RS-232/RS-485	\$360.00
Network Cards		
179158	EtherCAT interface	\$575.00
179159	EtherNet/IP® interface	\$575.00
179160	ProfiNet® interface	\$575.00
179161	Modbus/TCP® interface	\$575.00
179162	DeviceNet® interface	\$575.00
179163	Profibus DP interface	\$575.00
Hardware		
153660	Metrological sealing kit for panel mount	\$10.00
158404	Adapter plate for IQ310 and 520 replacement	\$69.00
101923	Relay box enclosure, does not include relay	\$235.00
177850	Panel mount kit for universal enclosure	\$175.00
180835	Universal backplate with RJ-45 receptacle	\$104.00
197422	Universal backplate with micro USB receptacle	\$125.00
15436	Power cord for panel mount, US plug	\$17.00
105382	Power cord for panel mount, Euro plug	\$17.00
Cables		
152434	Cable, USB A to micro A shielded, 2 meters	\$15.00
156817	Cable, Ethernet RJ45 connectors 1 meter	\$30.00

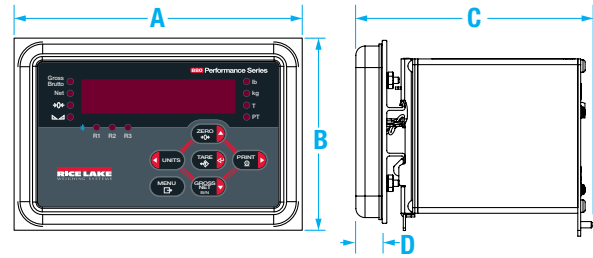

880 Panel Mount Dimensions

A	6.0 in (152 mm)	C	4.95 in (126 mm)
B	4.0 in (102 mm)	D	0.58 in (14 mm) BEZEL DEPTH

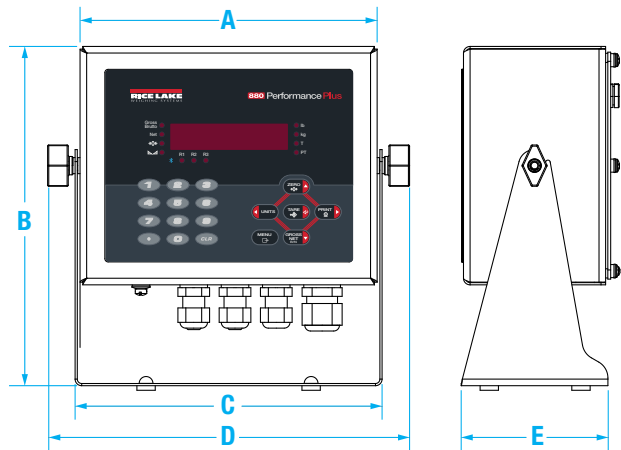

880 Universal Dimensions

A	8.10 in (206 mm)	D	9.87 in (248 mm)
B	9.38 in (235 mm)	E	4.0 in (102 mm)
C	8.37 in (213 mm)		

Options/Accessories

Part #	Description	Price
156806	Cable, USB A to A, 1 meter	\$30.00
156809	Cable, USB A to B, 1 meter	\$50.00
Manuals and Software		
77925	Revolution™ scale software	\$35.00
152240	Operators manual	\$25.00
158387	Technical manual	\$25.00
Primary Component Parts (5.5 in CPU only)		
151674	Display only	\$350.00
177977	115-230VAC, controller only	\$800.00
177988	12-24VDC controller only	\$900.00
131740	Overlay, panel mount, six-key	\$65.00
163986	Overlay, universal with numeric keypad	\$65.00
131598	Display board	\$225.00
175603*	Power supply, 100-240VAC	\$200.00
175604*	Power supply, 12-24VDC	\$300.00
175109*	CPU board	\$550.00

* Design change in 2017 to 5.5 in wide controller, see replacement parts catalog for the 5.0 inch wide boards.

** Requires version 4.0 firmware

To have your option factory installed, please specify when placing your order.