

With its heavy-duty cast-iron construction, ability to dry-prime and re-prime automatically, this end-suction centrifugal pump leads the industry in construction, industrial and mining applications. The Thompson 8JSCE-DJDST-45H-MC ENVIROPRIME® Solids Handling Pump is designed for high flows and heads to 300 feet making it perfect for sewage bypass pumping or general construction dewatering. The 8JSCE-DJDST-45H-MC pump provides flow rates to 3,200 gpm and solids handling to 3".

ENVIROPRIME SYSTEM® with Compressor

- Thompson’s innovative priming system preventing blow-by of sewage, effluent and waste from discharging onto the ground. This system, with Thompson’s compressor priming system, offers mid-range air handling capabilities for quick priming.



Consult factory for other versions & options including site trailers, sound attenuation, etc.

Pump End Materials

Pump Casing	Heavy-duty class 30 cast-iron
Impeller	Dynamically balanced, non-clogging, enclosed, 65-45-12 ductile iron with rear-equalizing vanes to reduce axial loading and prolong seal and bearing life; Diameter 14"
Mechanical Seal	2.5" dry-running, grease or oil lubricated with Tungsten Carbide rotating and Silicon Carbide stationary seal faces. Other components are 304 stainless steel and viton.
Head	Rugged, back pull out design, heavy-duty class 30 cast iron with tapered bore design.
Bearing & Frame	Heavy-duty grease lubricated to carry both axial and radial loads. Frame, heavy-duty class 30 cast iron
Shaft	'Stress-proof' steel and fitted with a renewable 416 stainless steel shaft sleeve

TECHNICAL SPECIFICATIONS

Suction Size	8" (20.32 cm)	Approximate Dry Weight	6,530 lbs (2,962 kg)
Discharge Size	6" (15.24 cm)	Fuel Tank	114 Gal (431.54 L)
Maximum Flow Capacity	3,200 gpm (726.4 m³/h)	Fuel Consumption @ 1,800 rpm	7.1 GPH (26.88 L/h)
Maximum Head	300 ft (91.44 m)	Best Efficiency Point	83%
Maximum Solids Handling	3" (7.62 cm)	Maximum Operating Times	Fuel Economy
Maximum Operating Speed	2,000 rpm	16 hours @ 2,000 rpm	0.350 lb/hp-hr@2,000 rpm
Maximum Operating Temp.	200°F (93.33°C)	21 hours @ 1,800 rpm	0.351 lb/hp-hr@1,800 rpm
Maximum Operating Pressure	130 psi (895 kPa)	27 hours @ 1,600 rpm	0.360 lb/hp-hr@1,600 rpm

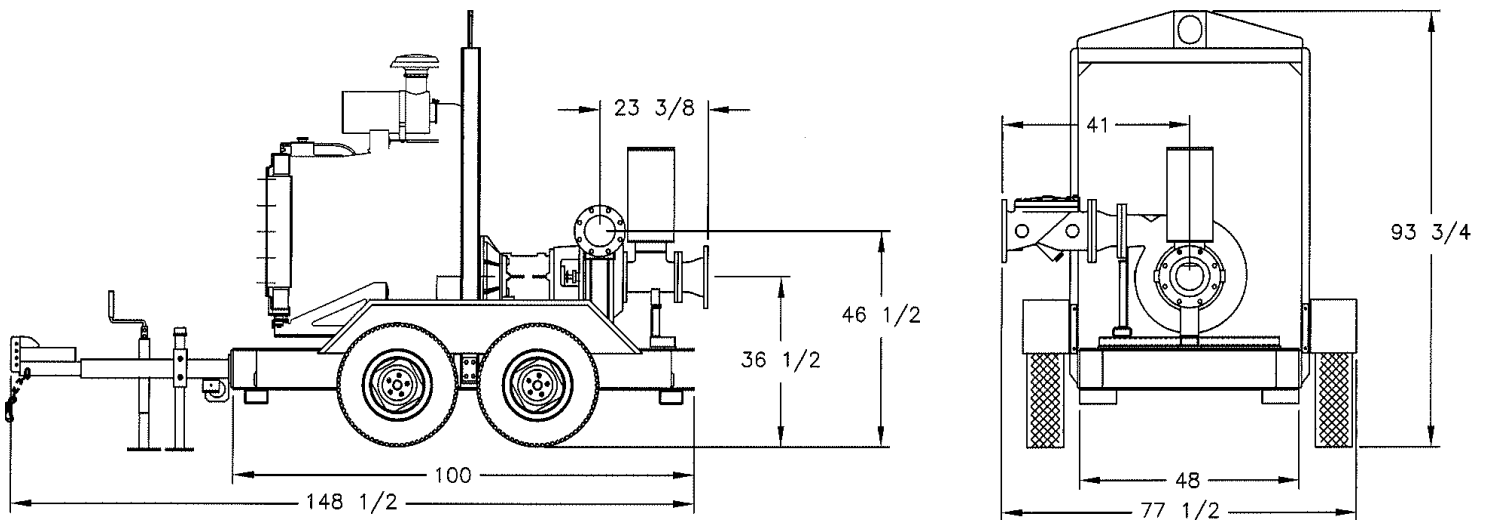
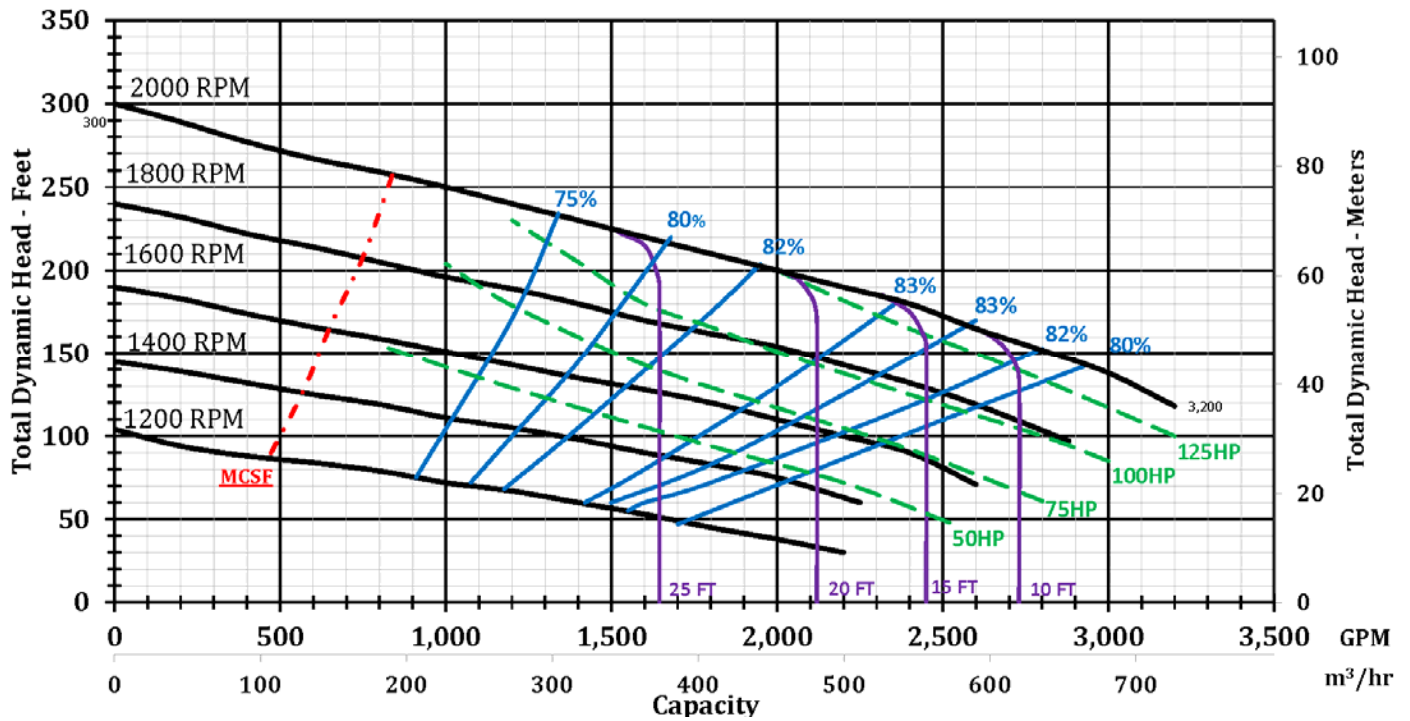

Engine Specification

Engine Model	John Deere 4045H, 149 hp @ 2,000 rpm	Standard Equipment	Alternator, radiator, muffler, and residential grade silencer muffler
Type	4-cylinder, in-line, 4-cycle, water-cooled, turbo-charged, direct-injected, Tier III diesel	Automatic Shut-downs	Low lube oil pressure; high water temperature

Specifications and illustrations are subject to revision without notice and without incurring any obligation for previous or subsequent equipment sold. Thompson Pump (ISO 9001:2008) makes no representation regarding the completeness or accuracy of this information and is not liable for any direct or indirect damages arising from or relating to this information or its use. Capacity & Head are shown for comparative purposes. Consult Thompson factory for exact capabilities.