



Global Environmental Products Inc. offers equipment with uncompromising performance, consistent quality, durability and reliability. Our comprehensive range of machines provide the right cleaning equipment for your application. Please contact us for a demonstration at (909) 713-1600.

- ▶ Reliable / Durable Equipment
- ▶ Innovative Engineering / Design
- ▶ Industry Leading Reputation
- ▶ Dedicated Customer Service
- ▶ Outstanding Sales Professionals
- ▶ Fast Parts and Service
- ▶ National Dealer Network

www.GlobalSweeper.com

MADE IN THE USA



Sold and Serviced by:



ISO
9001:2015
CERTIFIED

Global Environmental Products
5405 Industrial Parkway
San Bernardino, CA 92407 USA
909-713-1600
info@globalsweeper.com



Purpose-Built, Maneuverable, Powerful, Quiet and Simple

© Copyright 2022, Global Environmental Products, Inc. • Specifications may change without notice. • V-031622



AIR
GLOBAL



**100% PLUG-IN ELECTRIC HEAVY-DUTY
REGENERATIVE AIR STREET SWEEPER**

GLOBAL R4AIR EV

*Introducing the First Heavy-Duty Class 7
Plug-In 100% Electric Drive Rechargeable Regenerative Air Sweeper
Purpose-Built, Maneuverable, Powerful, Quiet and Simple*

- ▶ 18.6' Turning Radius
- ▶ Cab-Over Design with Unmatched Visibility
- ▶ Large 47" Gutterbrooms Designed to Clean the Curb
- ▶ Large 32" Diameter Impeller
- ▶ Unmatched Access to Sweeping Components
- ▶ Large 5.8 Cubic Yard Hopper with Access Door
- ▶ 100% Stainless Steel Hopper Construction
- ▶ **ZERO EMISSIONS and 8 Hours of Operational Time**

ZERO EMISSIONS FOR A GREENER TOMORROW



100% PLUG-IN ELECTRIC CLASS 7 REGENERATIVE AIR SWEEPER WITH ZERO EMISSIONS

THE ULTIMATE PERFORMANCE AND AGILITY ZERO EMISSIONS

From the modern, comfortable and well appointed operator's cab, to the toughest and most rugged Regenerative-Air Type sweeping system ever built, the **Global R4AIR EV** is designed to take on the worst of the worst sweeping conditions.

The performance matched **32" Suction Fan and 72" Wide Pick-Up Head** provide superior sweeping of all heavy debris quickly and efficiently. The purpose-built chassis is based on four decades of experience designing the most effective, and safe, street sweepers in the industry

The 130-inch wheelbase allows for the sweeper to reach a **turning radius of 18 1/2', wall-to-wall**. With the pickup Head in the center you don't have to worry about what is happening behind you. **Global R4AIR EV is the only 4-Wheel Air Type Street Sweeper in the market that can be utilized virtually anywhere with the ability to HIGH-DUMP into a dump truck.**

Global R4AIR EV Standard Equipment

- Air Conditioned and Pressurized Cab
- In-Cab Gutterbroom Pressure Adjustment
- Front and Rear Chalmers Suspension
- Rear View Camera and LCD Monitor
- 72" Wide Pick-Up Hood, 32" Impeller
- LED Headlights
- Hopper Access Door
- 100% Stainless Steel Hopper Construction

Global R4AIR EV Options

- In-Cab Gutterbroom Tilt
- In-Cab Gutterbroom Speed Control
- AM/FM/CD Stereo with AUX/USB Port and BlueTooth
- Air-Ride Seat
- Hopper Wash Out System
- Suction Hood Wash Out System
- Curtain Lift Arm Leaf
- Automatic Greasing System
- PM-10 Water System (Meets South Coast AQMD Rule 1186)



THE BEST TURNING RADIUS & EXCEPTIONAL VISIBILITY With the center mounted cab/forward layout the operator has unsurpassed visibility of the road surface as well as pedestrians and surrounding traffic. The 130-inch wheelbase allows for the sweeper to reach a **turning radius of 18 1/2', wall-to-wall**. With the pickup Head in the center you don't have to worry about what is happening behind you. The **Global R4AIR EV's** exceptional visibility increases operator and pedestrian safety.

THE ULTIMATE SWEEPING SYSTEM

The Sweeping system consists of **72" Wide Pick-Up Hood with Carbide Dirt Shoes**, combining both with a **Large 32" Suction fan** equals to one of the most powerful AIR Street Sweepers available today.



POWERFUL GUTTERBROOMS

Large 47" Digger-Type Gutterbrooms allow for superb cleaning of curbs and help guide the debris to the 72" wide Pick Up Hood. Combined with a Large 32" Suction fan equals one of the most powerful AIR Street Sweepers available today.

DUST SUPPRESSION SYSTEM

Global R4AIR EV includes **250-Gallon Water Tank Capacity** combined with **Two(2) Diaphragm Water pumps** and **Two(2) Modes (LOW/HIGH)** provide versatility and superb dust control.



LARGEST HOPPER IN IT'S CLASS

Global R4AIR EV includes a **5.8 cu/yd 100% Stainless Steel hopper construction**, **Cyclone Type Dust Separators** and **Swing-Down Hopper Screens** are easy to clean.

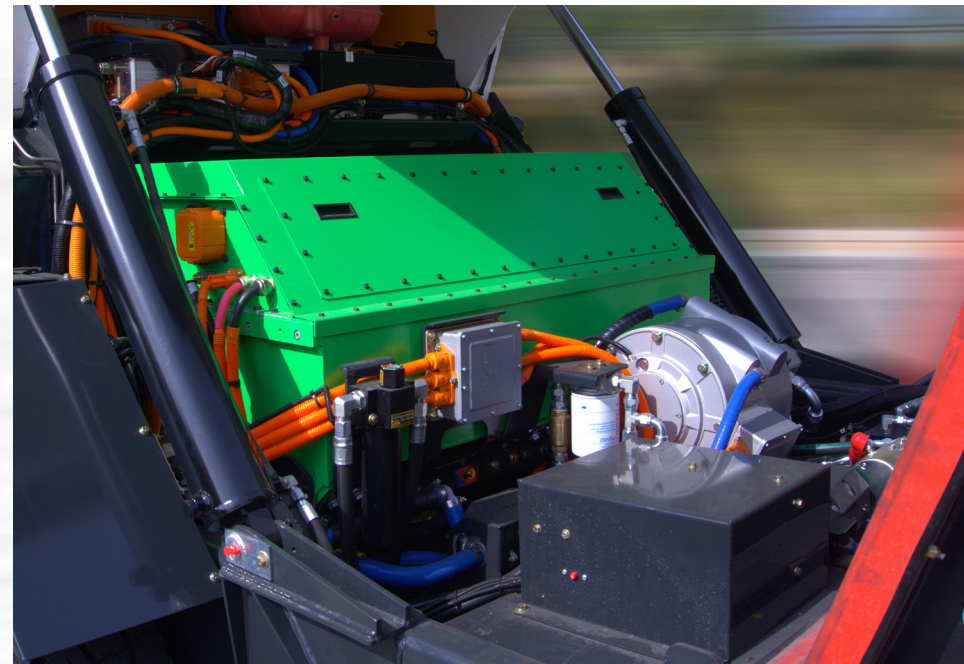

ALL ELECTRIC DRIVE SYSTEM

- **Large Batteries will last for up to 11 hours of operation. With a 10 Year Life Span, the Batteries are designed to last and will not have to be replaced.**
- **Standard SAE J1772 Level II 240V Charging System will replenish the battery in 8 hours.**
- **J1772 SAE Level III Supercharging System is available as an option, recharging time of 4 hours.**

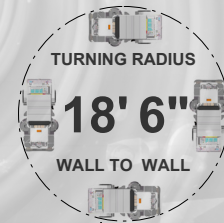
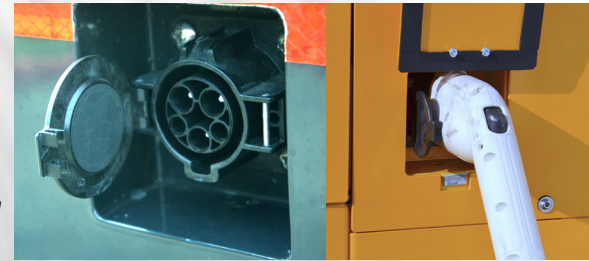

The **Global R4AIR EV** offers the best maneuverability in its class with its tight turning radius that allows the operator to maneuver easily in cul-de-sacs and close quarters.

Designed to Prevent Sand-Blasting
Designed for Durability, Easy Access,
and Long Service Life.

Hydraulically-Driven Fan sealed loop Air is blasted down a 12" vertical tube (Pressure Side) on the left side of the Pick-Up Hood. Debris and Air then travels to the right and Up 12" Hose (vacuum side), Enter Dust Separator, which filters fine particles from Air Stream before it reaches the blower again. Water system keeps the debris from returning to the impeller.

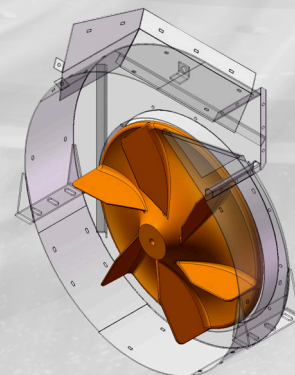

THE ULTIMATE AIR SWEEPING SYSTEM

Large 32" Diameter Impeller includes wear-resistant coating. The **Internal Impeller Housing** components include **Rubber Lining**. Driven **Hydraulically**, Impeller will reach speed of **3,000 RPM** independent of Sweeping Speed.



ZERO EMISSIONS FOR A GREENER TOMORROW

- ▶ **Very Quiet Sweeping Operation**
- ▶ **Up to 8-Hours of Continuous Sweeping Time with 210KW Lithium Ion Battery Pack**
- ▶ **240V Charging System Standard**
- ▶ **Top Travel Speed Of 55-MPH**
- ▶ **All Electric Propulsion System Eliminates Transmissions And Reduces Maintenance**
- ▶ **No Diesel Engine And No DPF System Allows For Lower Total Cost Of Operation**
- ▶ **The Only Heavy-Duty Plug-In Electric Street Sweeper In The USA!**

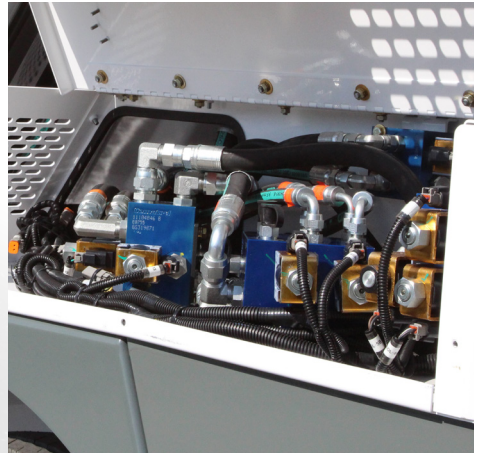

IT'S ALL IN THE OPEN Hydraulic Hoses are NOT hidden in the frame of the sweeper, while all Manifolds and Filters are located in a central location.

EASY TROUBLESHOOTING

A centralized, weatherproof systems locker fully protects electrical components from the elements while it allows maintenance staff easy accessibility for inspection and troubleshooting.

